

# DIR<sup>®</sup>

# Maximus II

7113-2G

INSTRUCTION MANUAL

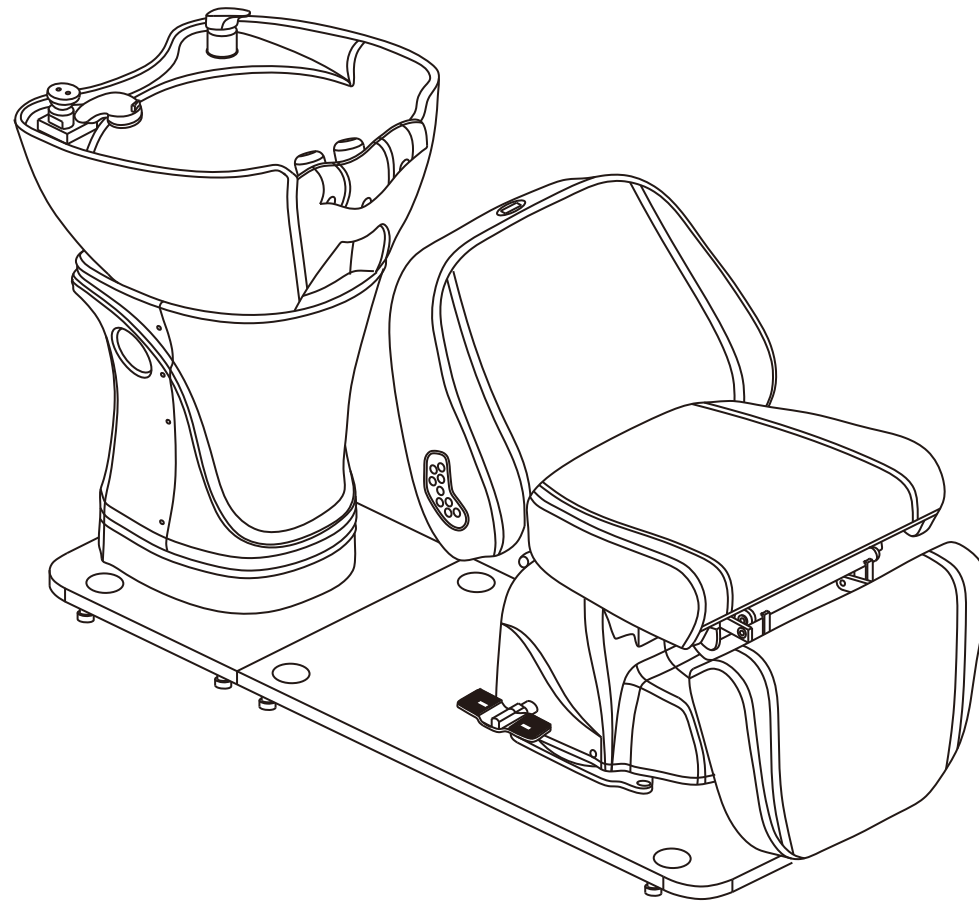

# List of Parts & Tools

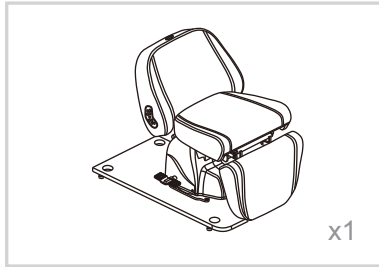

Massage Shampoo Chair

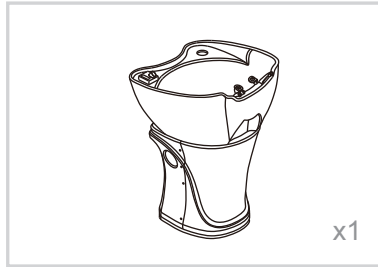

Shampoo Bowl Pedestal

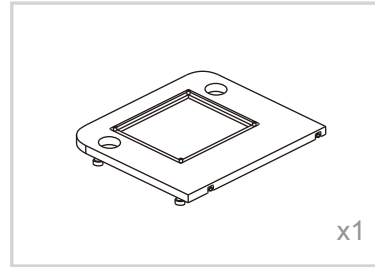

Pedestal Platform

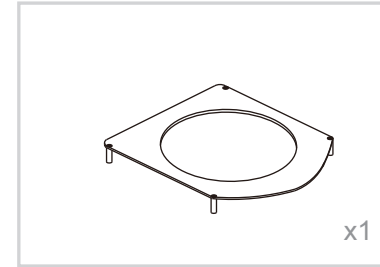

Pedestal Joint Support

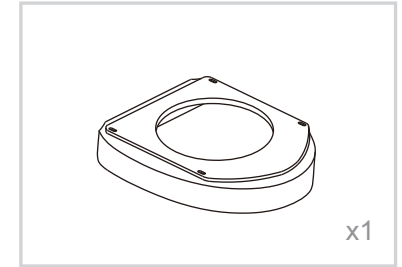

Pedestal Cover

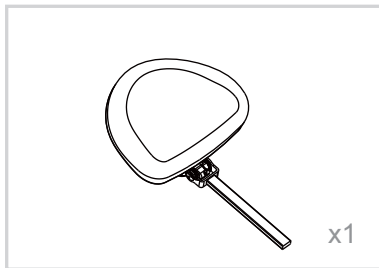

Headrest A

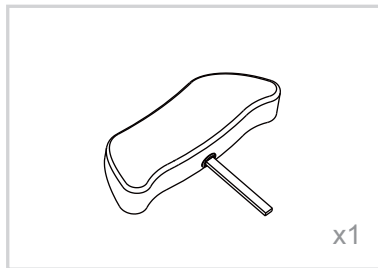

Headrest B

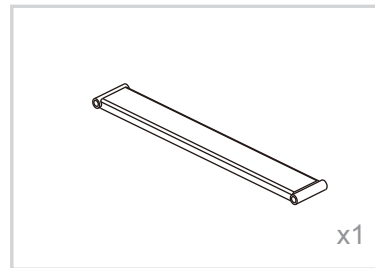

Backrest Support Strut

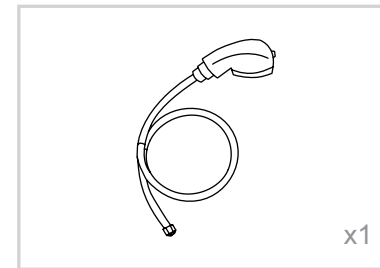

Shampoo Sprayer

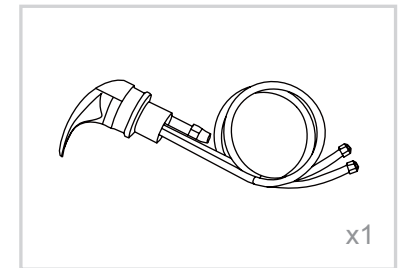

Faucet Kit

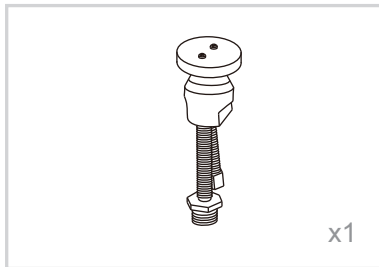

Vacuum Breaker

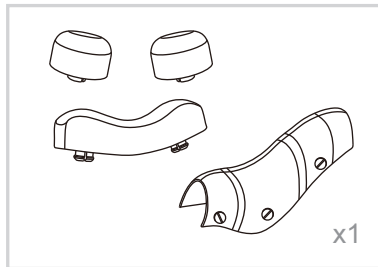

Silicon Neckrest

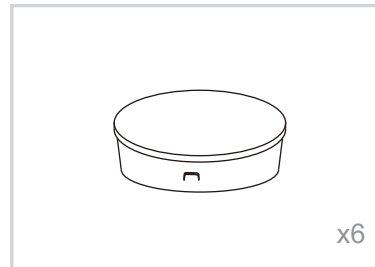

Decorative End Cap

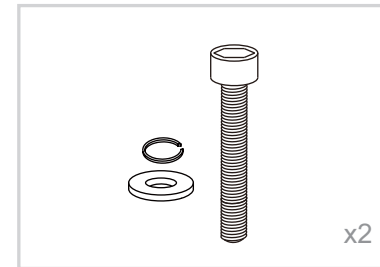

M8 Allen Bolt

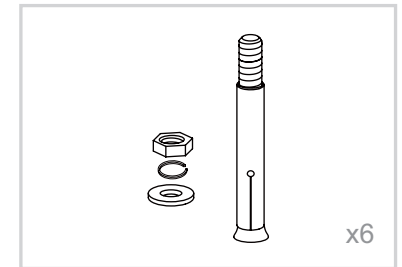

Expansion Bolts

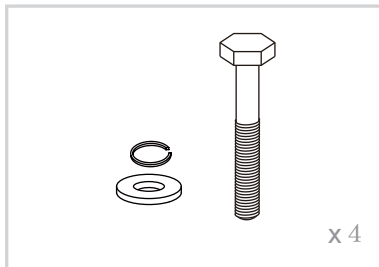

M8 Hex Bolt

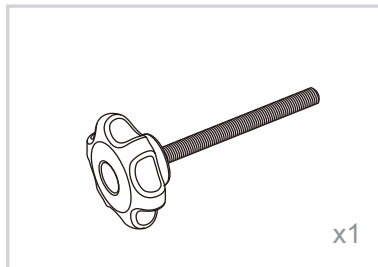

Headrest Locking Knob

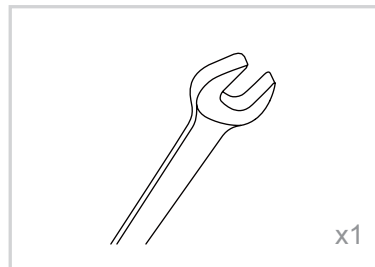

Wrench

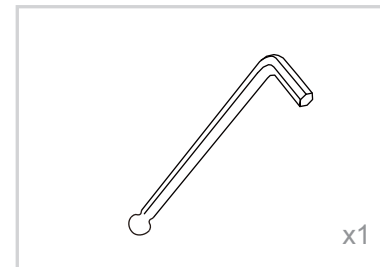

6 mm Allen Key

● Technical Data

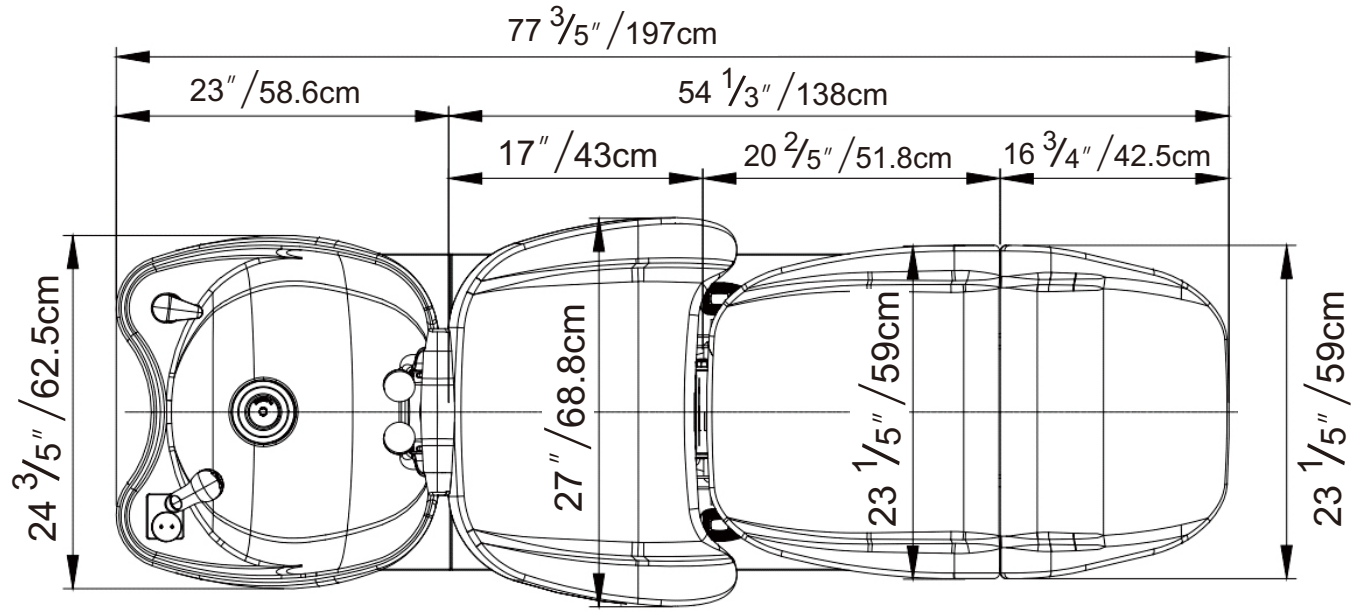
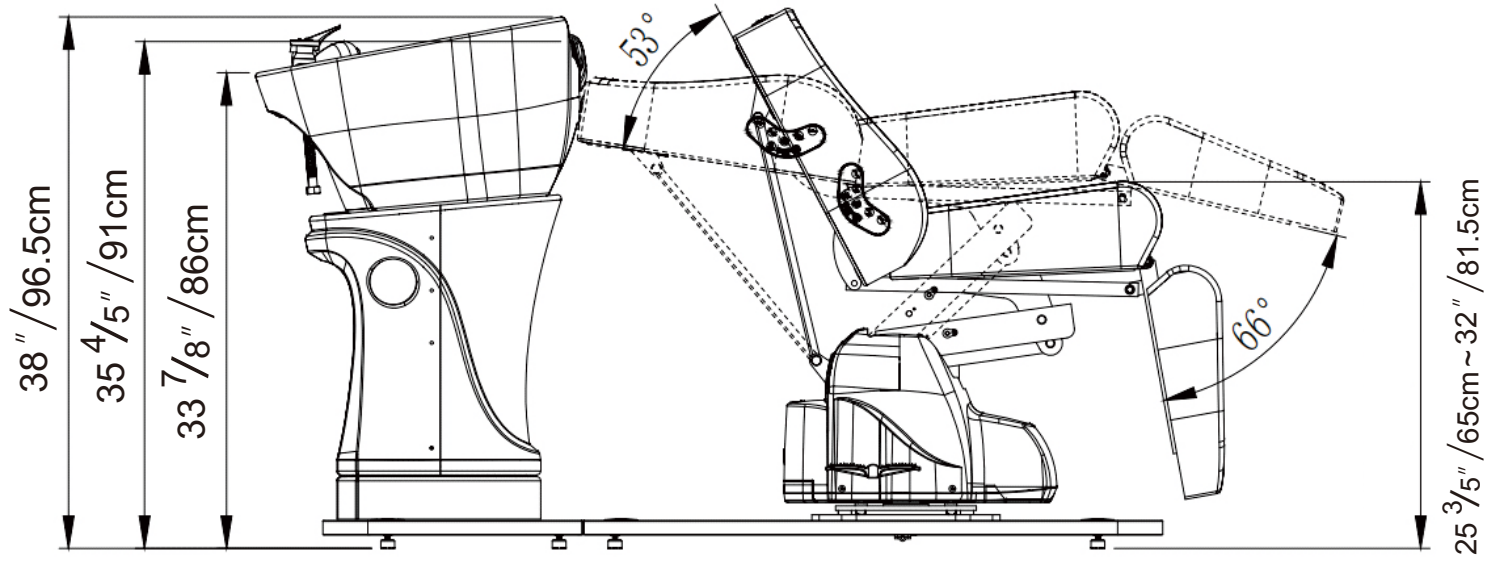

## ● Technical Data

	UK	USA
Dimension	197×68.8×96.5cm	77 <sup>3</sup> / <sub>5</sub> " × 27" × 38"
Maximum Load	200kg	440lb
Net weight	90.5kg	200lb
Adjustable Range of Height	65~81.5cm	25 <sup>3</sup> / <sub>5</sub> " ~ 32"
Padding	High Density Foam	High Density Foam
Leather	PU/PVC	PU/PVC
Input Voltage	AC 220~240V	AC 100~120V

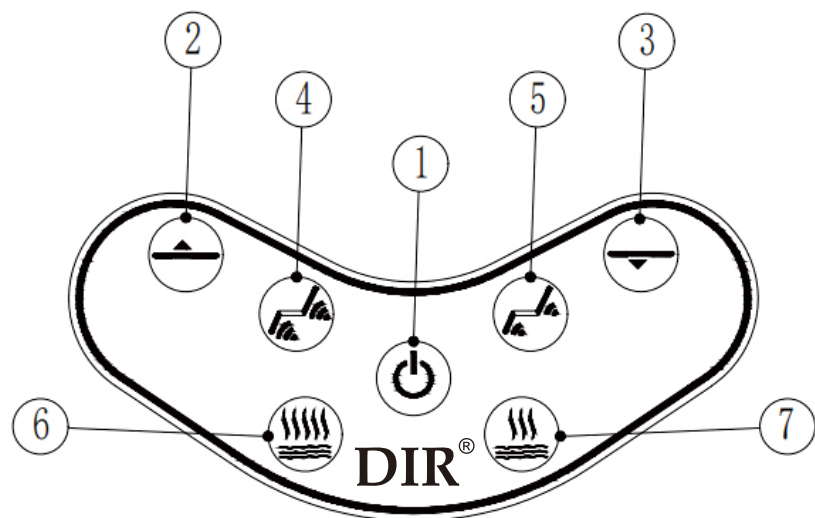

## ● Remote Control Operations:

- ① ON/OFF Switch
- ② Seat Raise-Backrest will recline and Leg-rest will raise
- ③ Seat Lower-Backrest will arise and Leg-rest will lower
- ④ High Intensity Vibrating Massage ON/OFF
- ⑤ Low Intensity Vibrating Massage ON/OFF
- ⑥ High Thermal Heat Setting ON/OFF
- ⑦ Low Thermal Heat Setting ON/OFF

# ● Backrest to Seat Installation

Align Backrest Brackets to Seat Frame and secure in position with provided Flat and Cotter Pins.

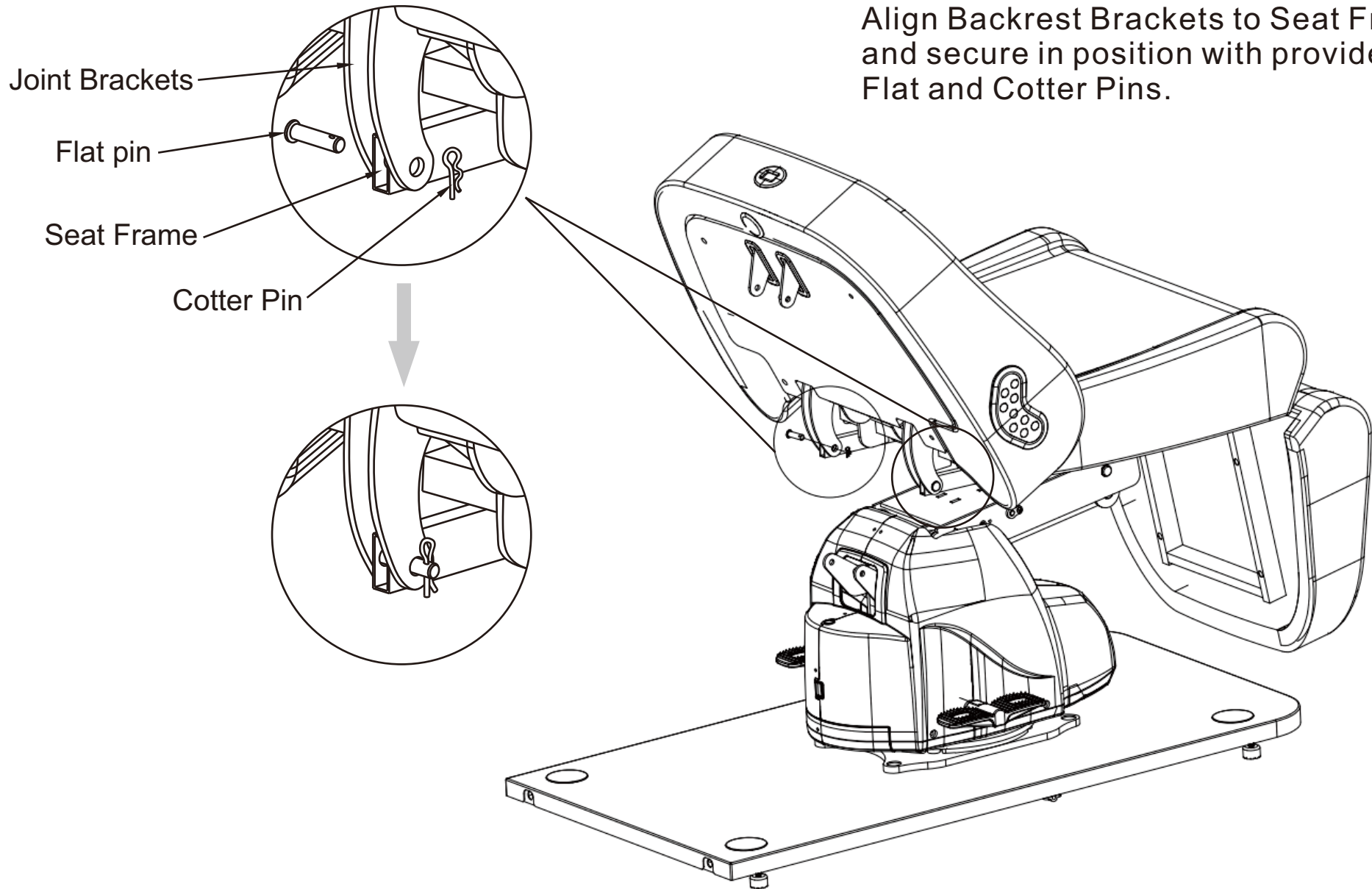

# ● Backrest Strut Installation

Align Backrest Strut with brackets on backrest and base, insert Hex Threaded Rod and lock in position with nuts & washers.

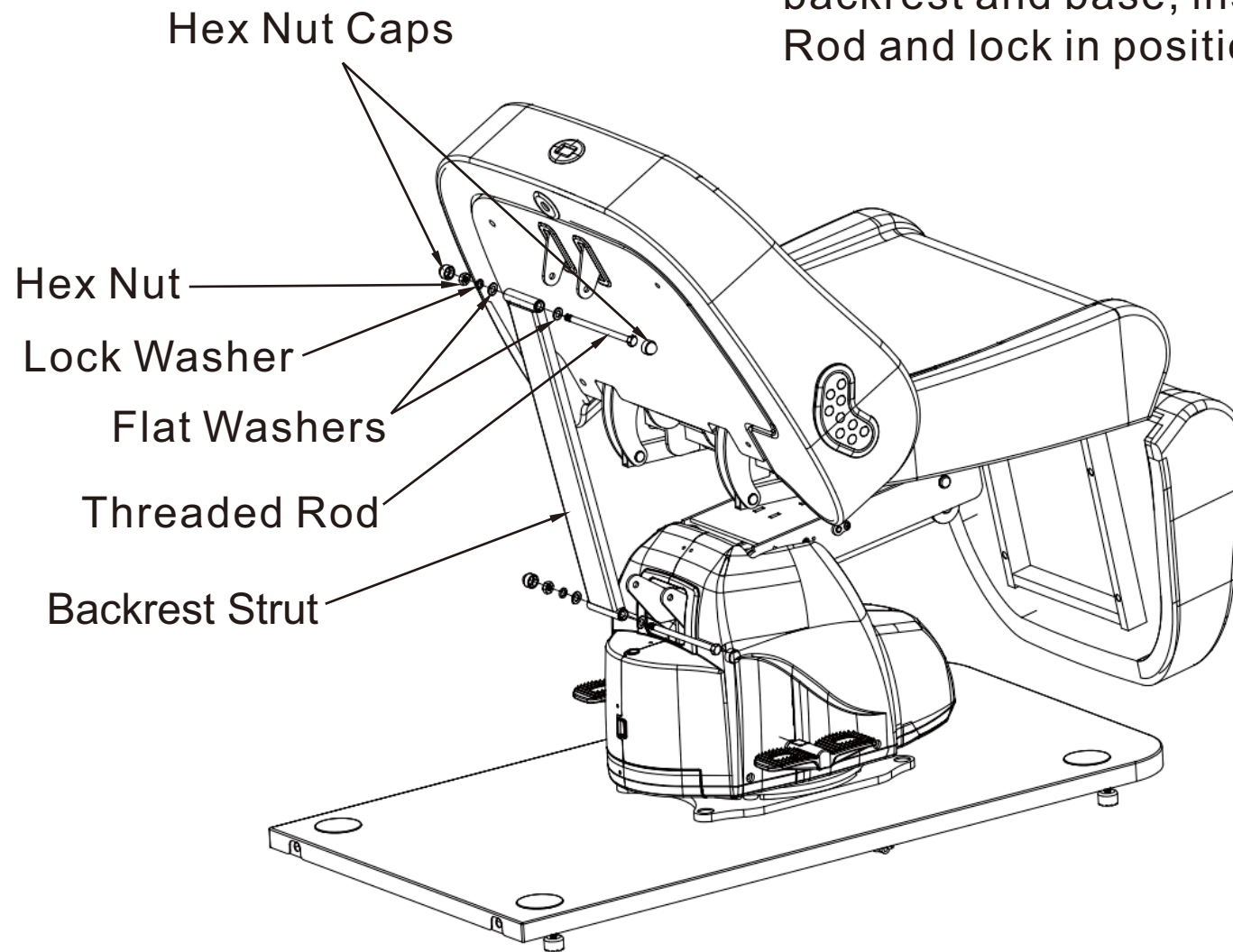

# ● Base Platform Connection

Align Base Platforms and lock in position with provided Allen Screw and Washers.

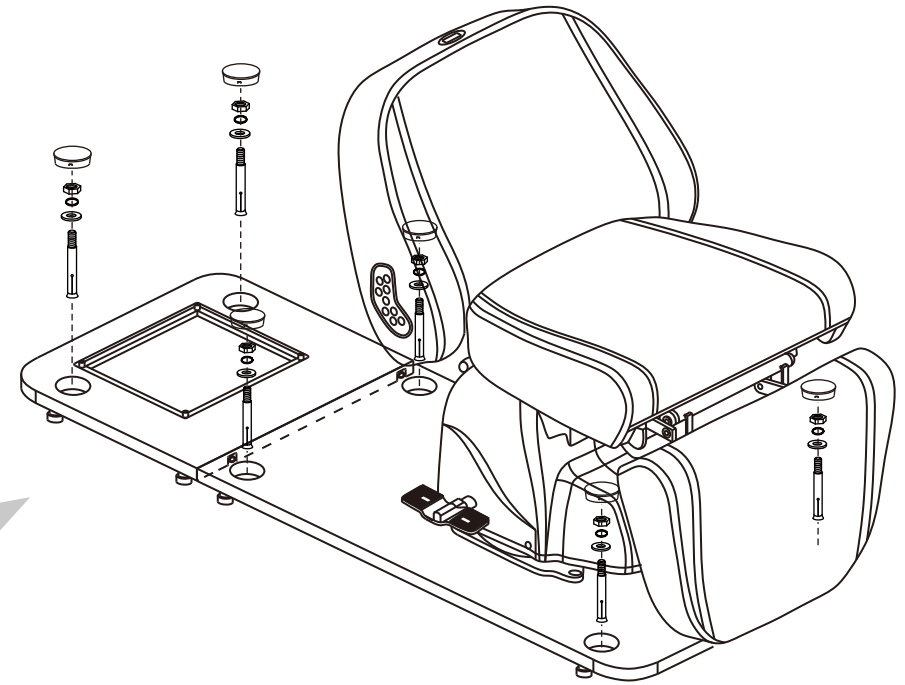
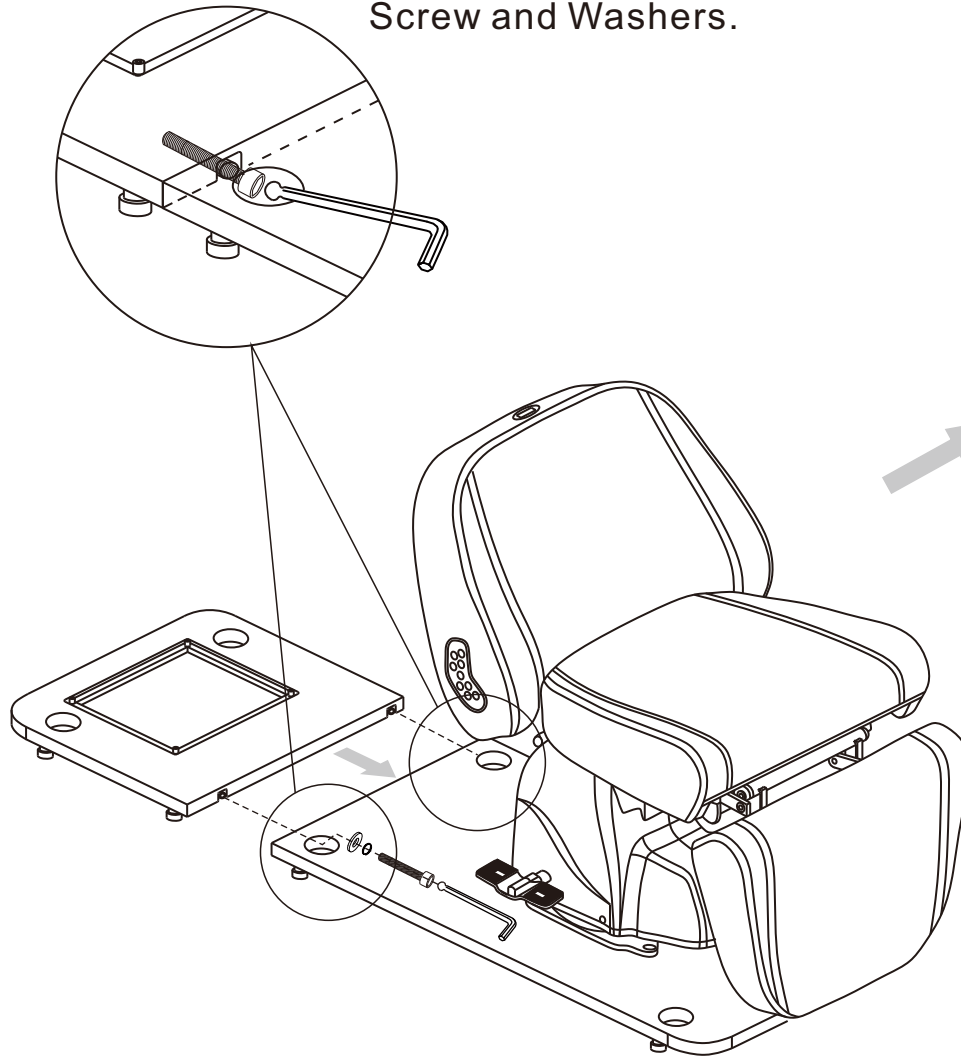

## **Recommended:**

DIR recommends all owners to bolt the Shampoo Unit to the ground with provided expansive bolts.

# ● Silicon Neckrest Installation

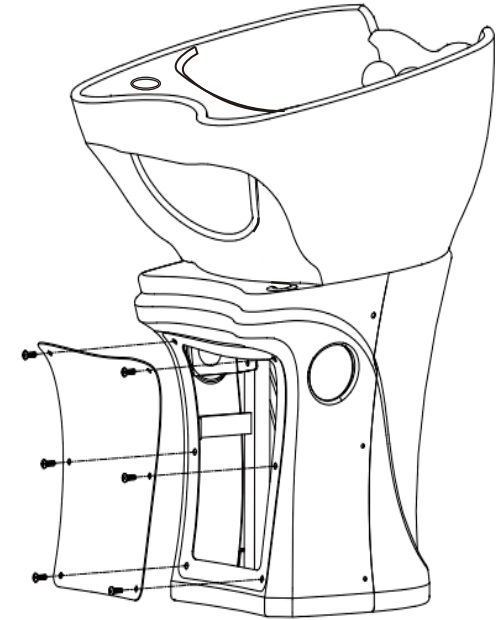
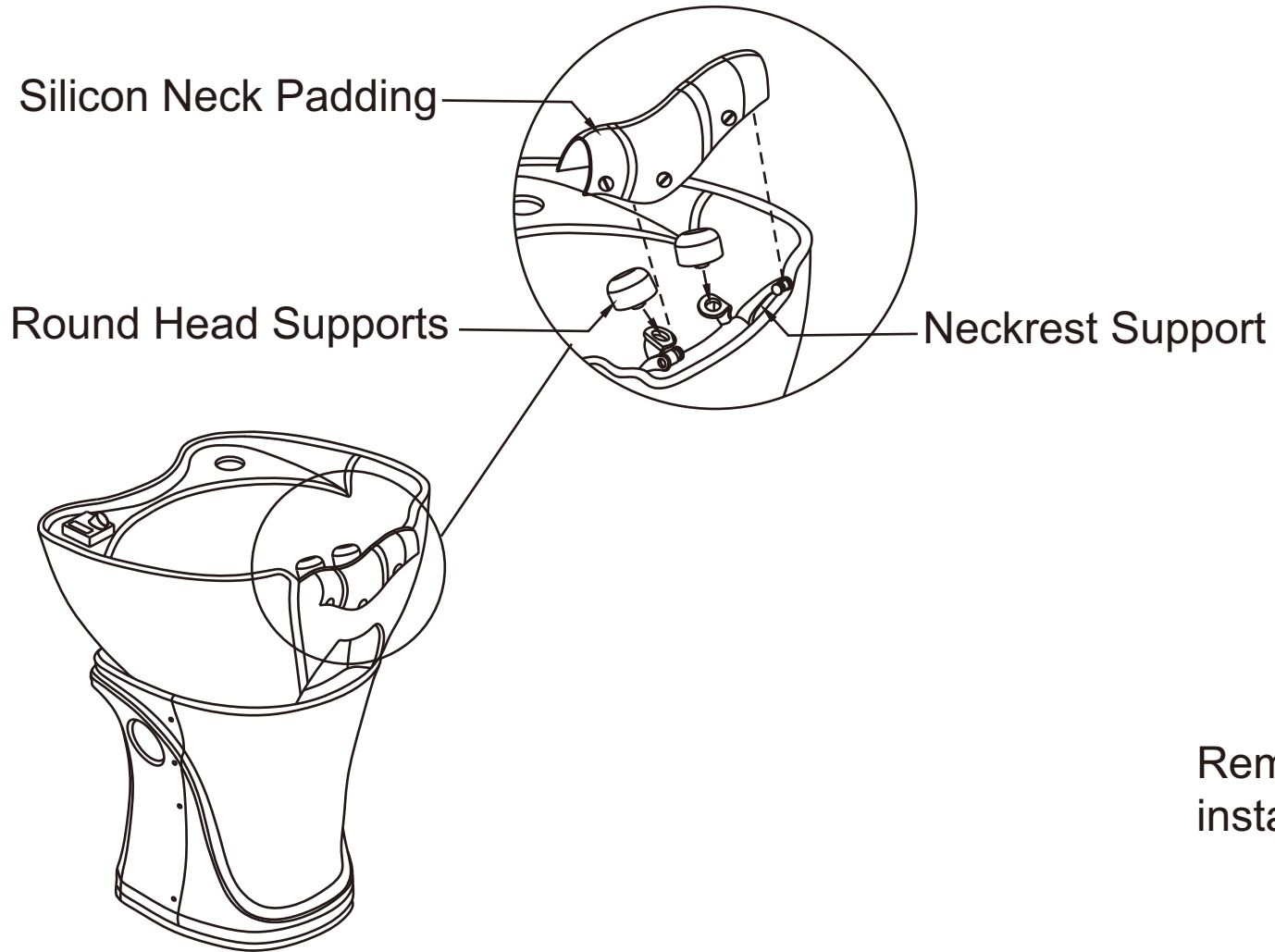

Remove access panel for next installation steps.

# ● Shampoo Bowl Pedestal Installation

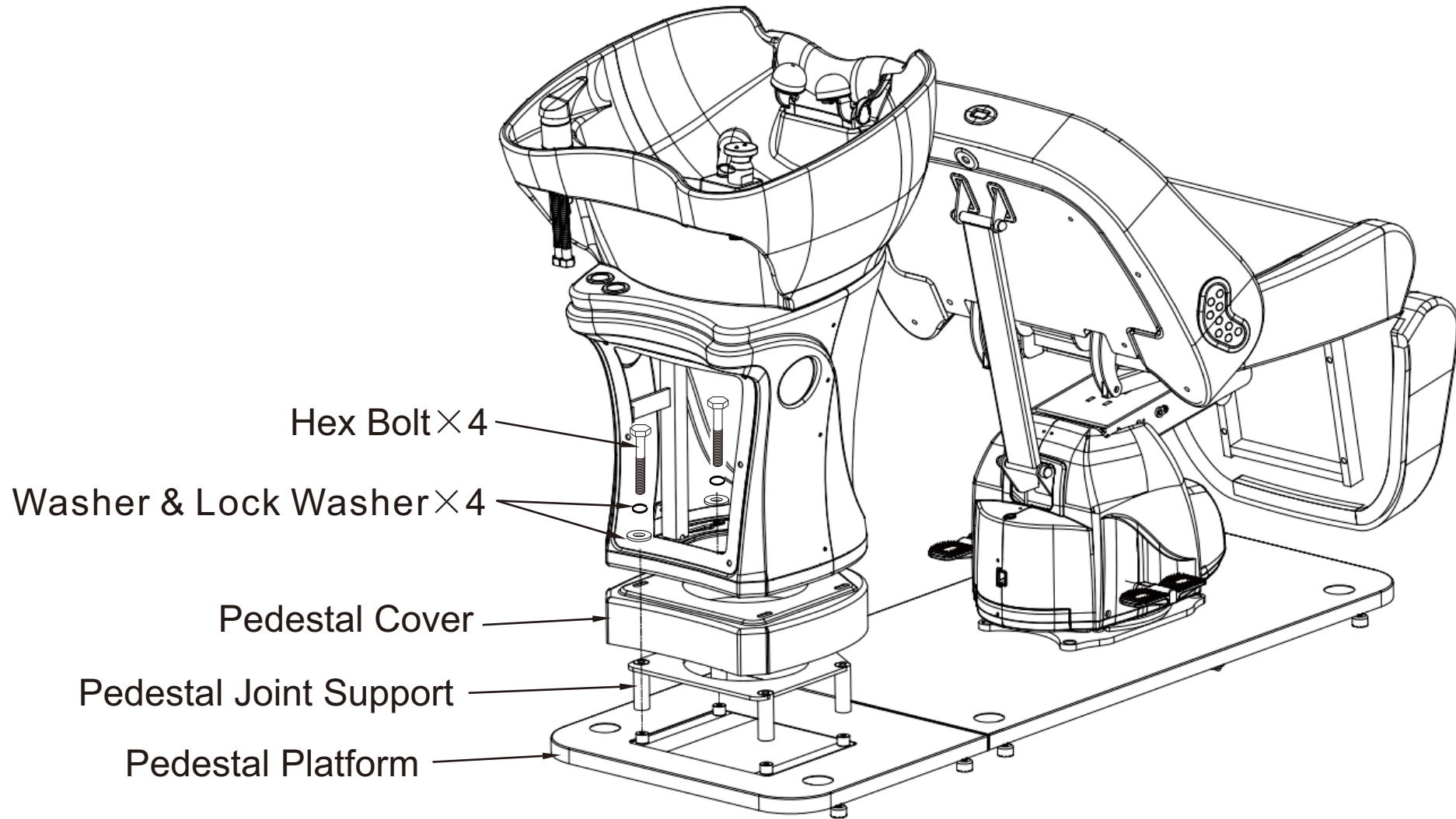

# ● Plumbing Specifications

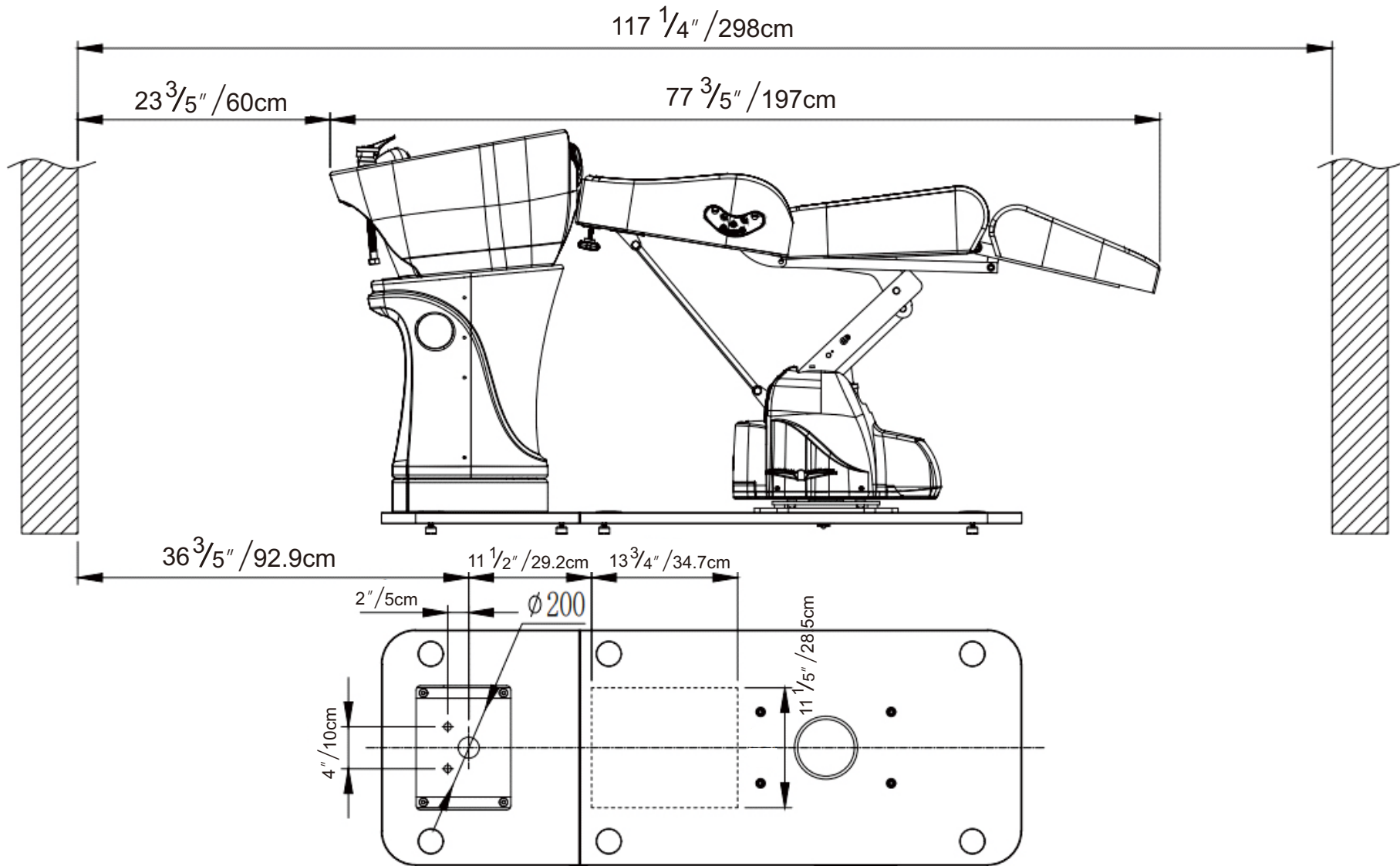

- Faucet installation

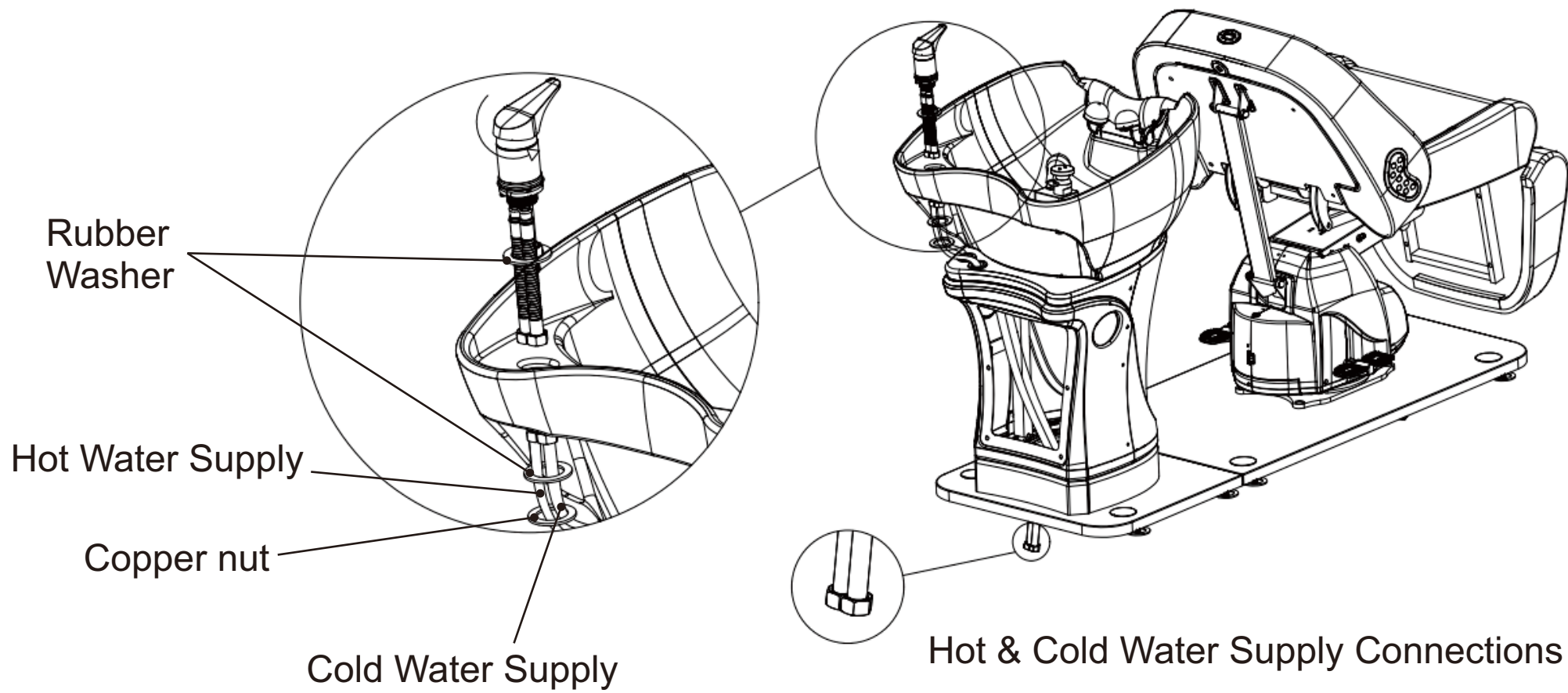

# ● Sprayer and Vacuum Breaker Installation

Vacuum Breaker Valve

H Mounting Bracket

Screw

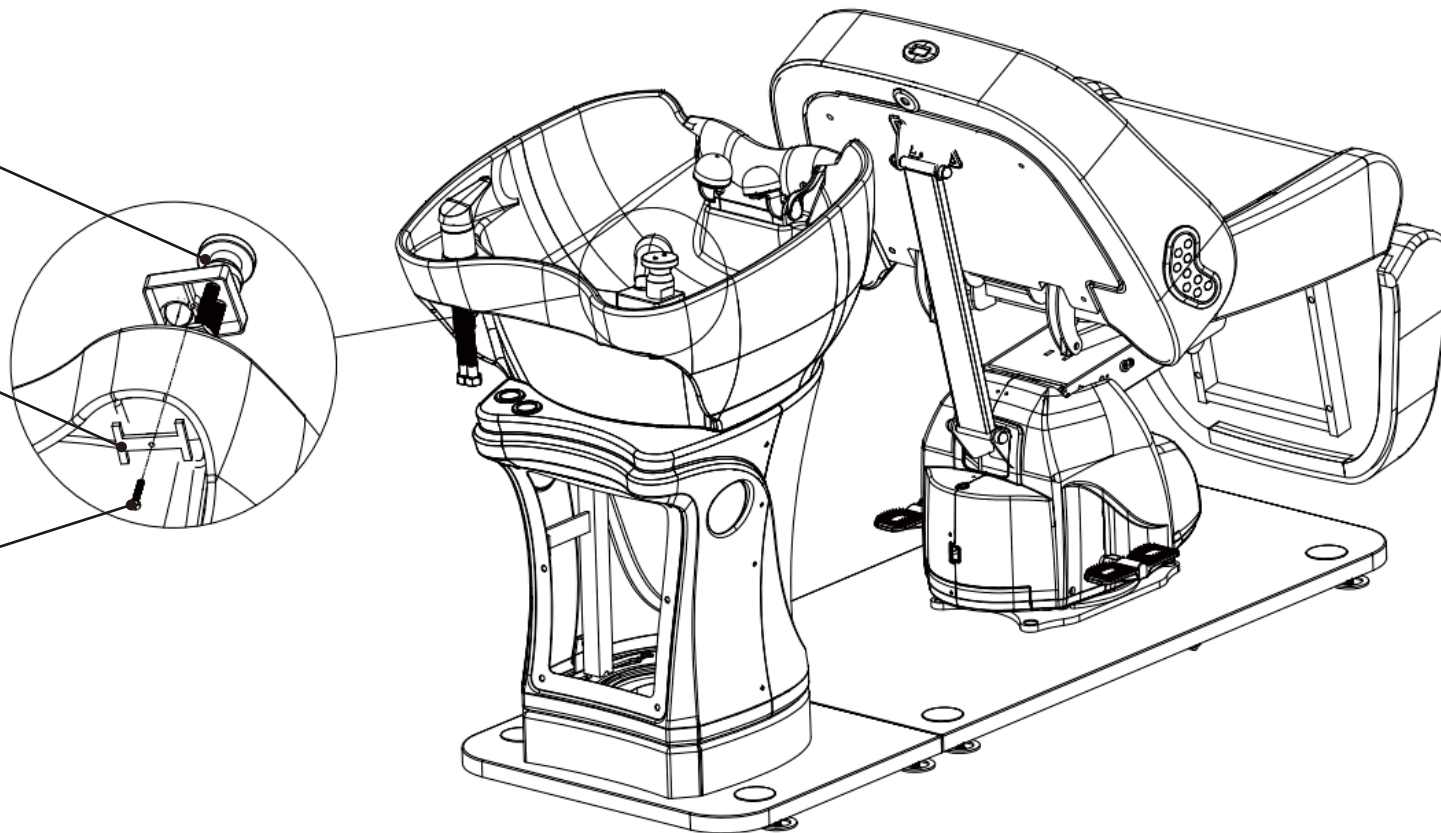

# ● Sprayer and Vacuum Breaker Installation

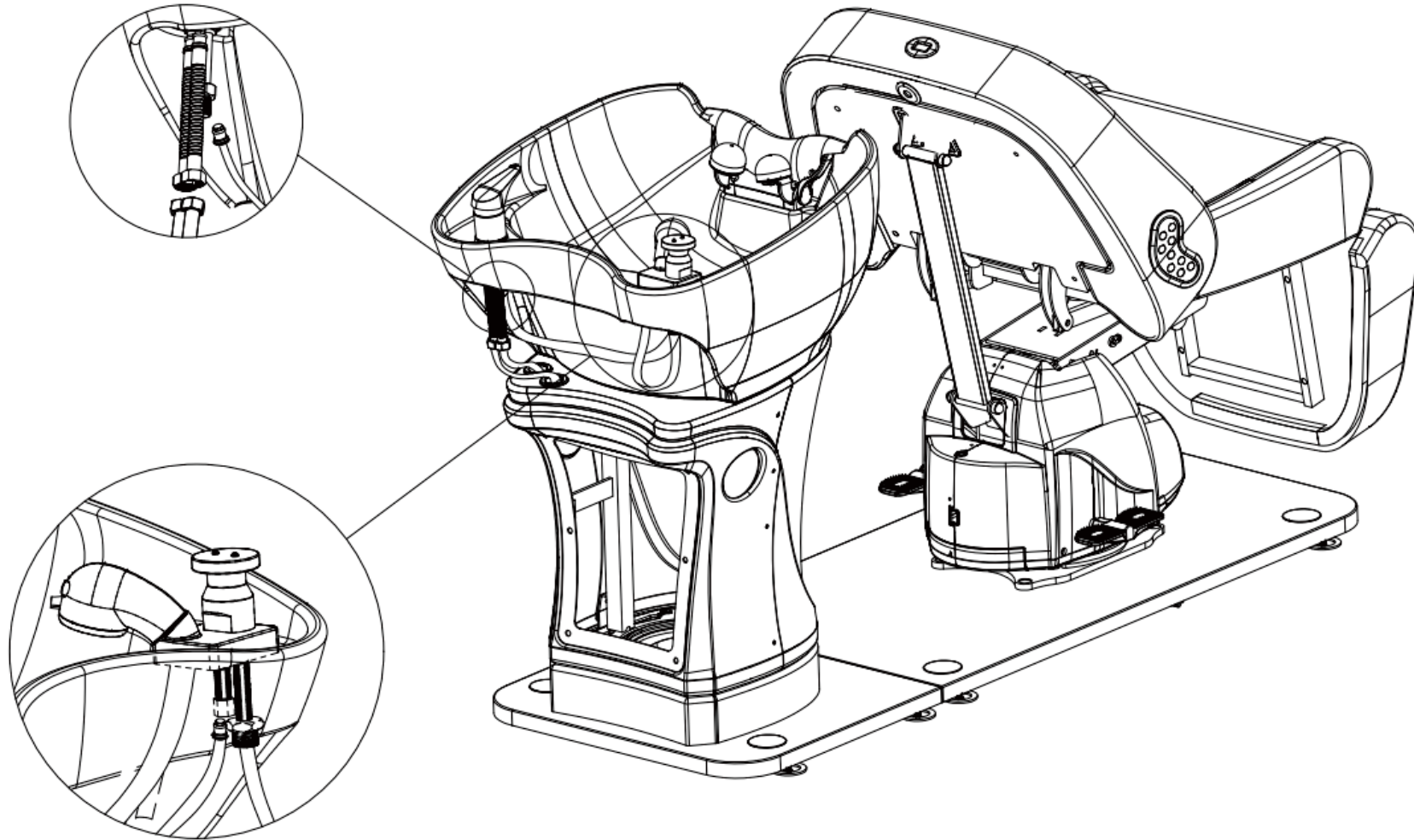

\*Vacuum Breaker hose will connect to Faucet

\*Sprayer hose will connect to outlet on Vacuum Breaker

● **Drain Hose Installation**

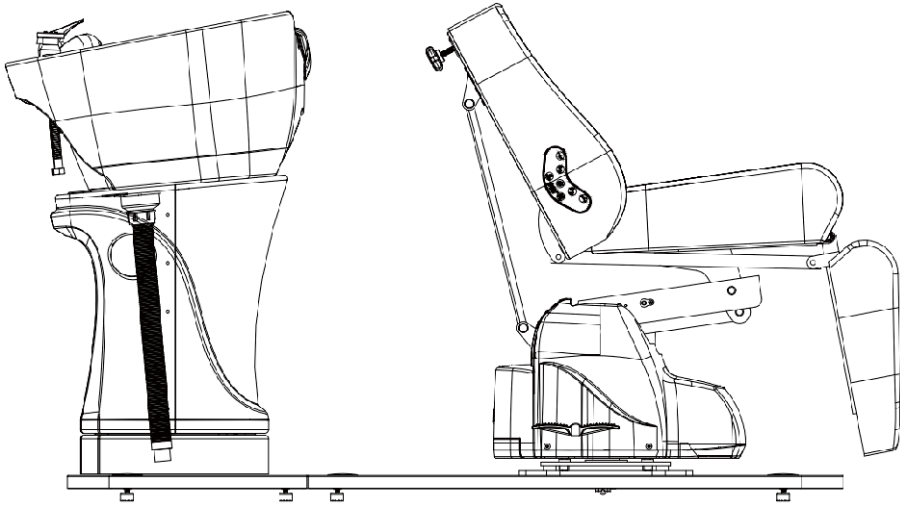

● **Swivel Function**

90 Degrees to both left and right

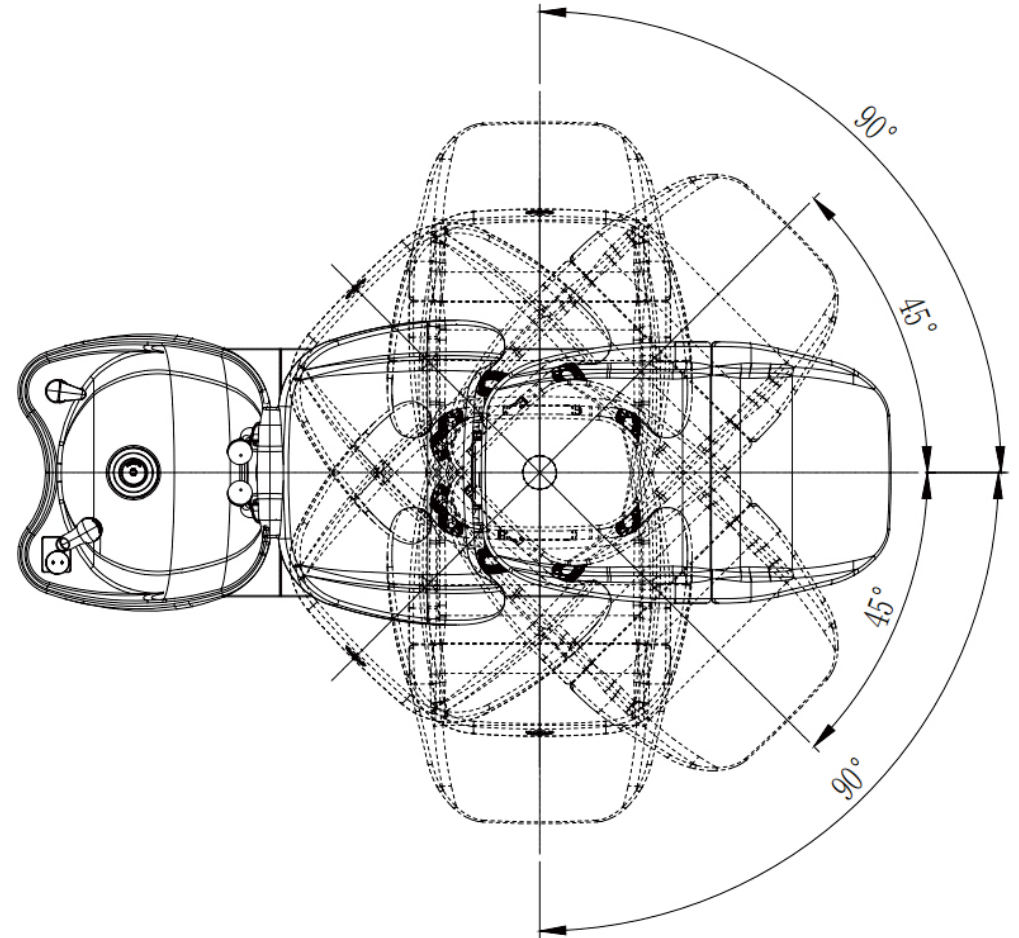

● **Power, Fuse and Foot Control**

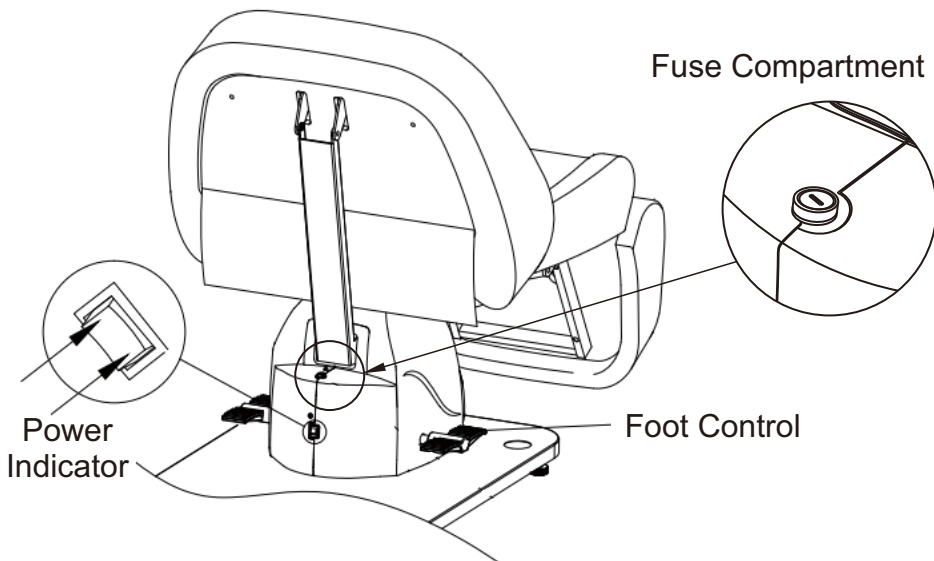

- Headrest Options A & B

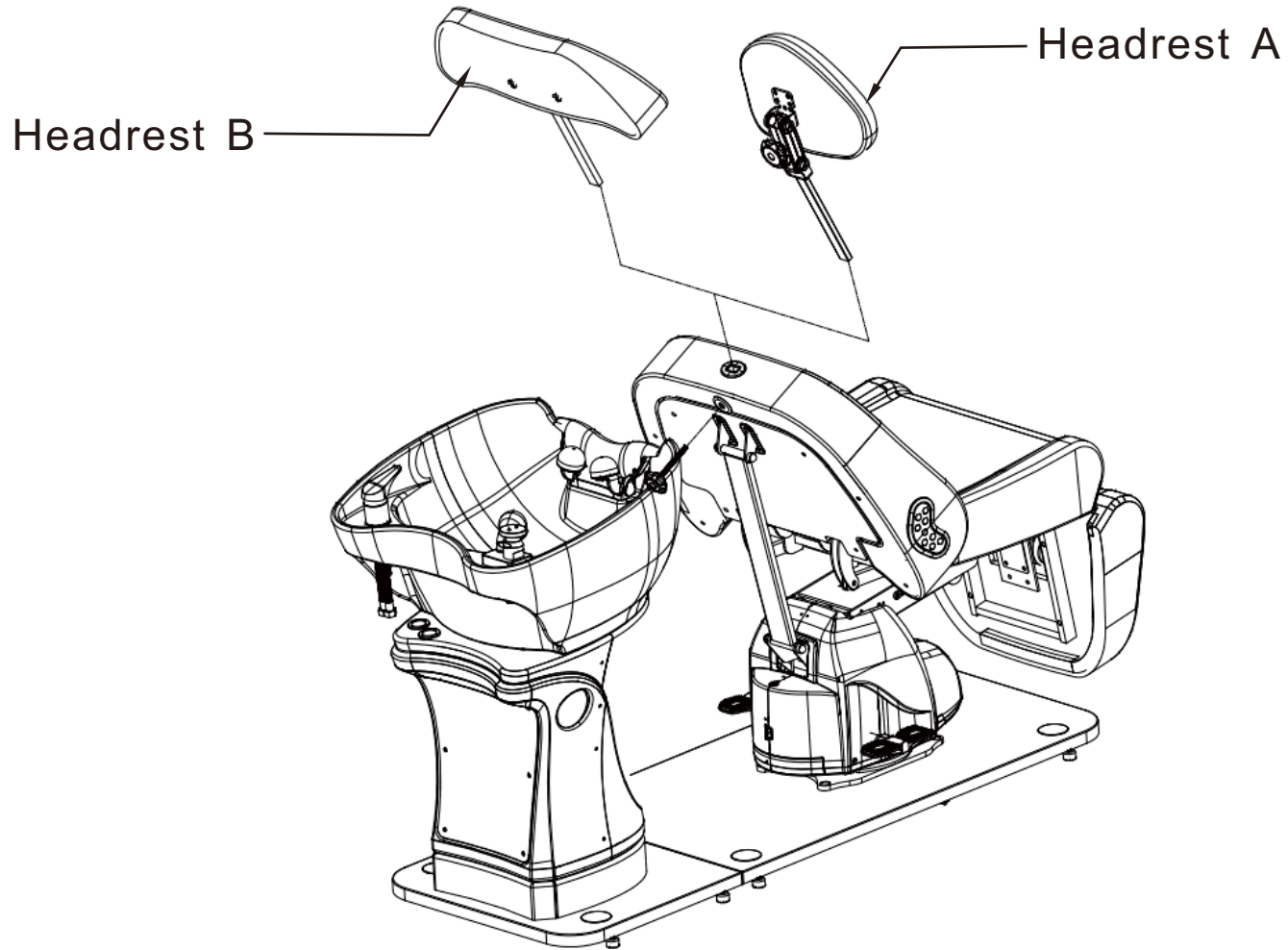

Headrest A & B are included for different types of services and features.

# ● Headrest Adjustments

Angle Adjustment Knob

Locking Knob

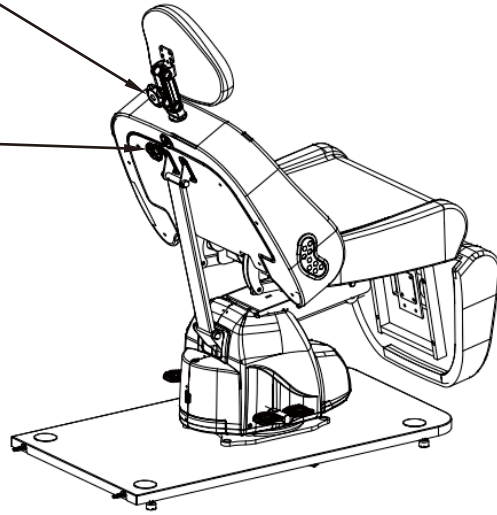

\* Adjust to desire angle and lock in position with Angle Locking Knob

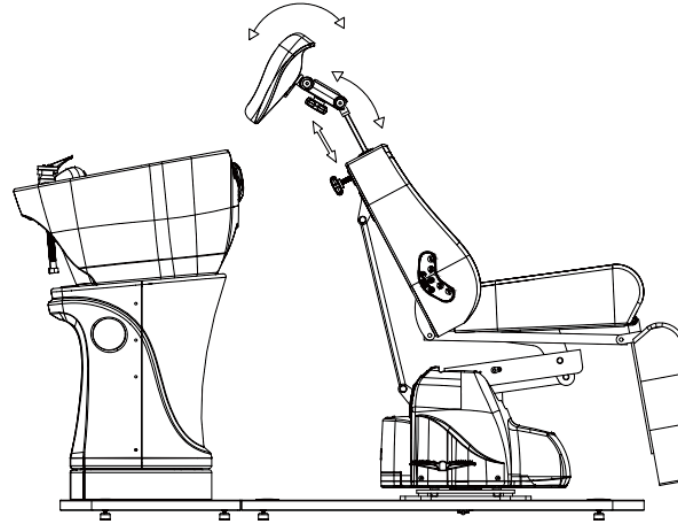

Locking Knob

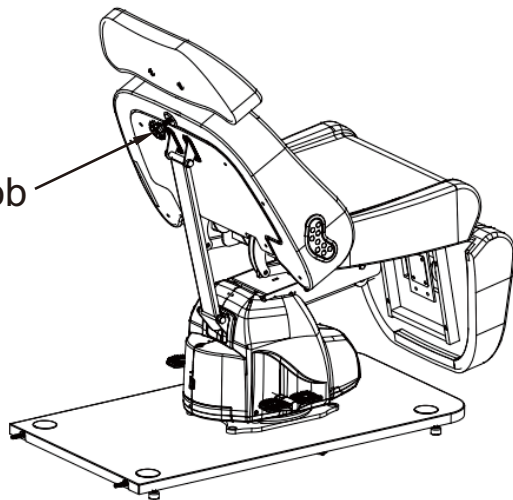

\* Adjust to desire headrest extension and lock in position with Locking Knob

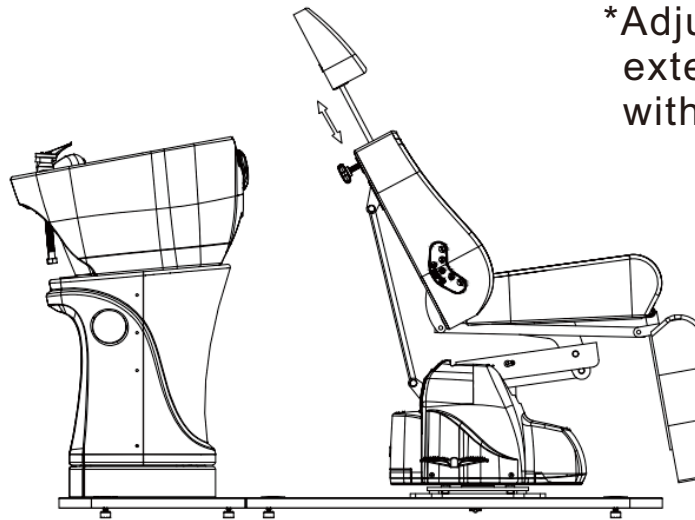

## Product care

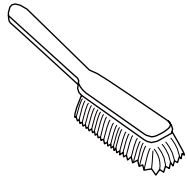

Brush away excess hair

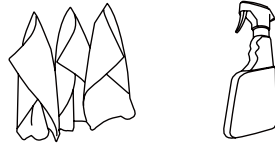

Clean surface with damp cloth or use simple soap & water solution.

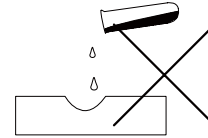

Avoid using corrosive cleaning agents such as bleaches.

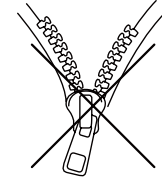

Do not remove upholstery for cleaning

## Warranty

The warranty period is one year. DIR warrants to you, the original buyer, that goods shall be free of defects in material and/or workmanship attributable to manufacture for one year from date of receipt of product. Damage resulting from improper handling after merchandise is received, or from exposure to weather or extreme atmospheric conditions is not covered by the warranty. For any other information please contact our support team:

### DIR Birmingham

66 Rea Street South  
Birmingham  
B5 6LB

Email: [sales@dirstore.co.uk](mailto:sales@dirstore.co.uk)  
Phone: +44 (0) 121 6434777

### DIR London

Unit 1 River Road Business Park,  
33 River Road, Barking,  
Greater London, 1G11 0DA

Email: [london@dirstore.co.uk](mailto:london@dirstore.co.uk)  
Phone: +44 (0) 20 8591 9310

### DIR New York

575 Underhill Blvd Suite #170  
Syosset, NY 11791, USA

Email: [sales@dirsalonfurniture.com](mailto:sales@dirsalonfurniture.com)  
Phone: +1 (718) 628 6668  
+1 (800) 728 2008  
Fax: +1 (855) 628 5168