

DIR

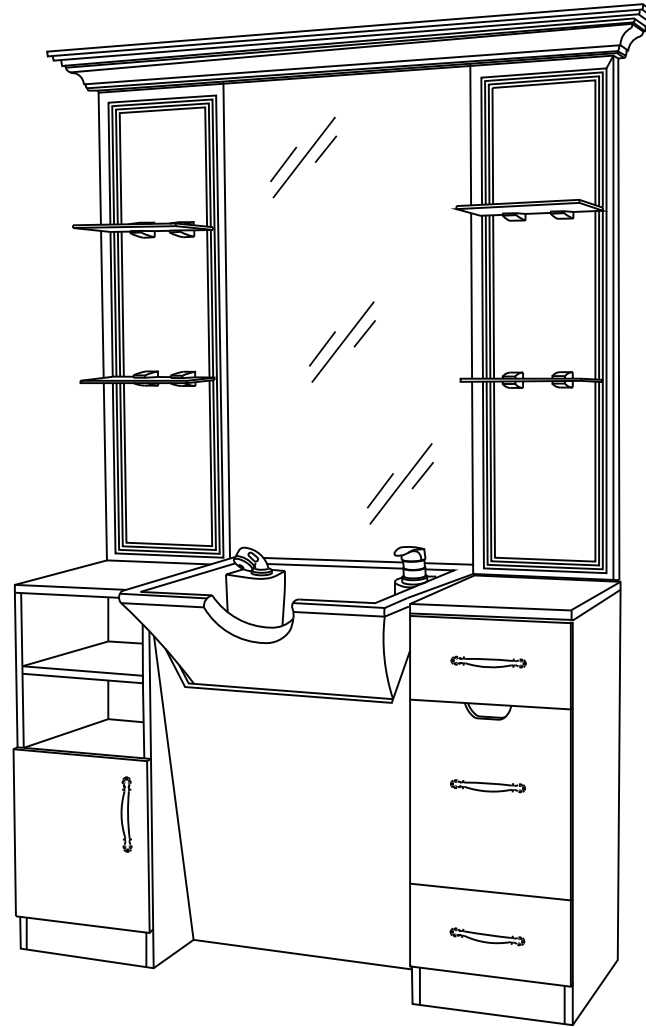

Taylor

6858
INSTRUCTION MANUAL

List of Parts & Tools

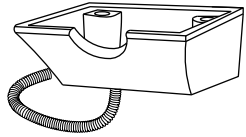

x1

101001

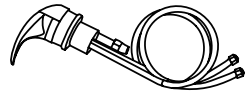

x1

101002

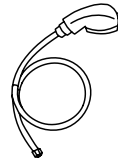

x1

101003

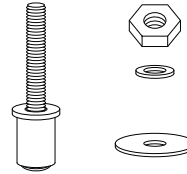

101004

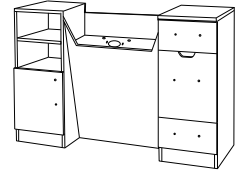

x1

101005

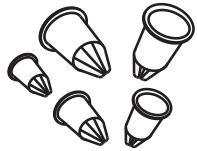

x5

101006

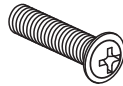

x8

101007



x4

101008



x18

101009

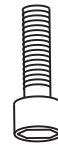

x8

101010

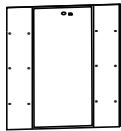

x1

101011

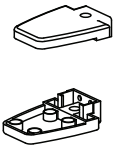

x8

101012



x4

101013



x1

101014

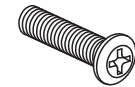

x4

1010015



x1

101016

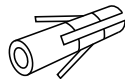

x2

101017

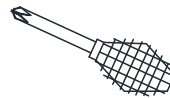

x1

101018

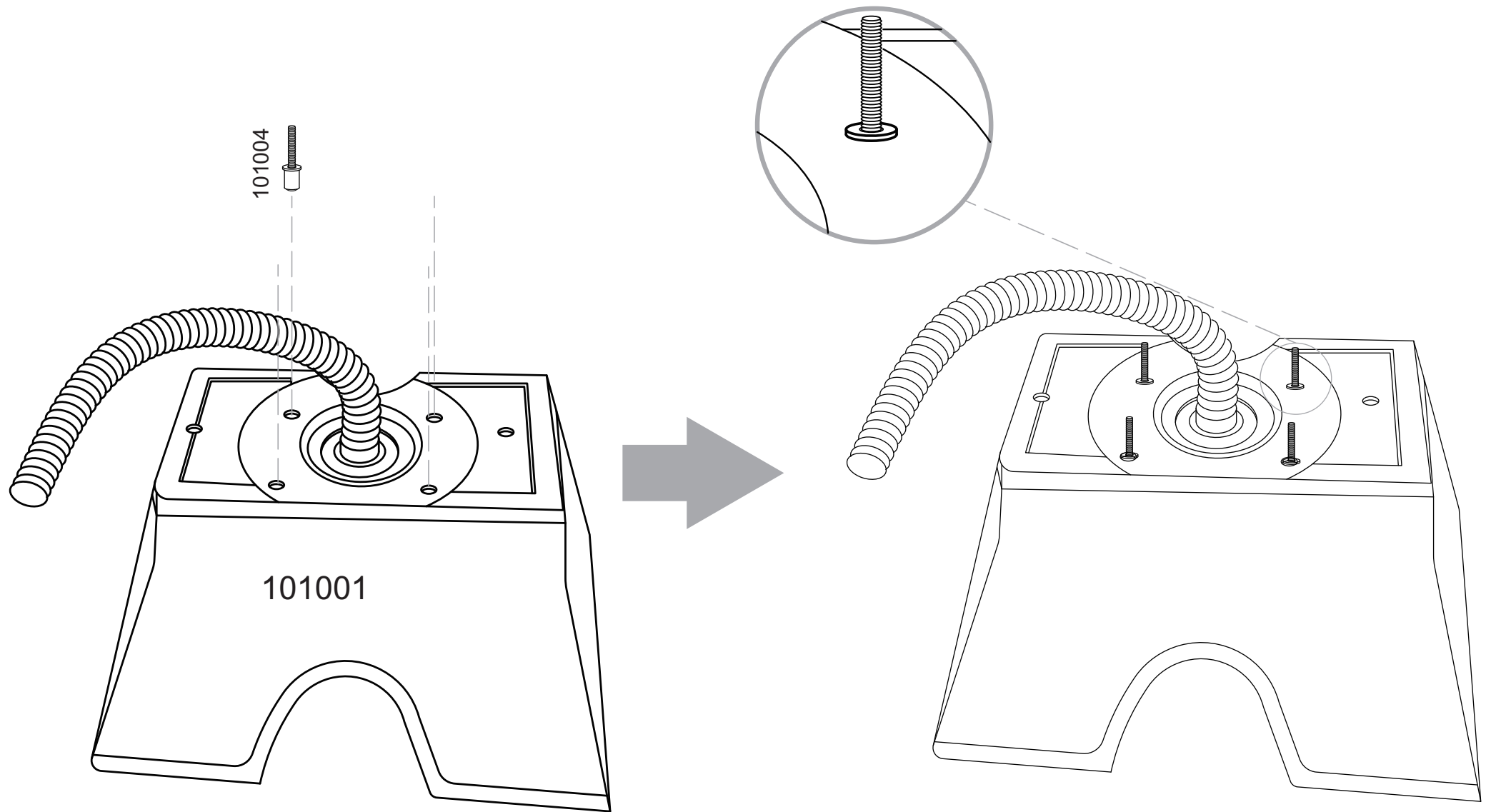

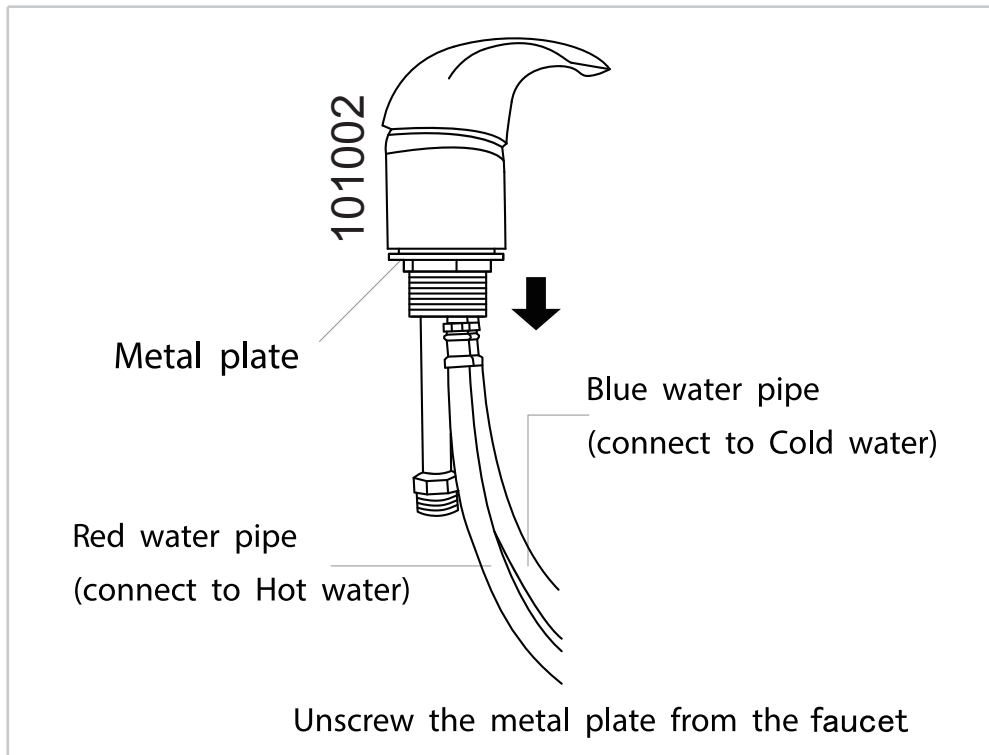
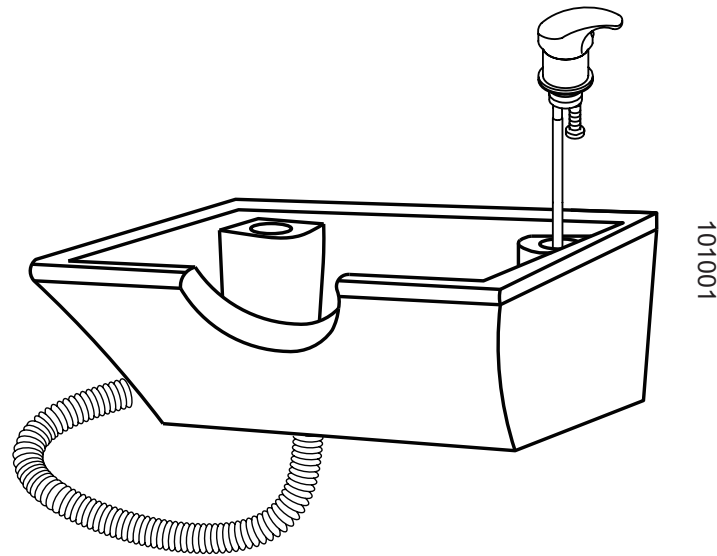

STEP 1

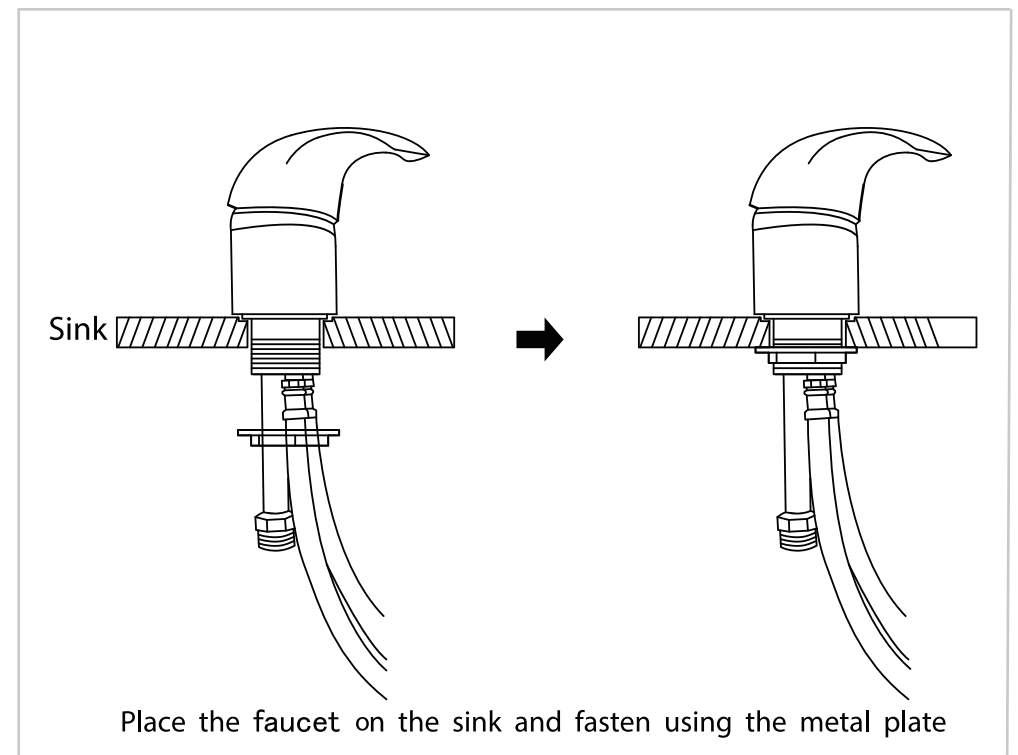

STEP 2

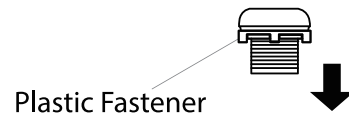
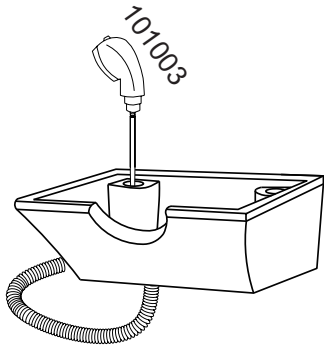

Plastic Fastener

Unscrew the fastener from the sprayerhead holder.

STEP 1

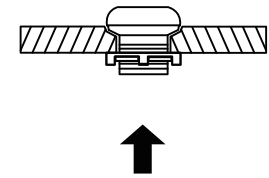
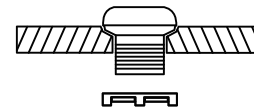

Fasten the sprayerhead holder to the sink with the plastic fastener.

STEP 2

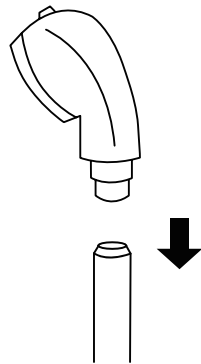

Unscrew the sprayerhead from the sprayer hose.

STEP 3

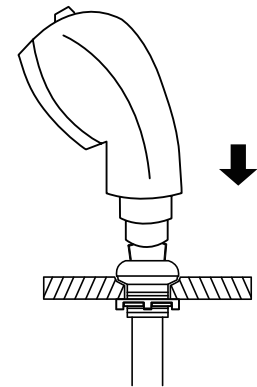
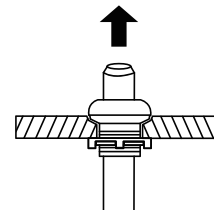

Place the sprayer hose from underneath through the sprayerhead holder and fasten the sprayerhead to the sprayer hose.

STEP 4

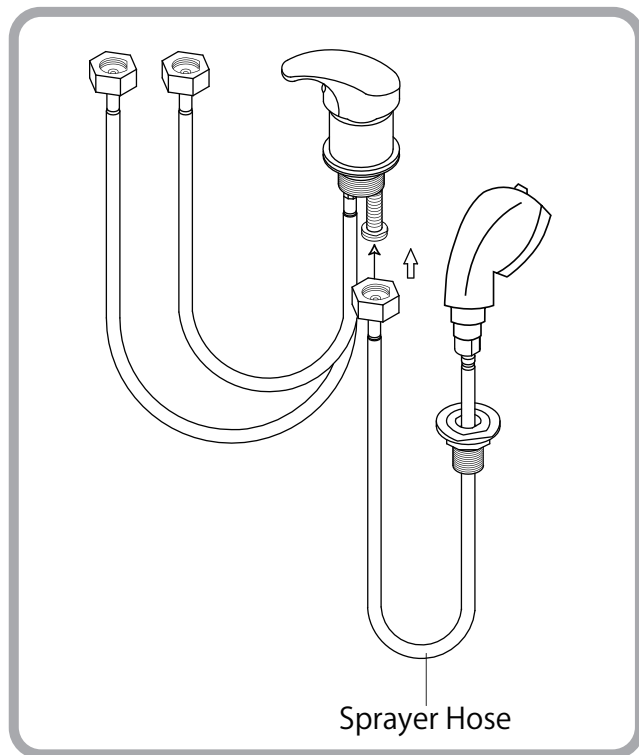

Connect to sprayer hose to the tap shown in the diagram.

Red water pipe
(connect to hot water)

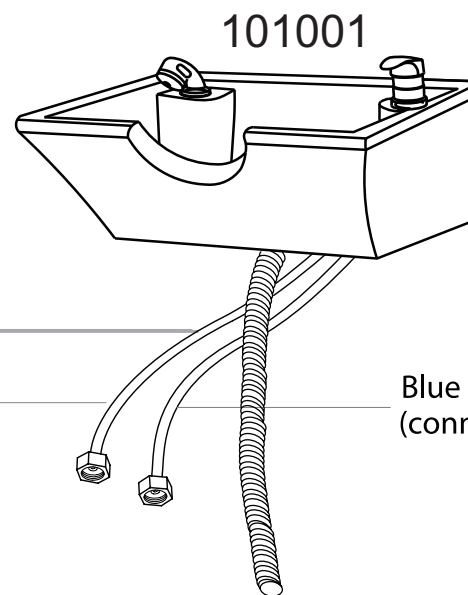

Blue water pipe
(connect to cold water)



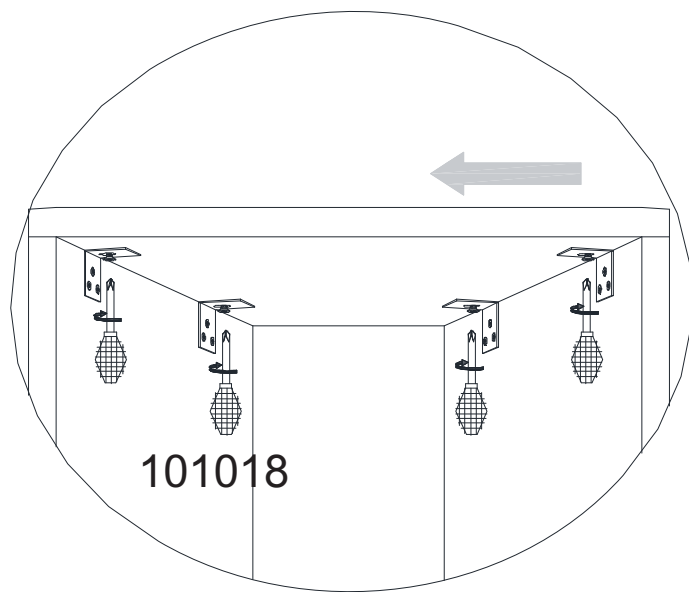

Slide counter panel to the left to allow sink to be mounted.

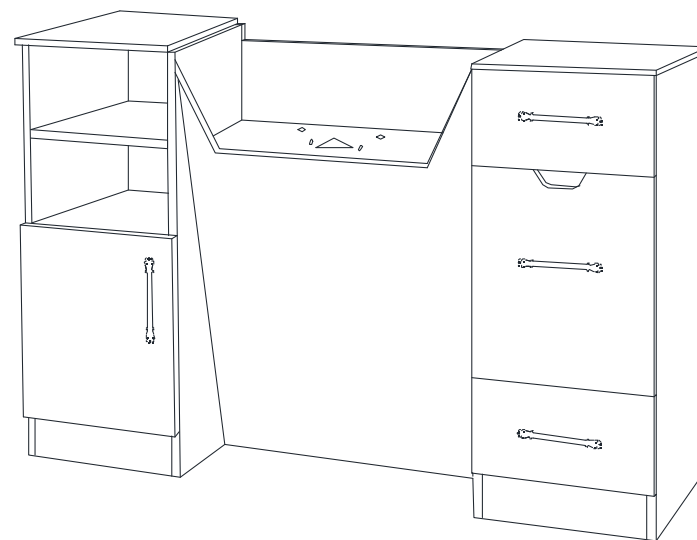
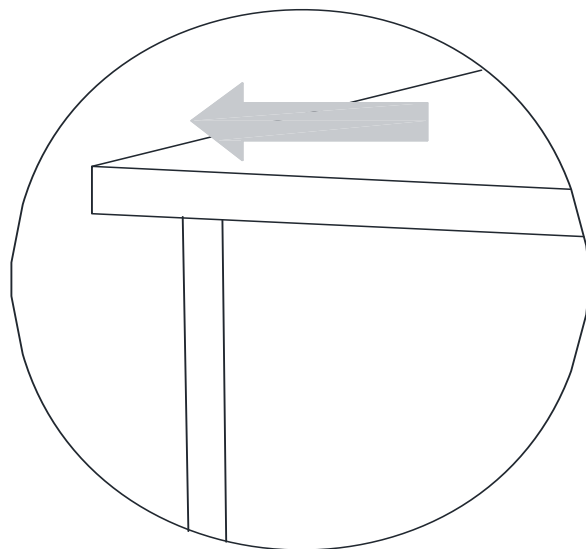
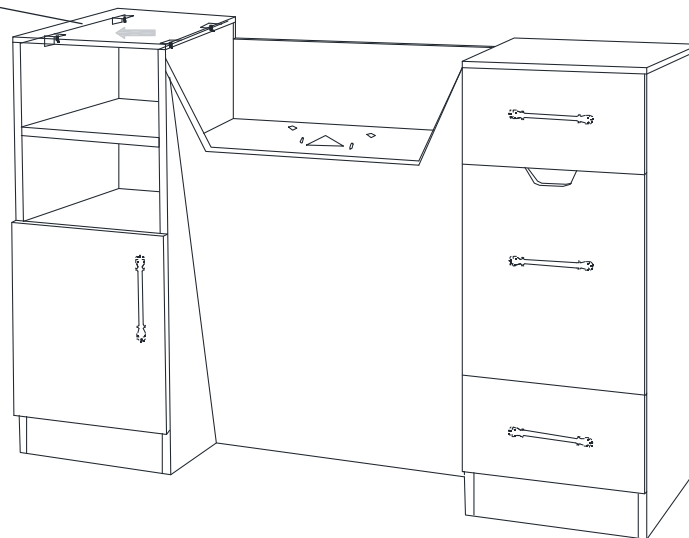

Step 6

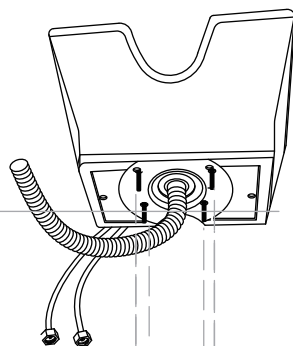
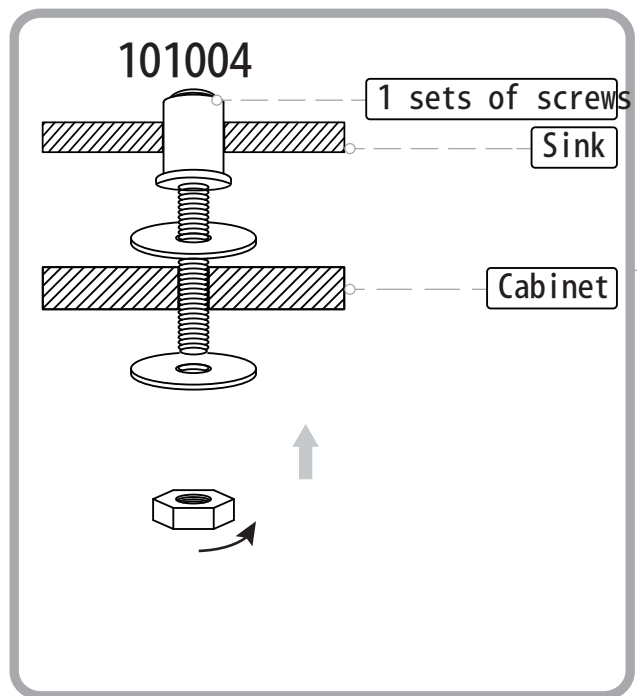

Remove nuts & washer from sink, secure sink in position and lock in with provided nuts & washers.

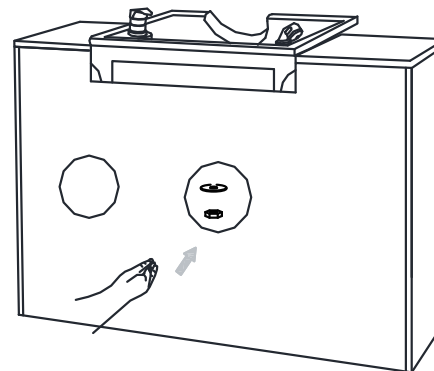
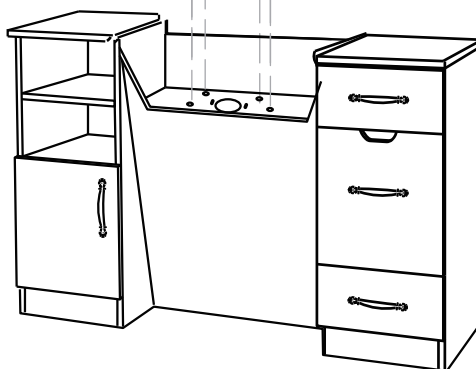

After sink is secured, slide counter panel to the right and lock in position.

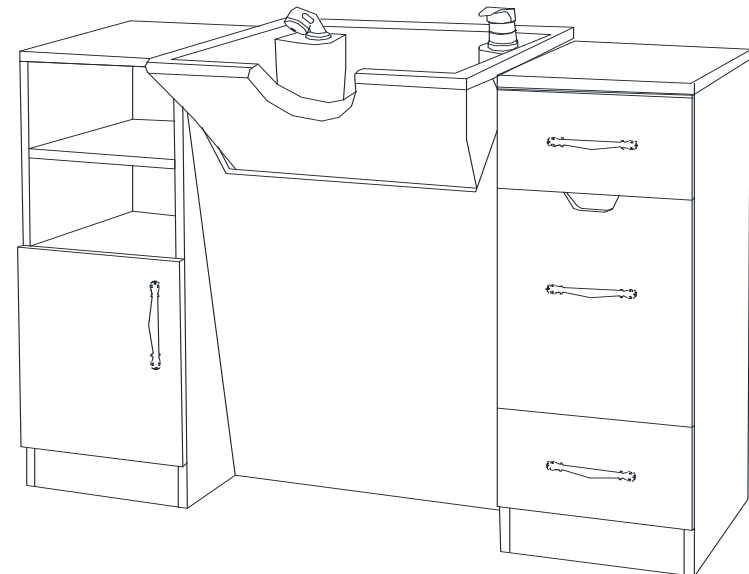
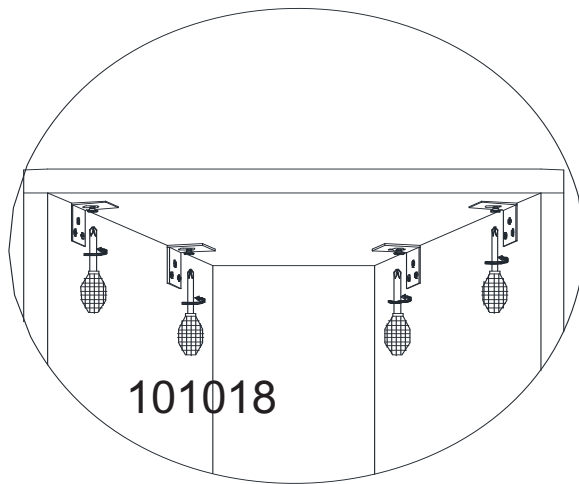
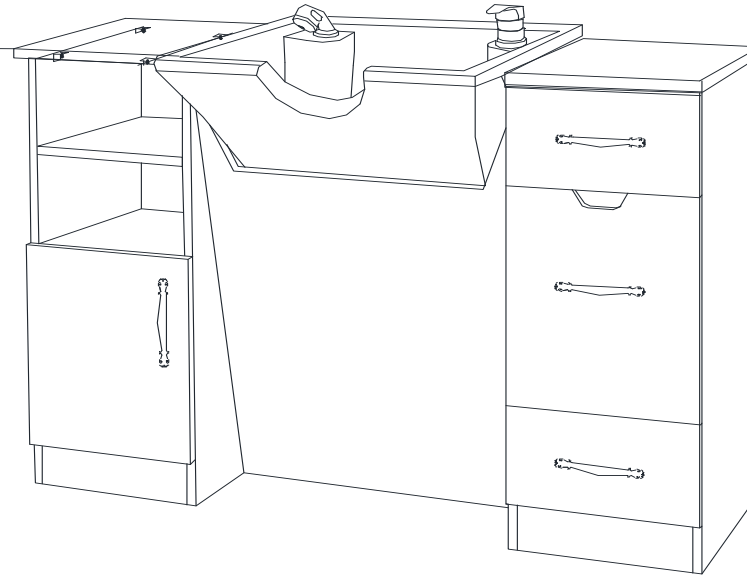
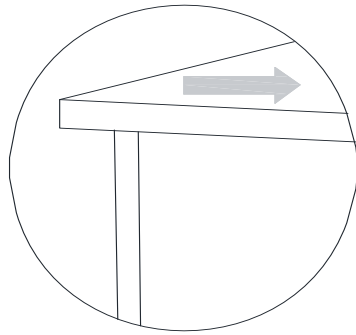

Step 8

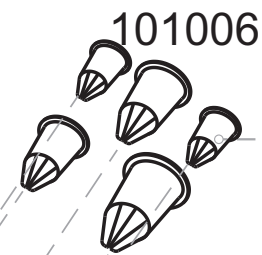
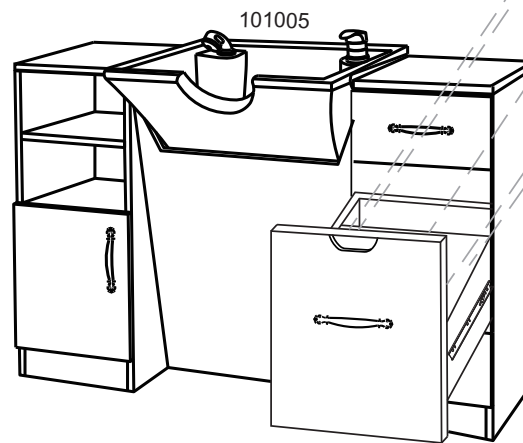
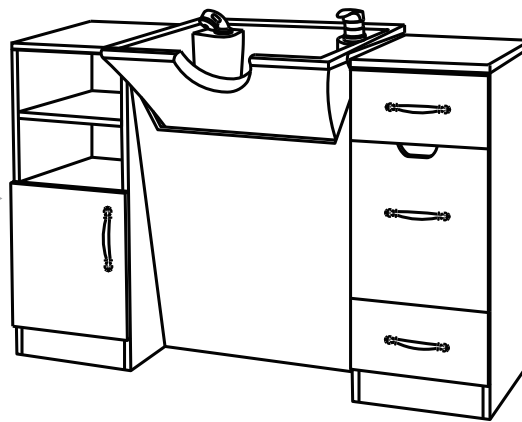
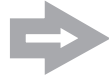
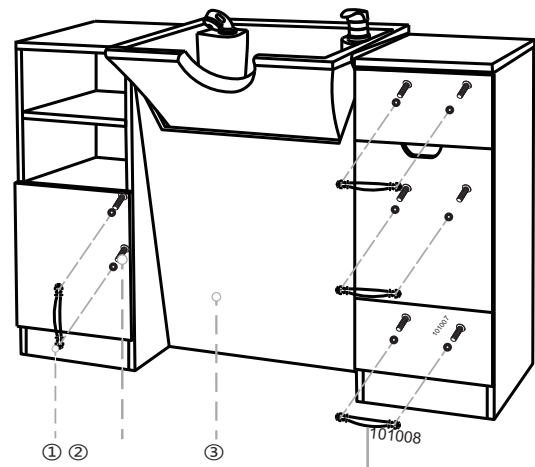

④

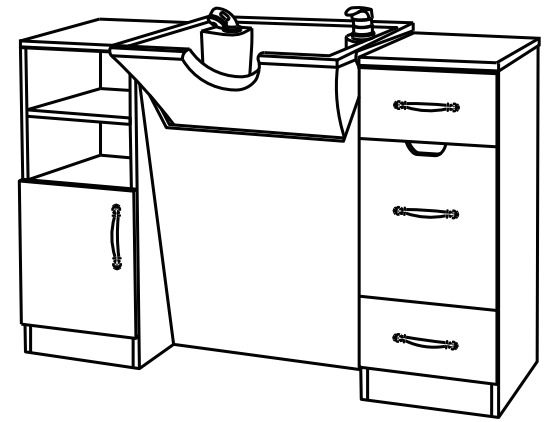

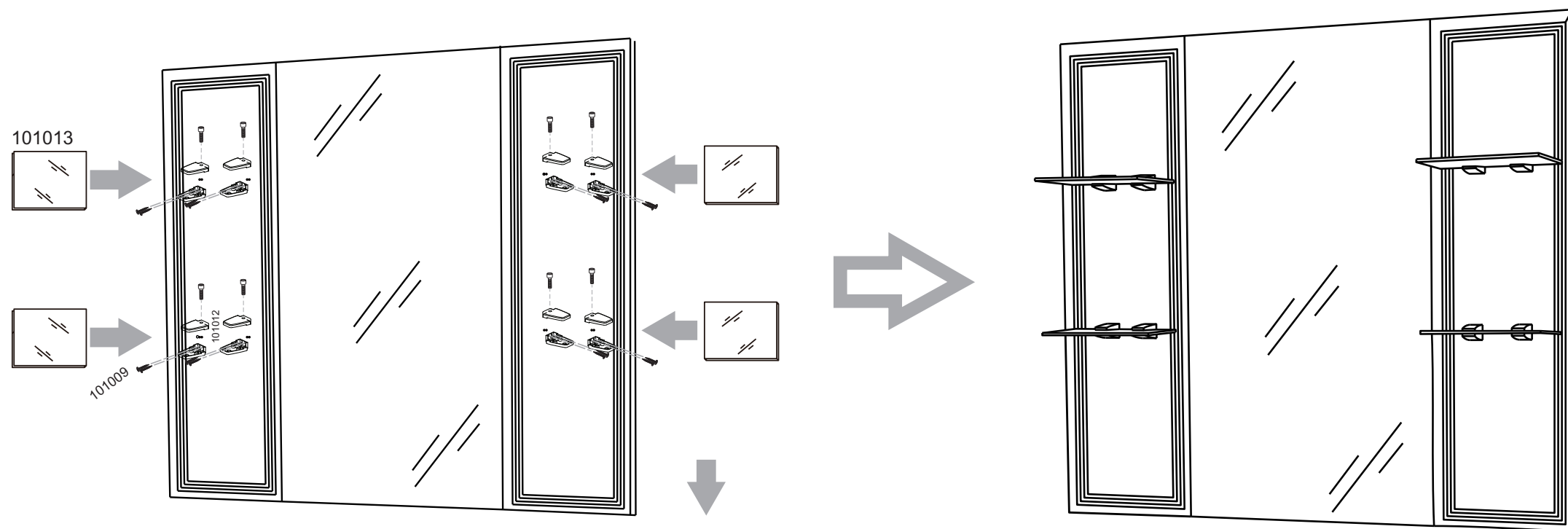

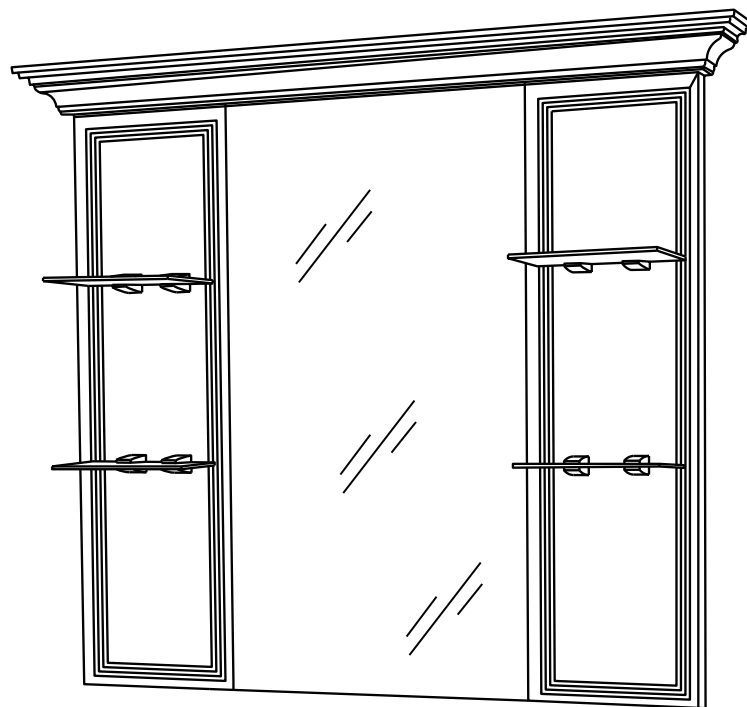
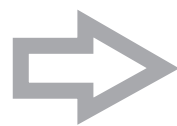
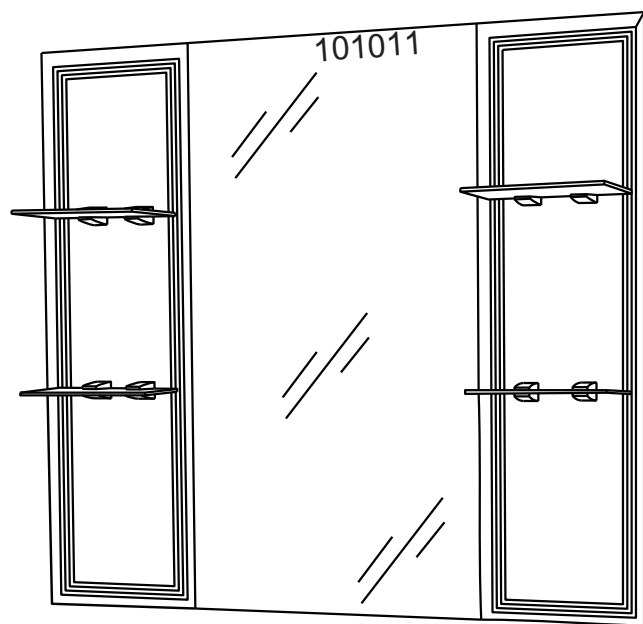
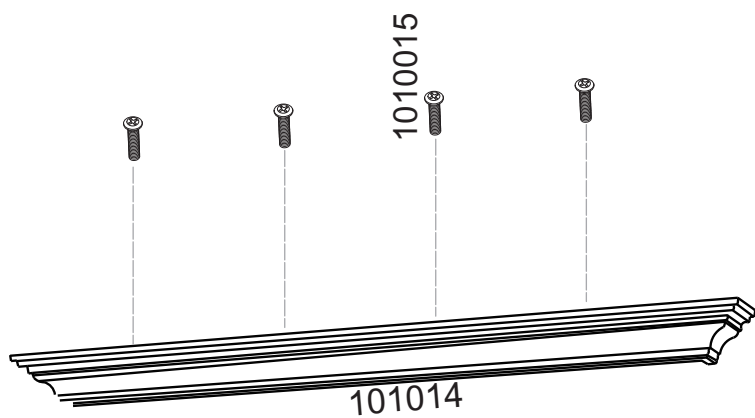

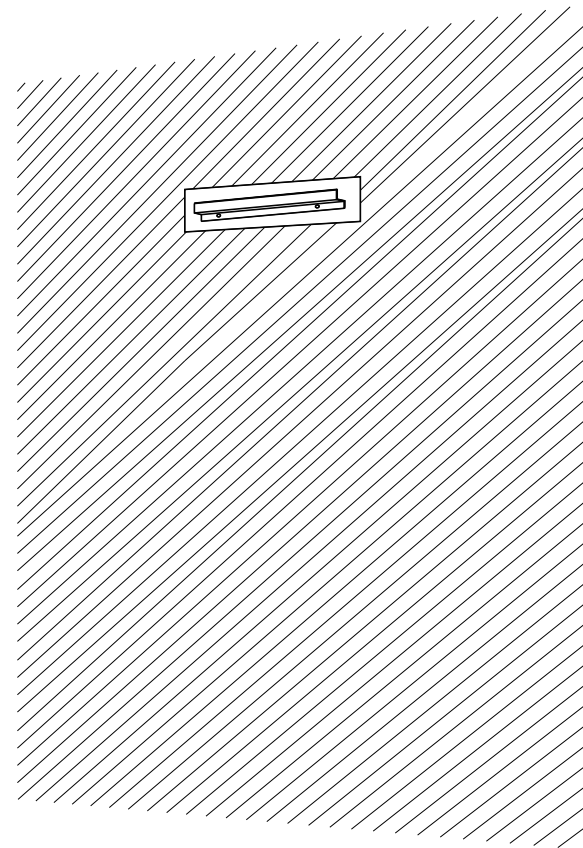
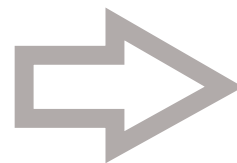
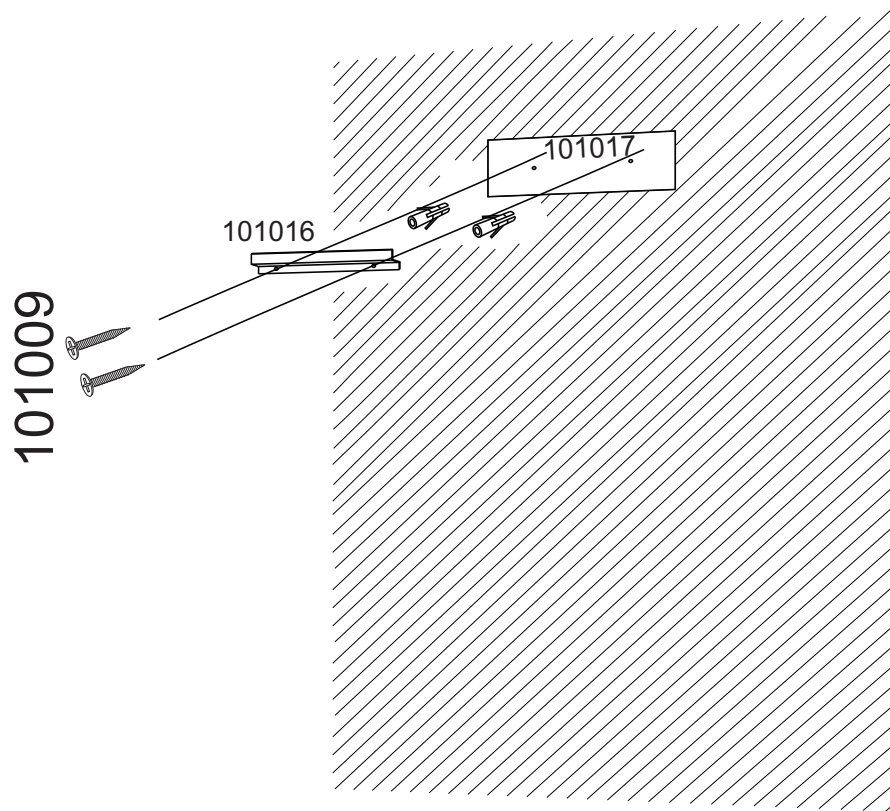

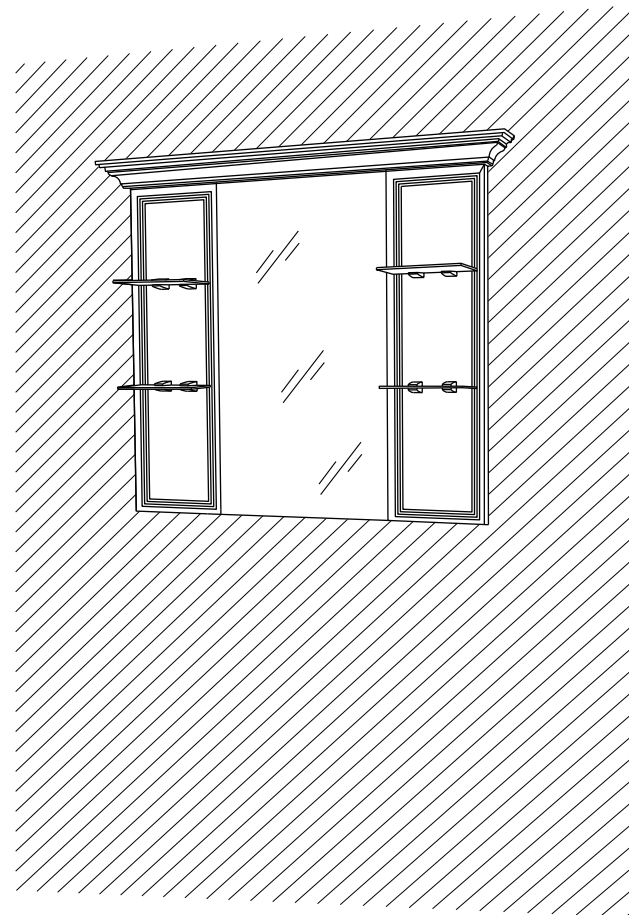
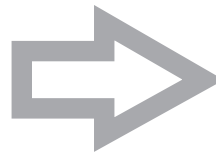
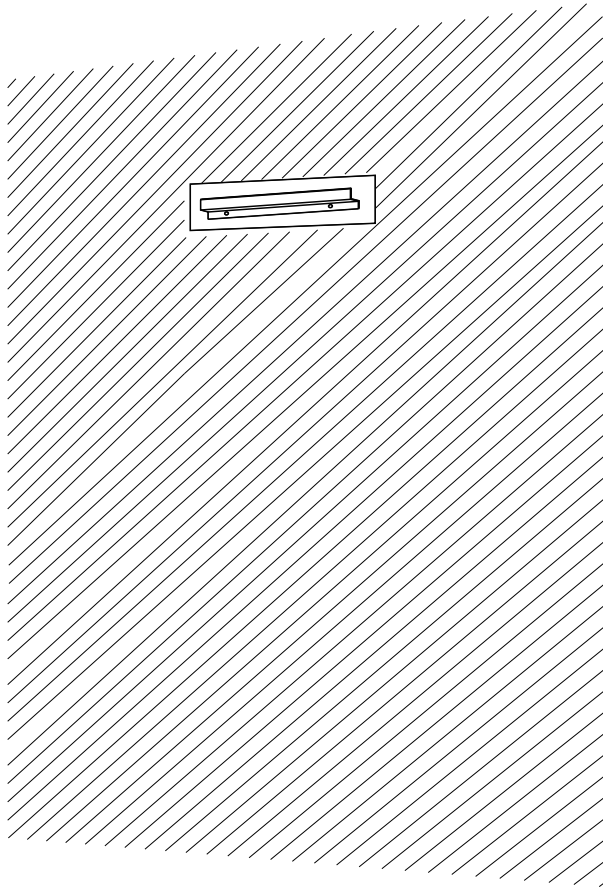
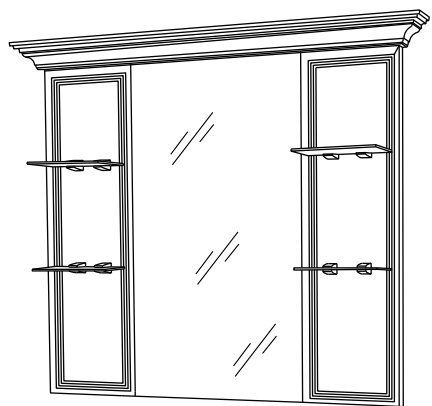

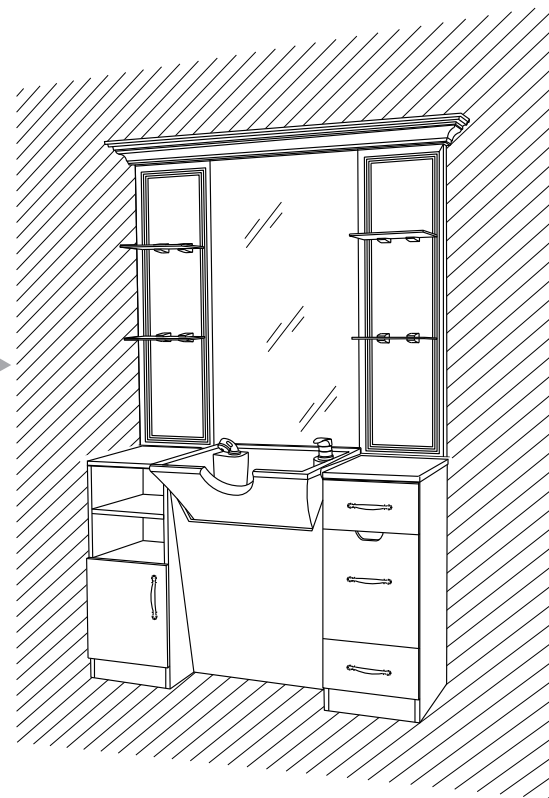
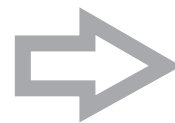
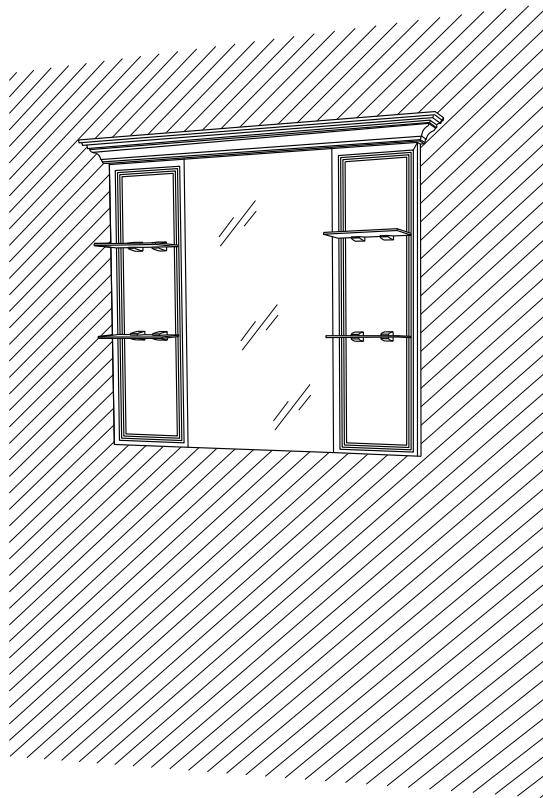
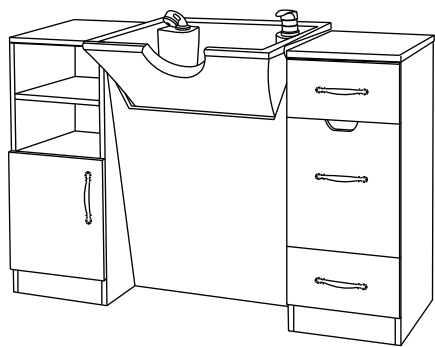

Product care



Brush away excess hair

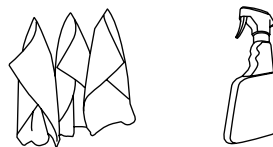

Clean surface with damp cloth or use simple soap & water solution.

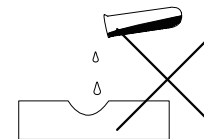

Avoid using corrosive cleaning agents such as bleaches.

Warranty

The warranty period is one year. DIR warrants to you, the original buyer, that goods shall be free of defects in material and/or workmanship attributable to manufacture for one year from date of receipt of product. Damage resulting from improper handling after merchandise is received, or from exposure to weather or extreme atmospheric conditions is not covered by the warranty. For any other information please contact our support team:

DIR BIRMINGHAM

66 Rea Street South
Birmingham
B5 6LB
UK

Tel:
+44(0)121 6434777

Email:
dirlsalon@gmail.com

DIR LONDON

Unit 1 River Road
Business Park
33 River Road, Barking
Greater London
IG11 0DA
UK

Tel:
+44(0)20 8591 9310

Email:
dirlsalon@gmail.com

DIR NEW YORK

575 Underhill Blvd.
Suite 170
Syosset, NY 11791
USA

Tel:
+1 (718)628-6668
+1 (800)728-2008

Email:
sales@dirlsalonfurniture.com

DIR IRELAND

Unit 20, Goldenbridge Ind.
Estate Tyrconnell Road
Inchicore
Dublin 8
Republic of Ireland

Phone:
+353 (1) 429 7969

Email:
sales.ireland@dirgroup.ie

Replacement of marble countertops

Marble

countertops are optional products



step 1

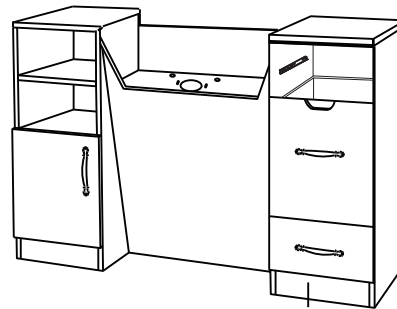
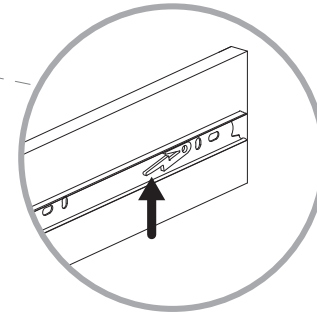
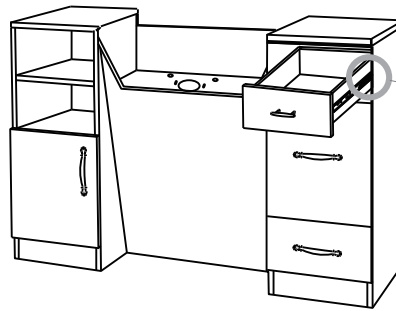
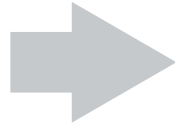

step 2

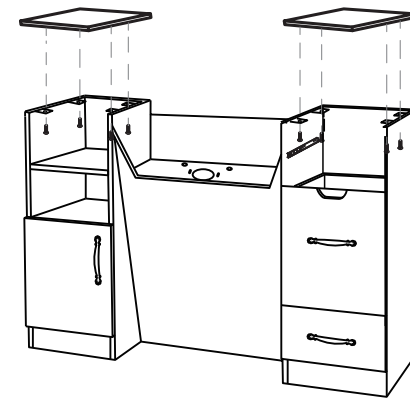

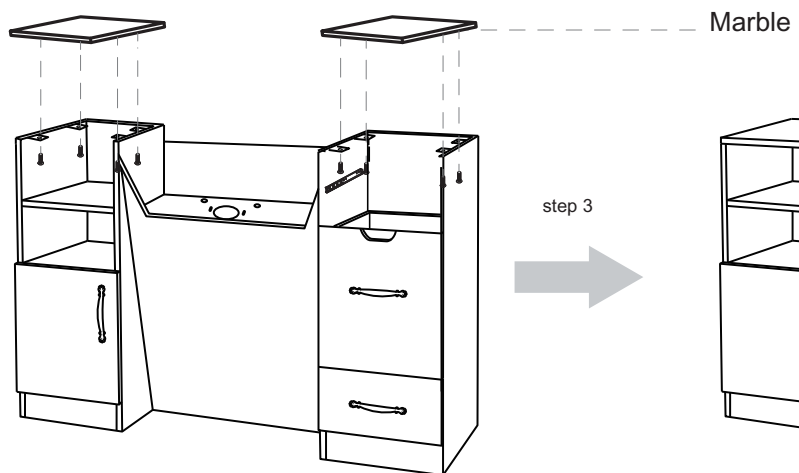

step 3

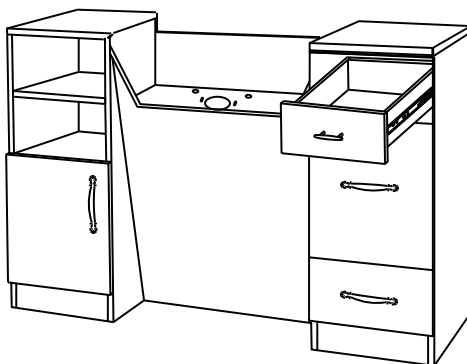
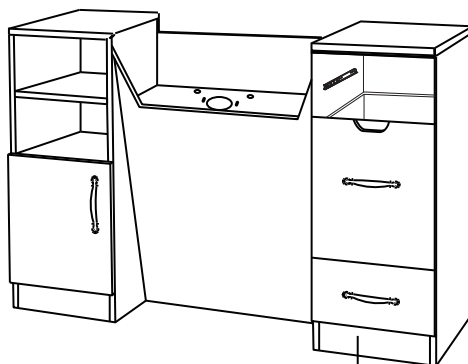

step 4

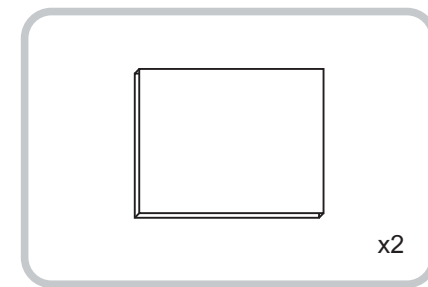
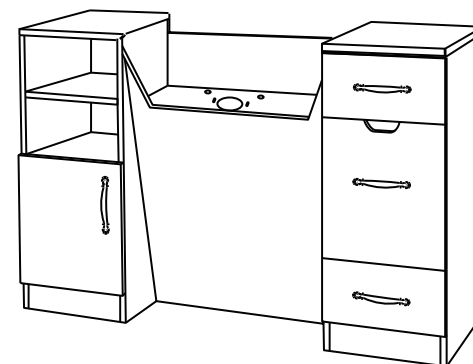

Marble(Optional)

