

DIR[®]

Victoria

7062

INSTRUCTION MANUAL

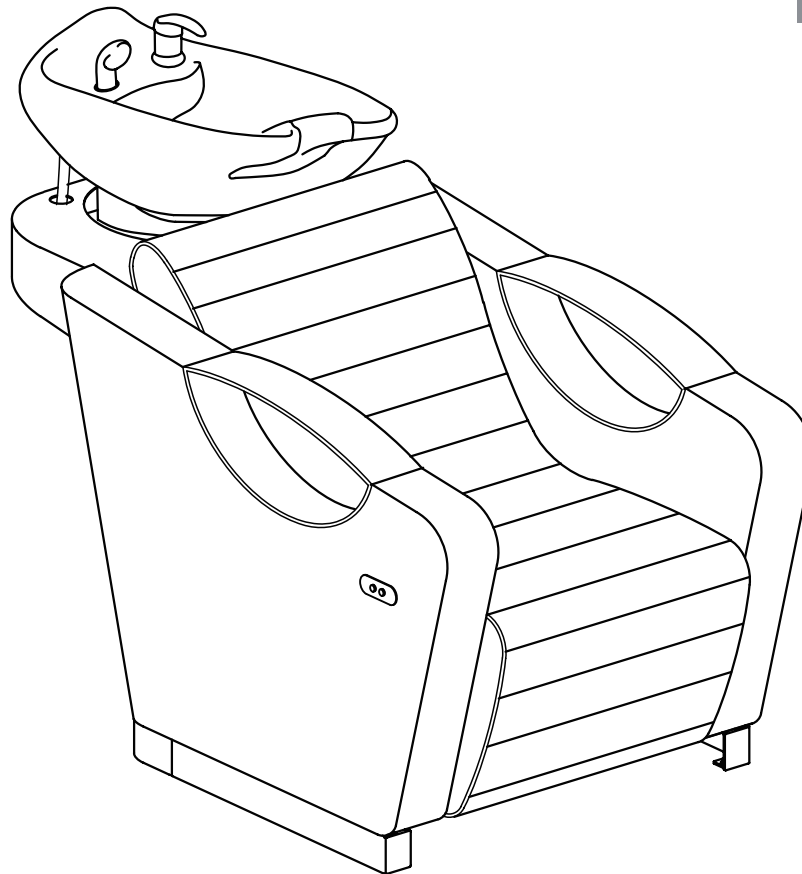

List of Parts & Tools

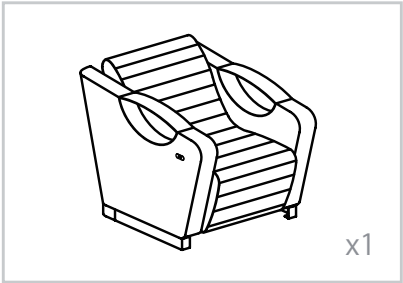

101001

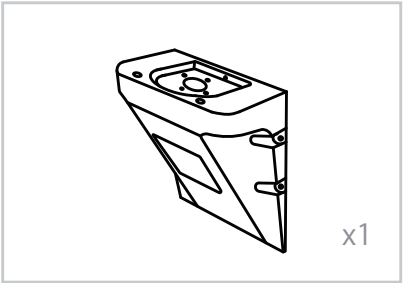

7001

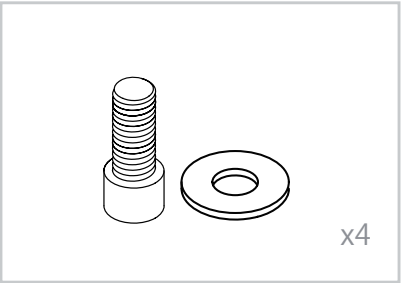

101003

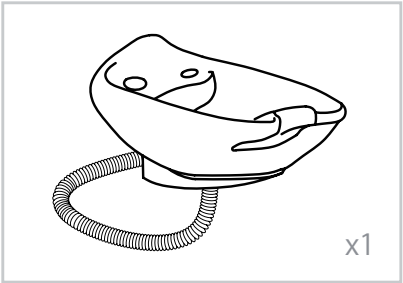

0350/0388

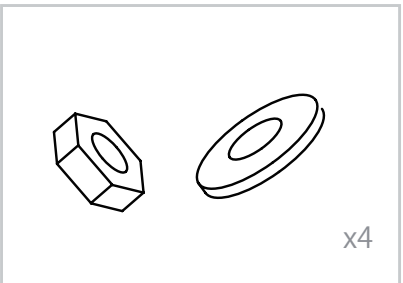

101005

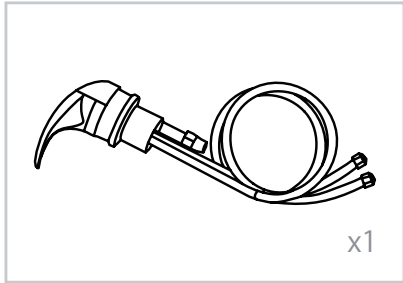

101006

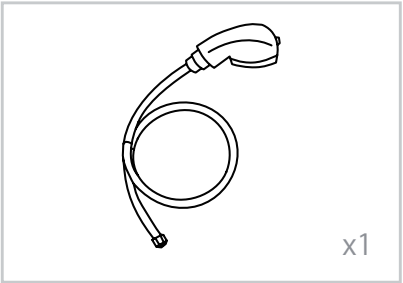

101007

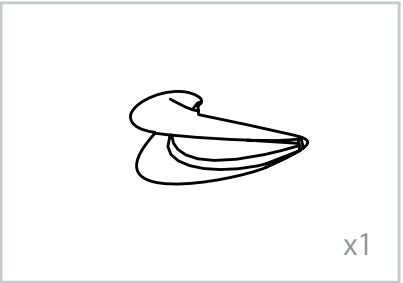

101008

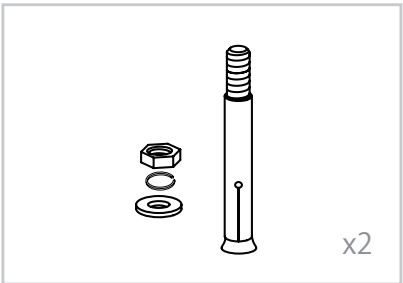

101009

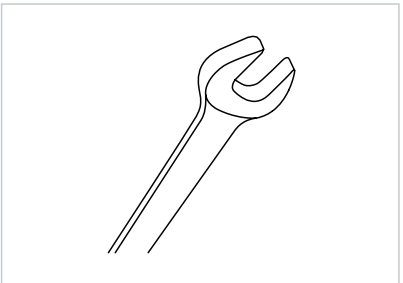

101010

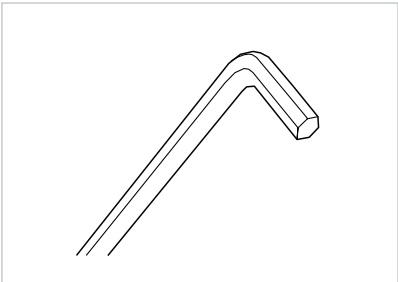

101011

Type	USA size	UK size
Water supply lines Adapter	5/8"	1/2"
Drain Hose Connector	1 1/4"	3.2cm

Assembly Instruction 1

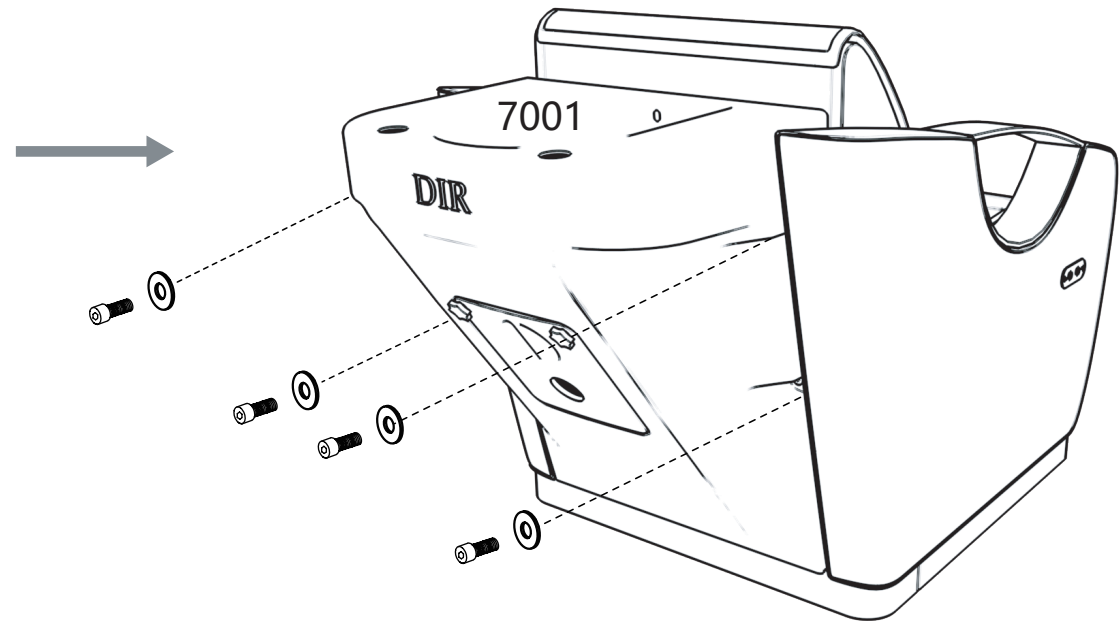
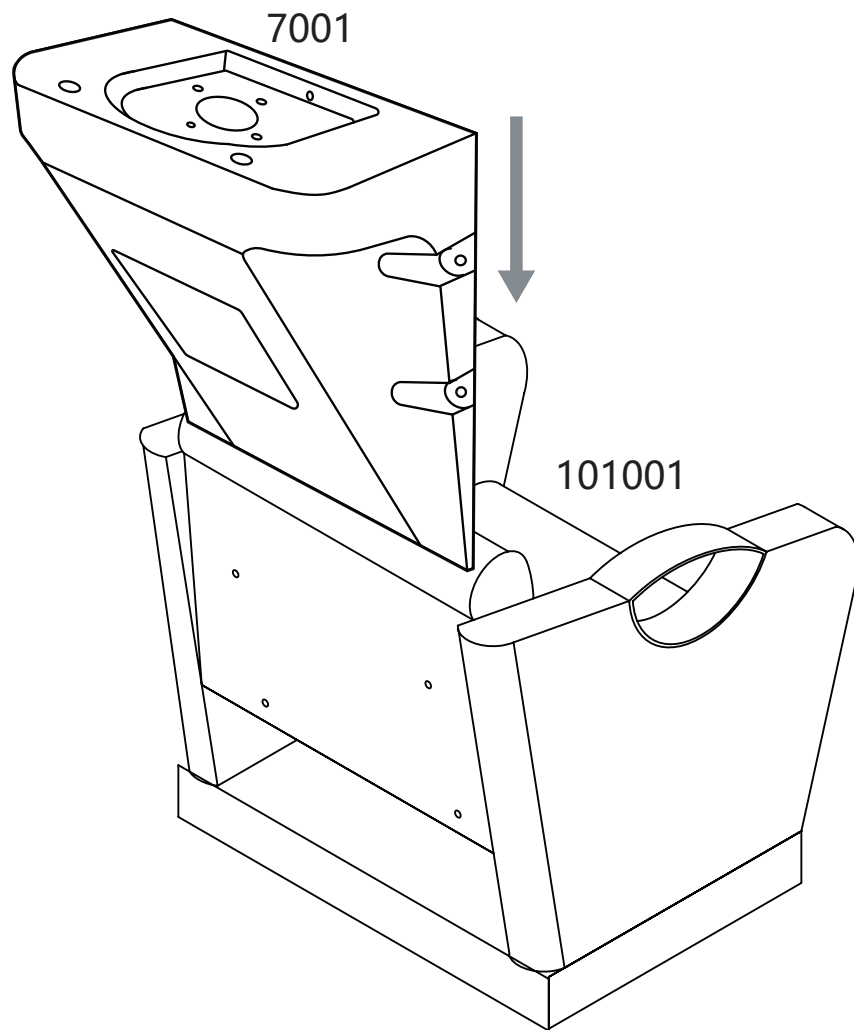

0350

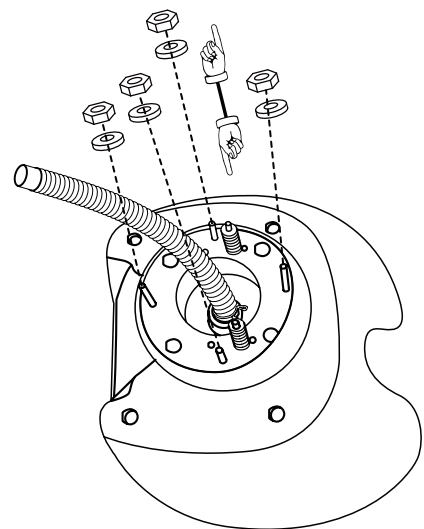

0350

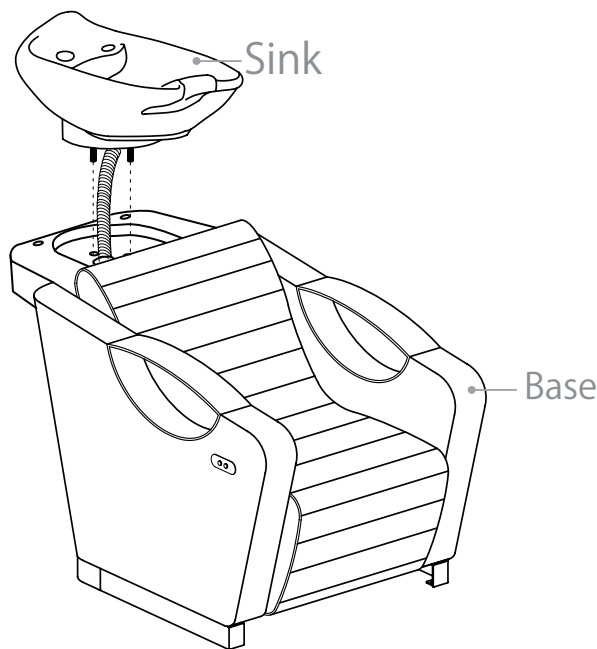

Front

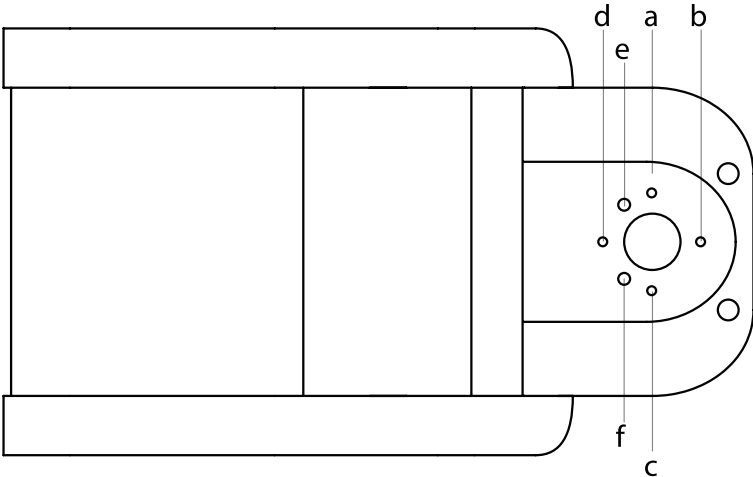

0350

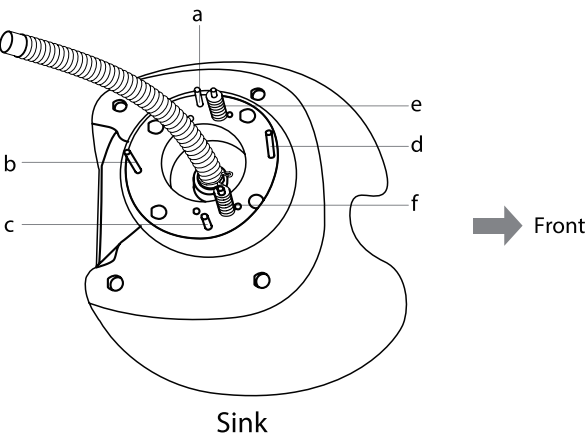

Align the sink to the base as shown in the diagram.

0350

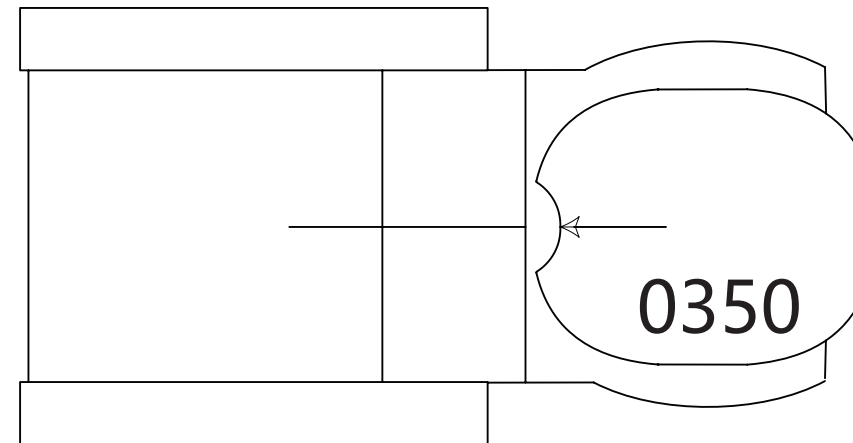
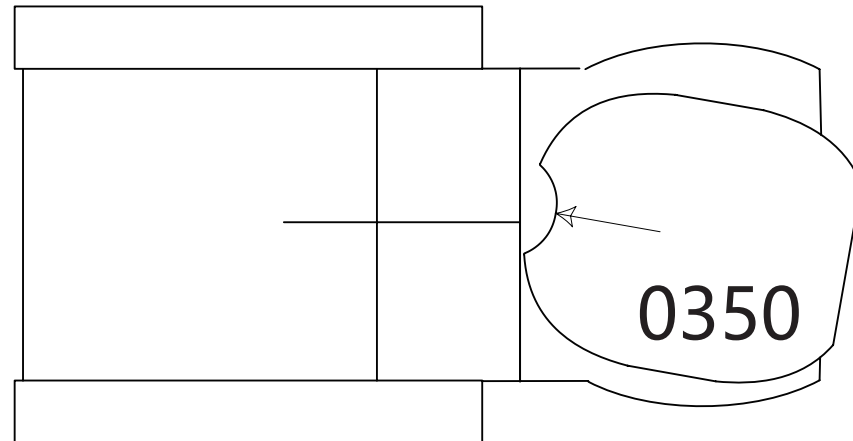
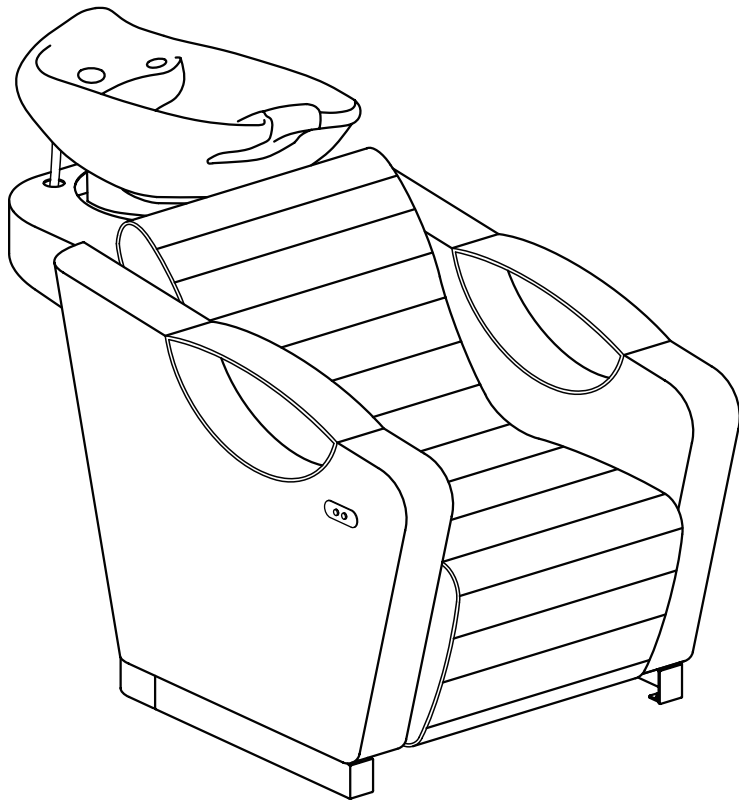

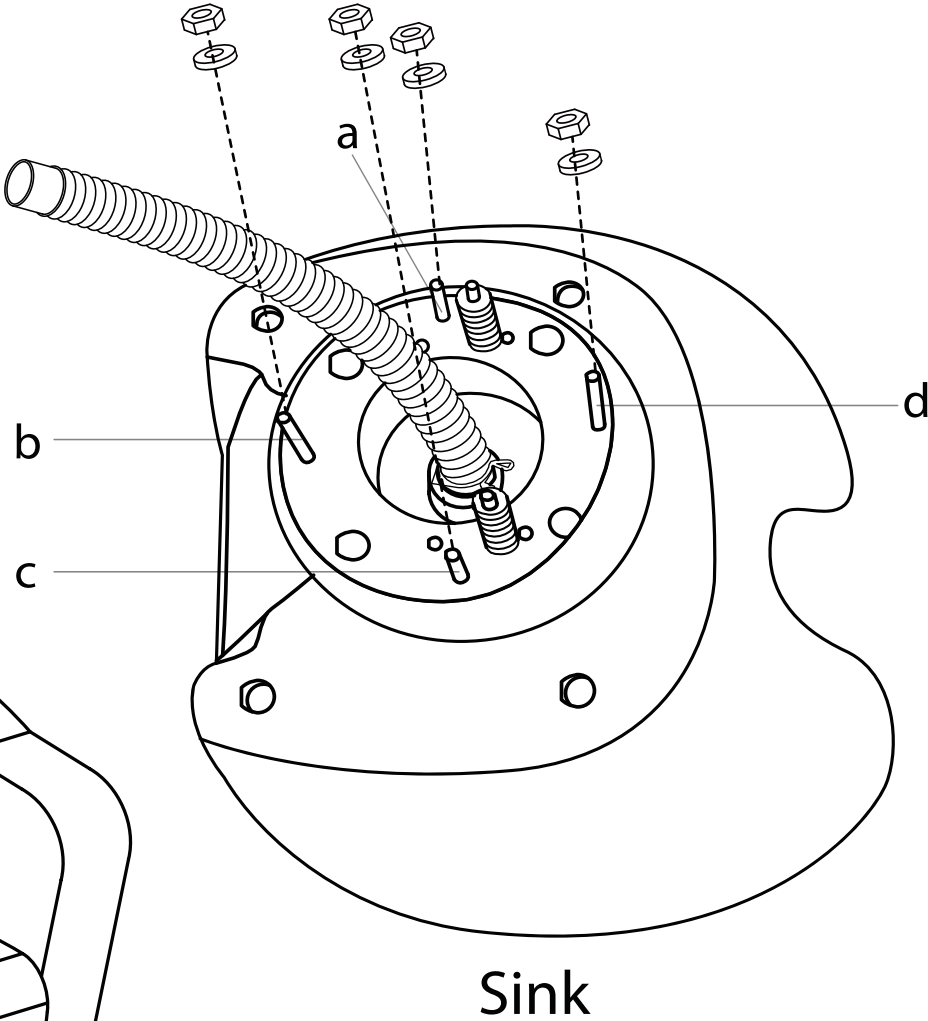
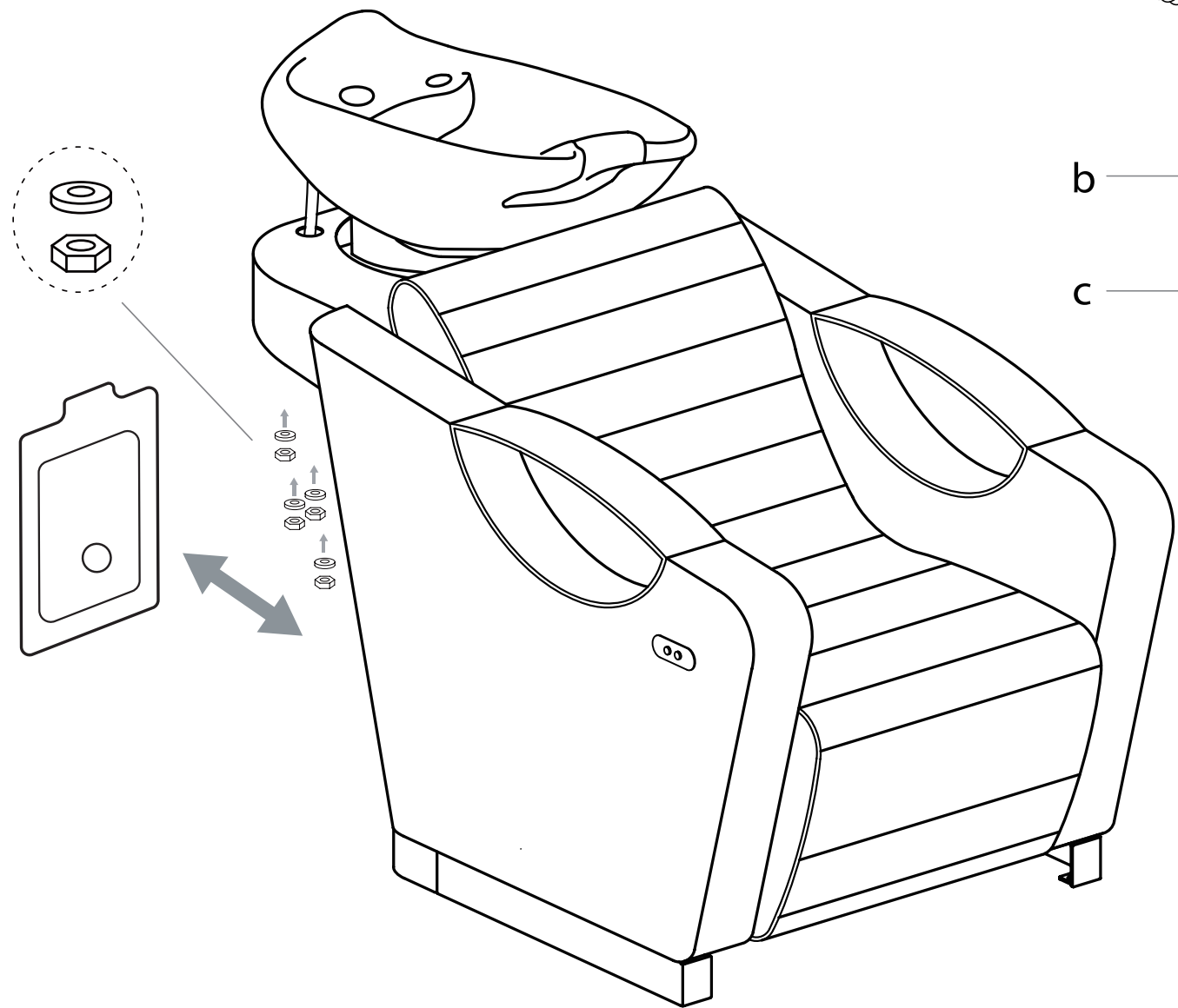

Faucet Set up

None Vacuum Breaker Sink

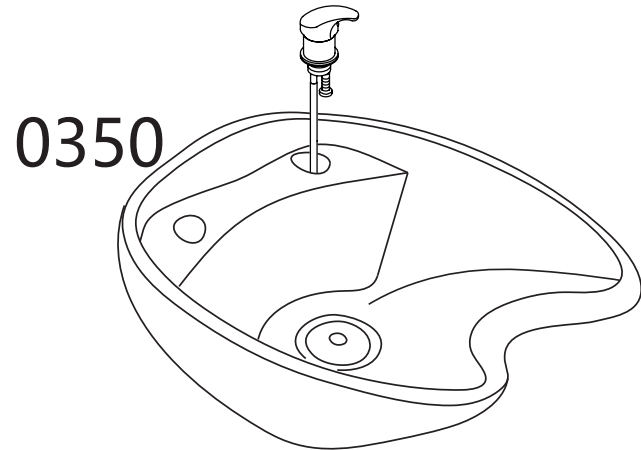

Vacuum Breaker Sink

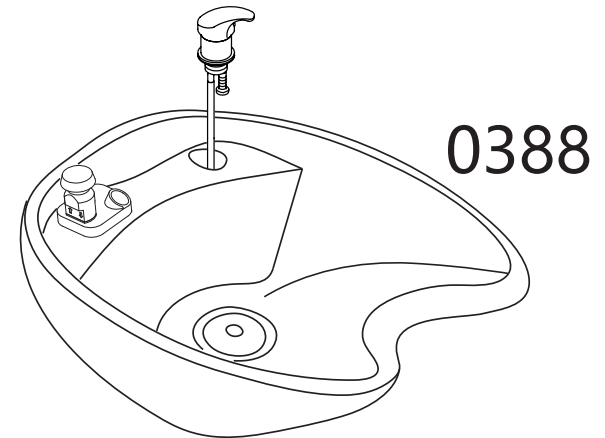

or

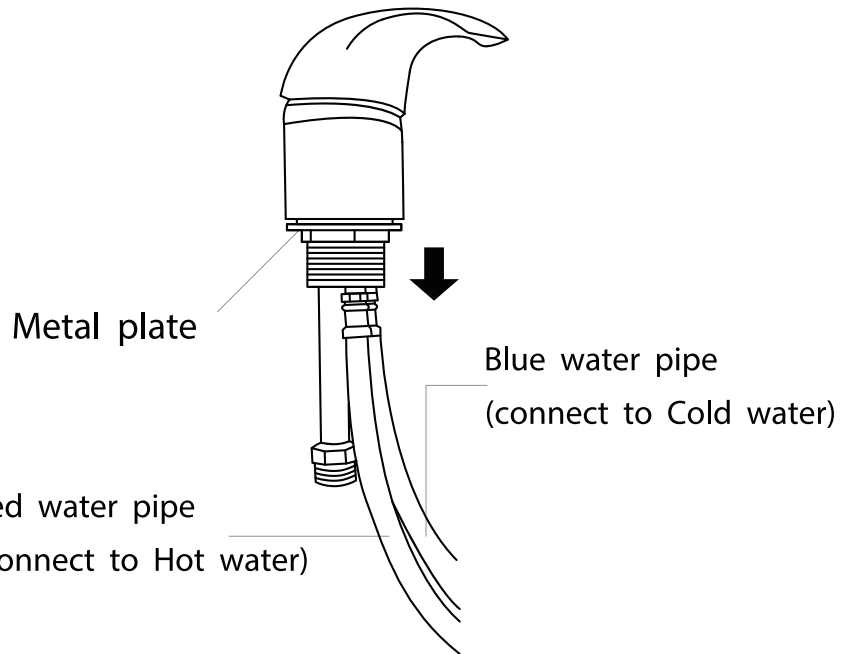

Unscrew the metal plate from the faucet

STEP 1

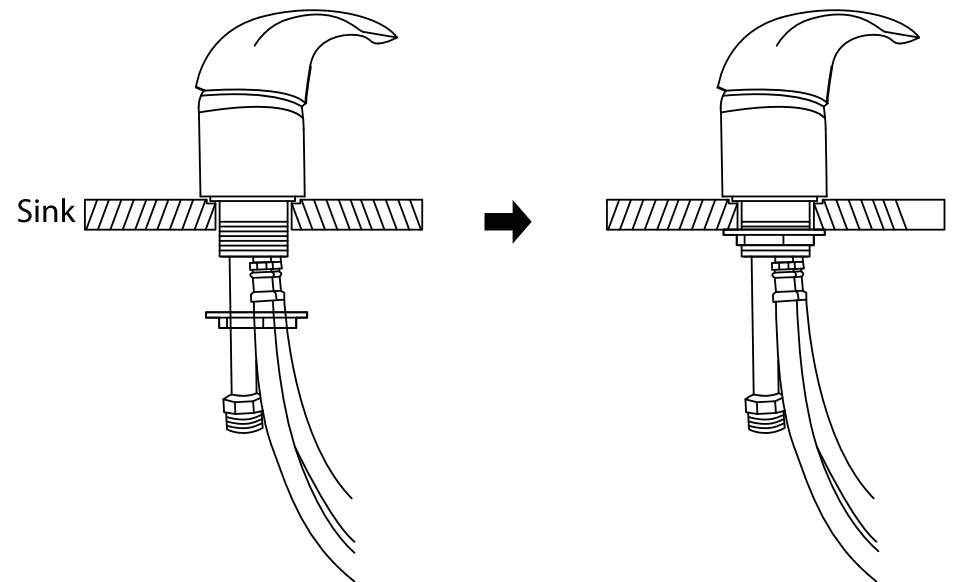

Place the faucet on the sink and fasten using the metal plate

STEP 2

Sprayer Set Up None Vacuum Breaker Sink

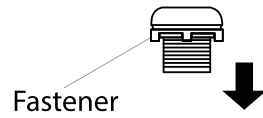
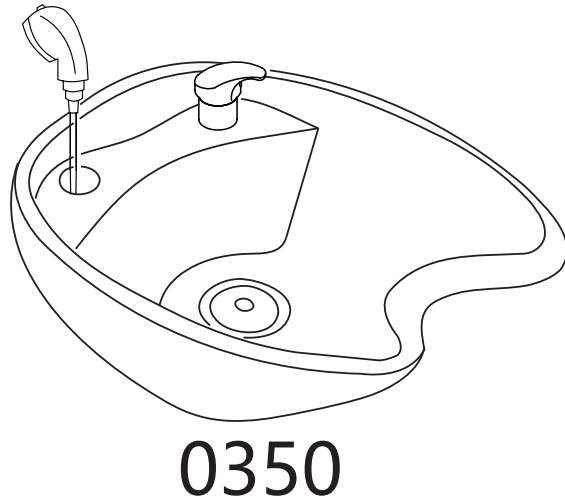

Unscrew the fastener from the sprayerhead holder.

STEP 1

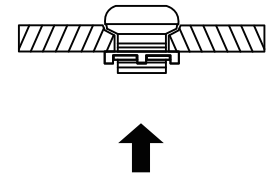
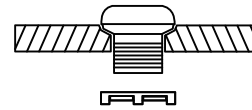

Fasten the sprayerhead holder to the sink with the plastic fastener.

STEP 2

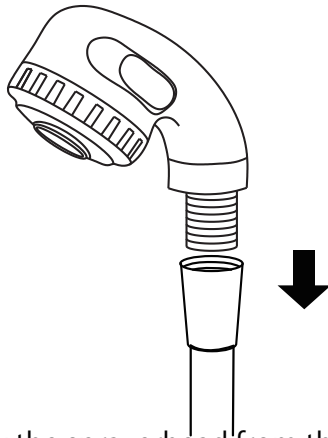

Unscrew the sprayerhead from the sprayer hose.

STEP 3

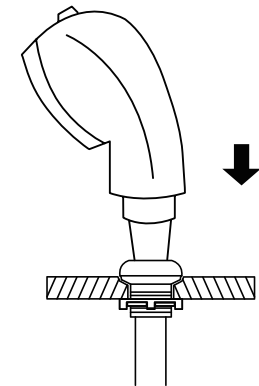
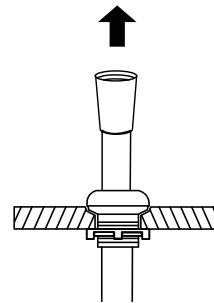

Place the sprayer hose from underneath through the sprayerhead holder and fasten the sprayerhead to the sprayer hose.

STEP 4

Sprayer Set Up Vacuum Breaker Sink

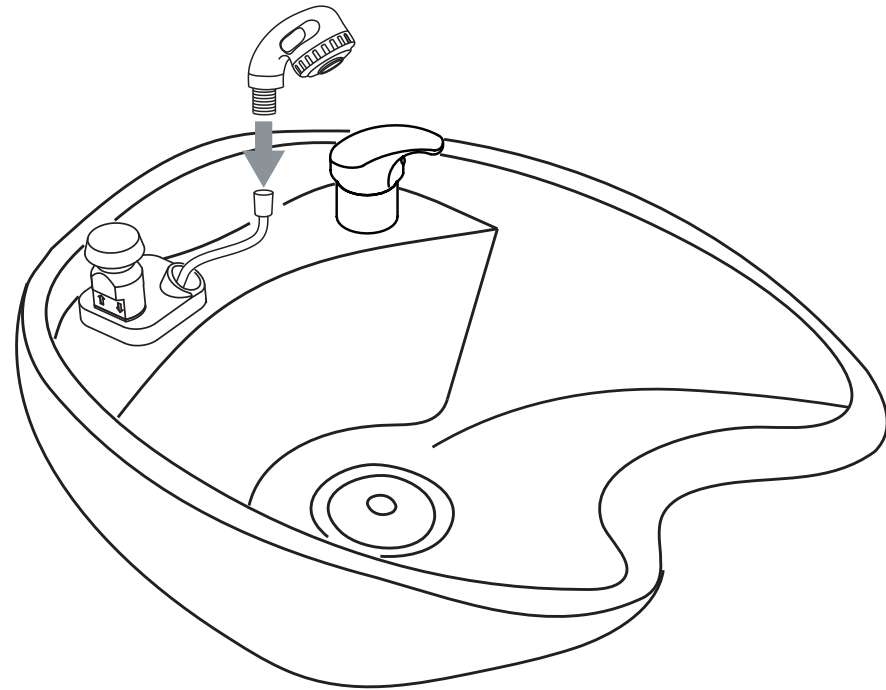

0388

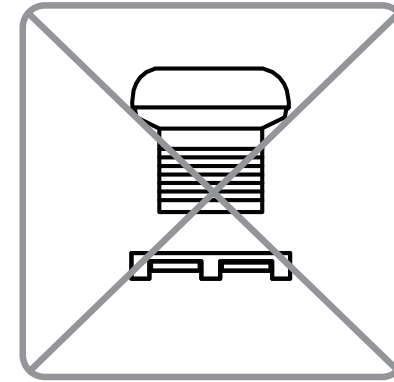

no need

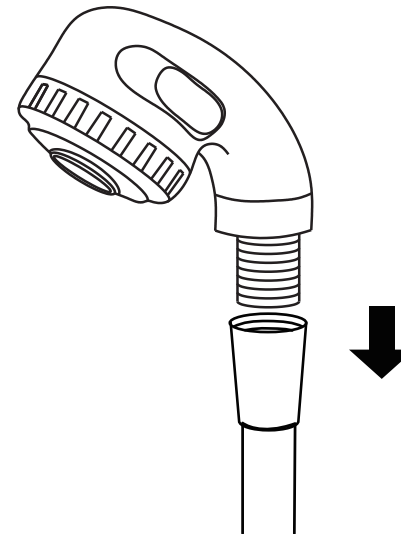

Unscrew the sprayerhead from the sprayer hose.

None Vacuum Breaker Sink

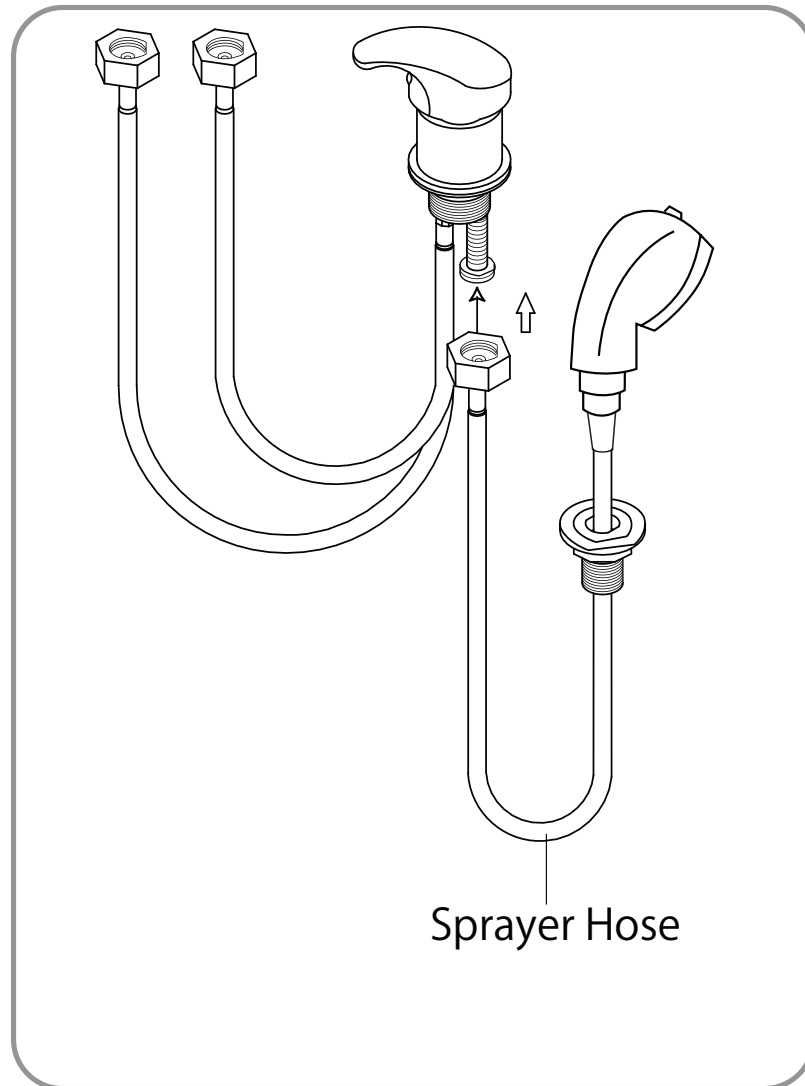

or

Vacuum Breaker Sink

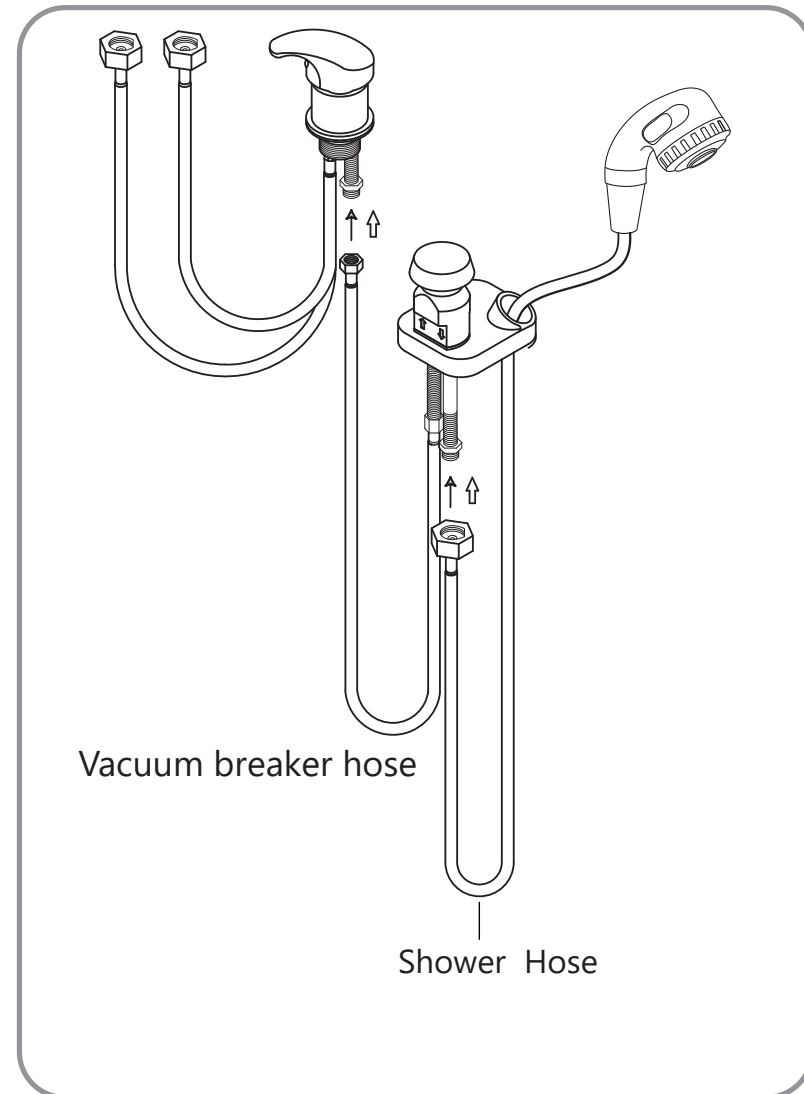

Plumbing setup:

*removable back panel to route both water supply lines and make all connections.

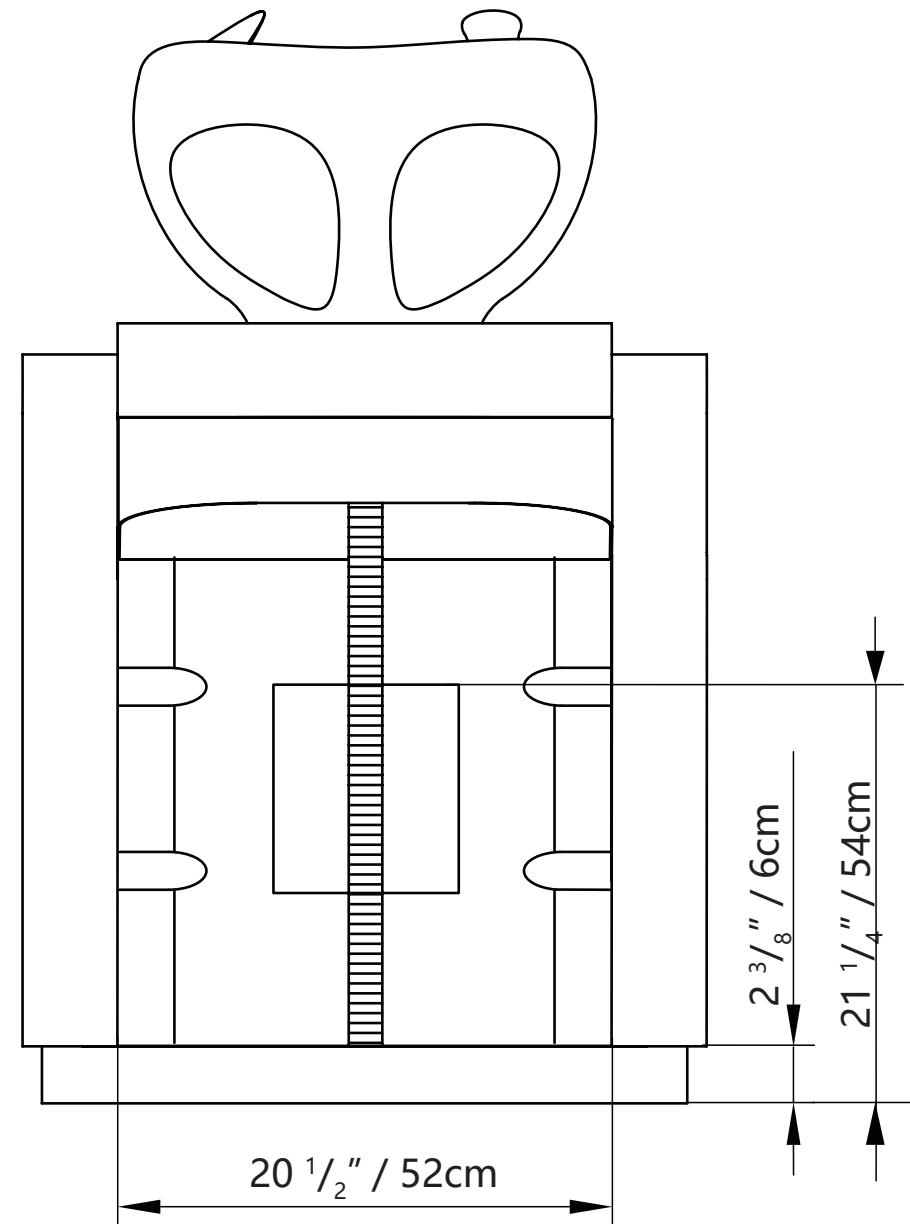
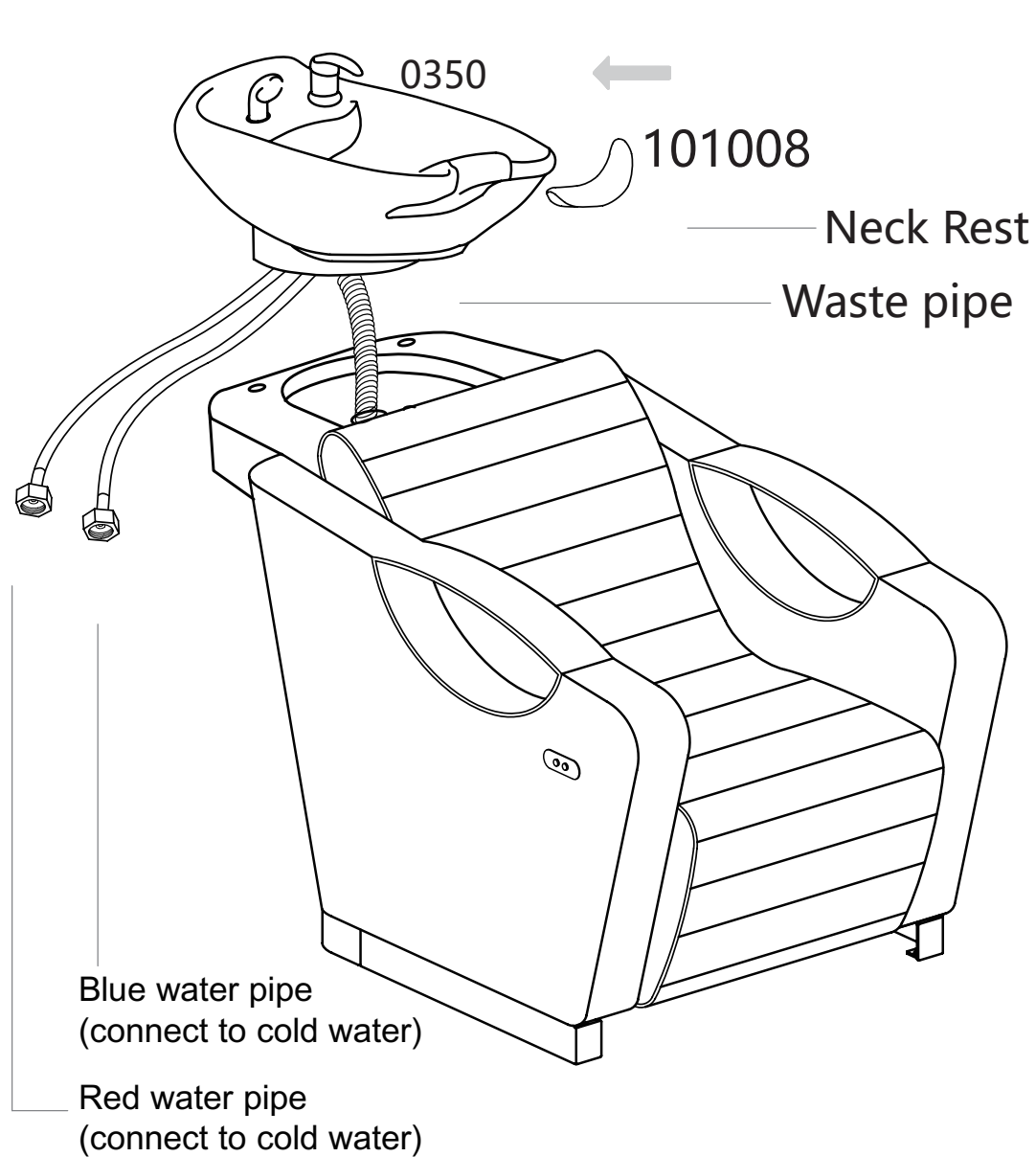

Floor plumbing setup:
Circle opening on removable back for drain pipe exit

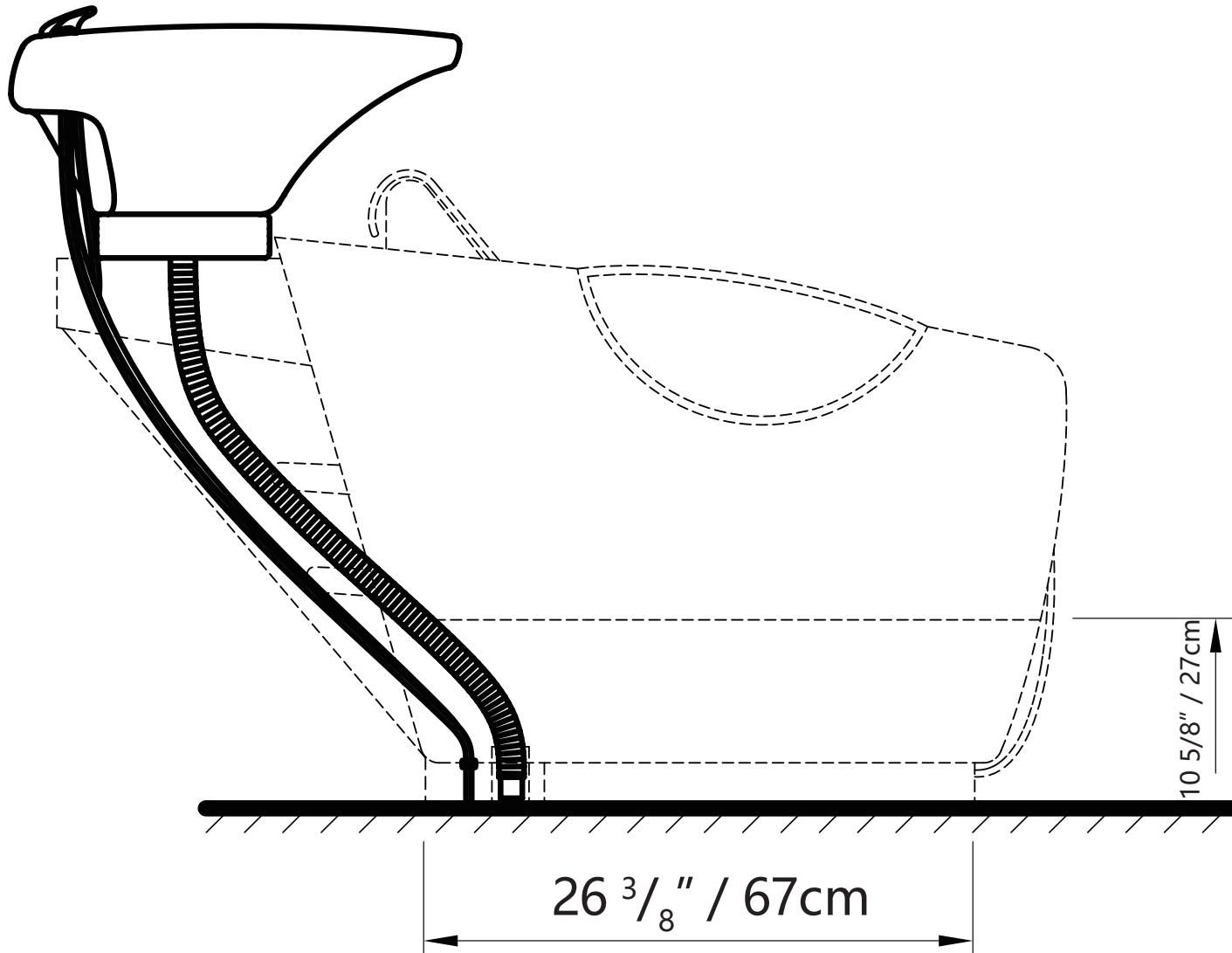

Wall plumbing setup:

All connection pipes are enclosed within the base unit.

Water supply lines are routed into the unit via circle opening on the back of the base.

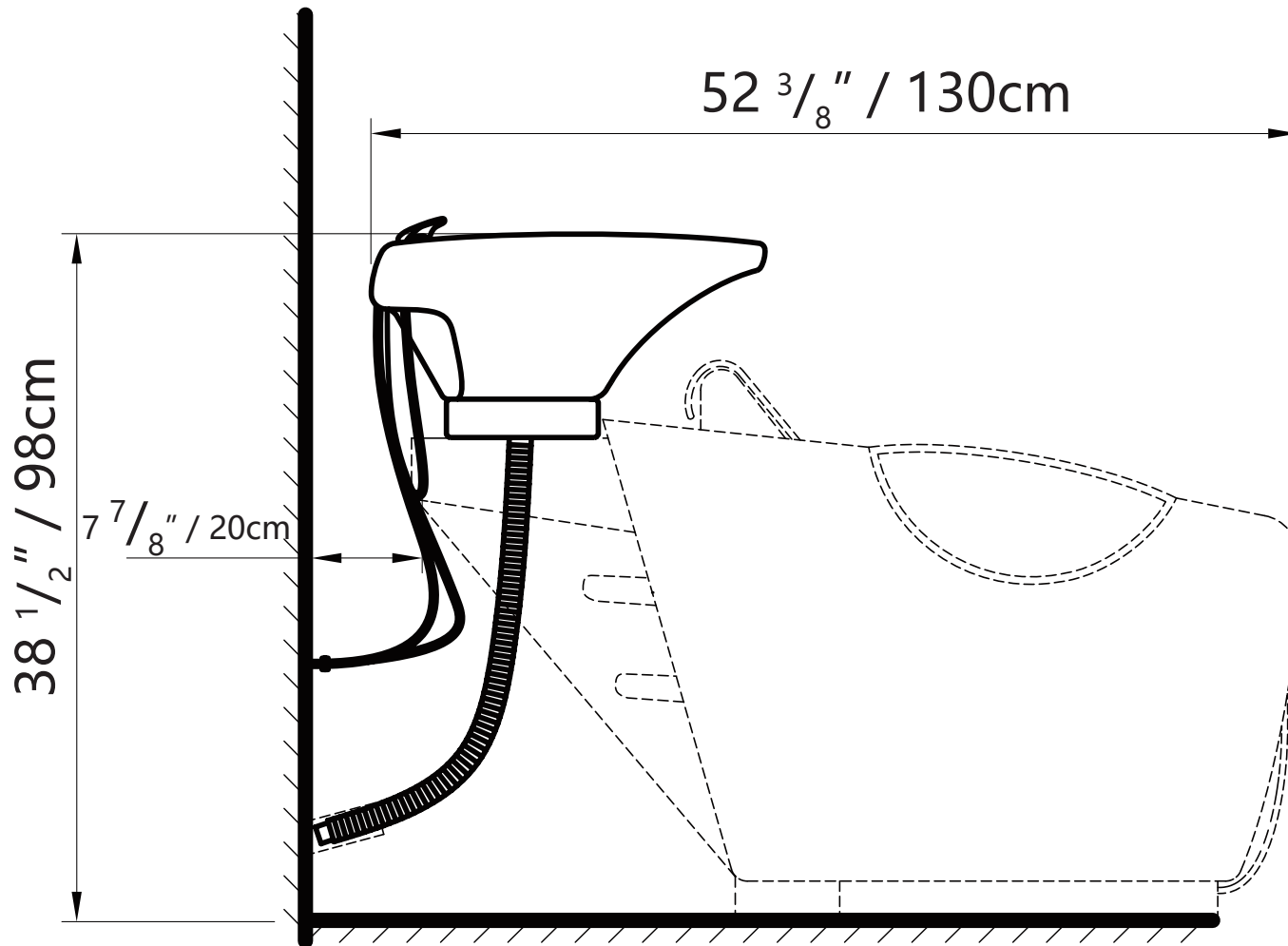

Please leave minimum $7 \frac{7}{8}" / 20\text{cm}$ of space measuring from finished wall to the back of the sink to allow sinks tilting position.

Secure the backwash on the floor by the provided floor anchors.

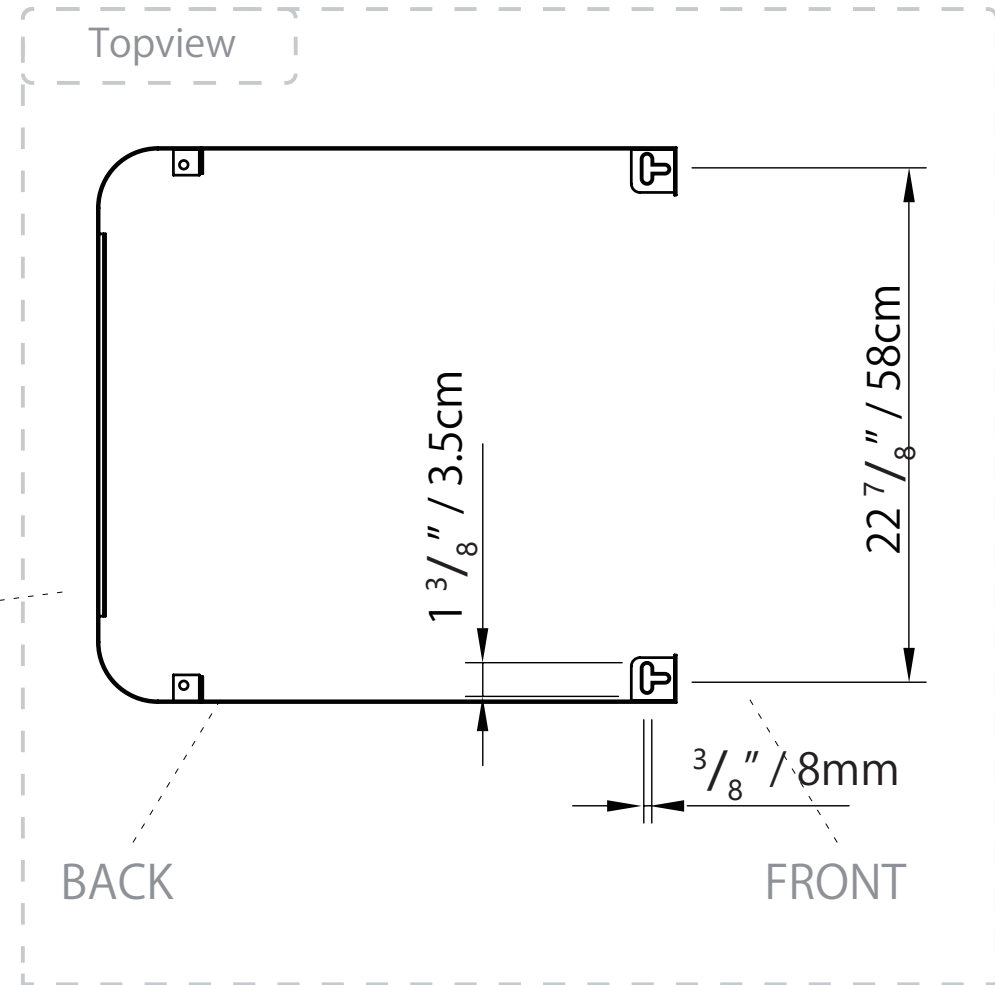
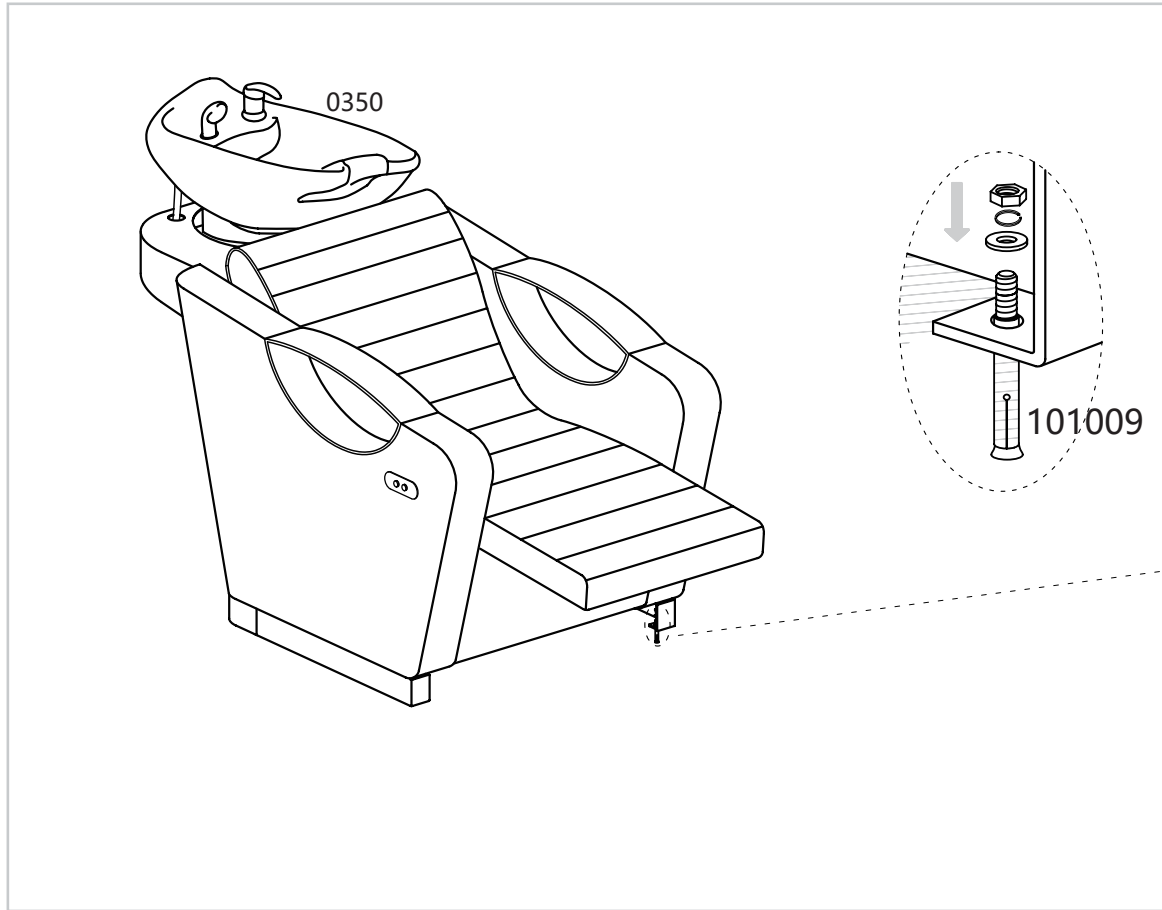

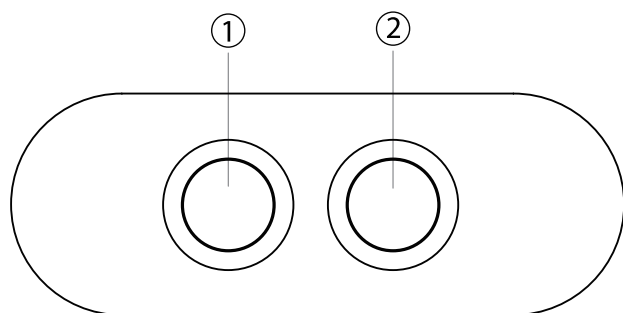

① — Press the button to raise the legrest of the Back Wash.

② — Press the button to lower the legrest of the Back Wash.

Product care

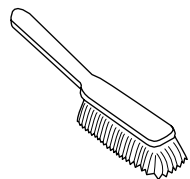

Brush away excess hair

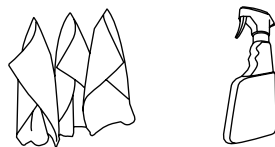

Clean surface with damp cloth or use simple soap & water solution.

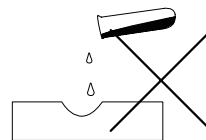

Avoid using corrosive cleaning agents such as bleaches.

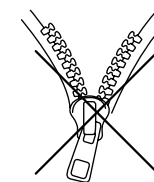

Do not remove upholstery for cleaning

Warranty

The warranty period is one year. DIR warrants to you, the original buyer, that goods shall be free of defects in material and/or workmanship attributable to manufacture for one year from date of receipt of product. Damage resulting from improper handling after merchandise is received, or from exposure to weather or extreme atmospheric conditions is not covered by the warranty. For any other information please contact our support team:

DIR BIRMINGHAM

66 Rea Street South
Birmingham
B5 6LB
UK

Tel:
+44(0)121 6434777

Email:
dirlsalon@gmail.com

DIR LONDON

Unit 1 River Road
Business Park
33 River Road, Barking
Greater London
IG11 0DA
UK

Tel:
+44(0)20 8591 9310

Email:
dirlsalon@gmail.com

DIR NEW YORK

575 Underhill Blvd.
Suite 170
Syosset, NY 11791
USA

Tel:
+1 (718)628-6668
+1 (800)728-2008

Email:
sales@dirlsalonfurniture.com

DIR IRELAND

Unit 20, Goldenbridge Ind.
Estate Tyrconnell Road
Inchicore
Dublin 8
Republic of Ireland

Phone:
+353 (1) 429 7969

Email:
sales.ireland@dirgroup.ie