

# DIR<sup>®</sup>

## ION Wall Mounted

S06WM / S06W  
INSTRUCTION MANUAL

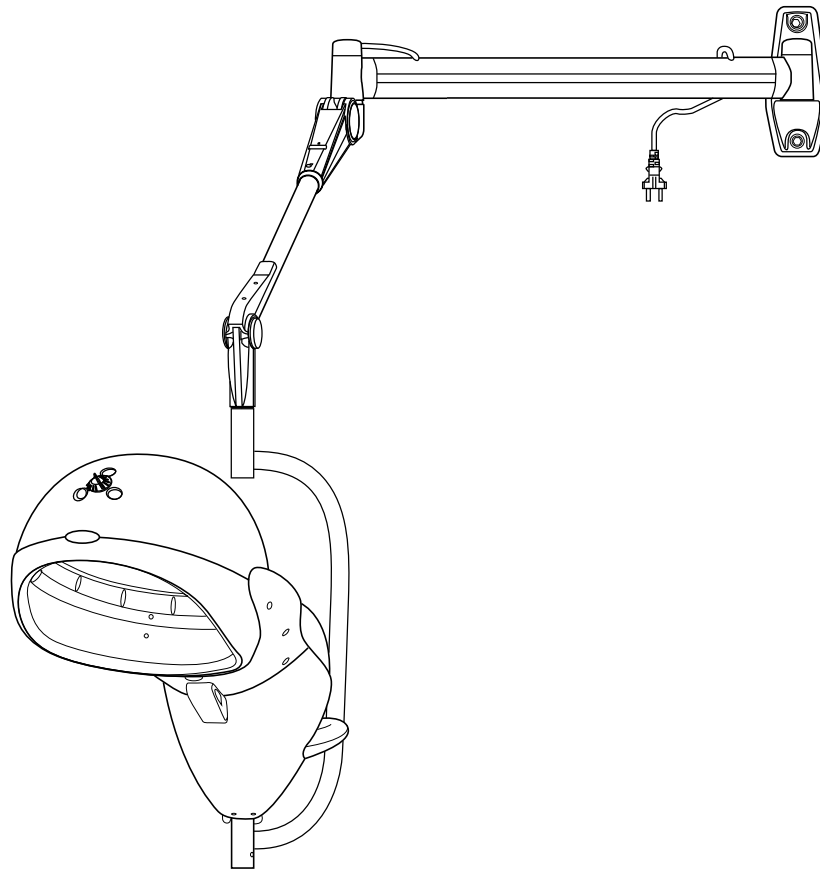

# 1 PRE-INSTALLATION

**1-1 OBSERVE THE CARTON OUTSIDE** Please check whether the weight capacity of the carton is in accordance with the net weight nominal of the head assembly, if the nominal is in accordance with the weight capacity, then you can enter into the next installation.

**1-2 SPARE PARTS** (Please see the below pictures) Open the carton. Check the arm assembly and see whether it is damaged. The spare parts are complete or not, please see the below pictures. (Remark: The wall plate and wall bracket are attached together with bolts before the factory delivers the machine.)

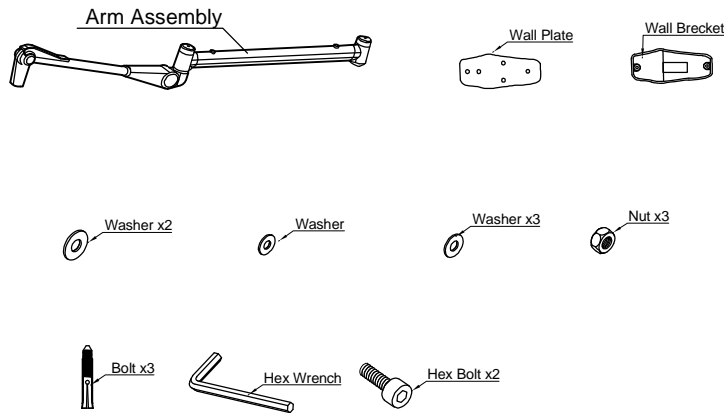

# 2 INSTALLATION OF WALL BRACKET

## 2-1. Installation of Wall Mount Arm Before Installation

### 1. Wall

The wall must be strong enough to support the arm assembly.

### 2. Height

The recommended height of the wall bracket is 72.5/77 inches from the floor to the bottom of the bracket (see diagram).

### 3. Electric Source

An electrical power outlet must be prepared on the wall within 48 inches distance from the wall bracket.

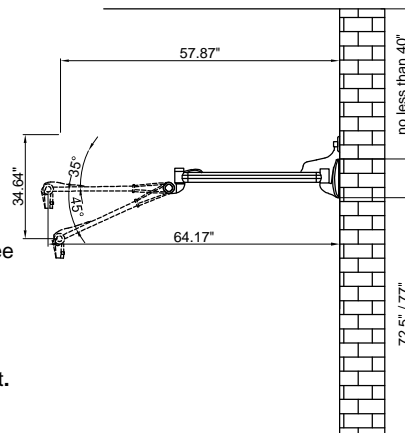

2-2. The wall plate and wall bracket are already attached together with bolts upon delivery. (See diagram)



2-4. Use the wall plate as a template and drill three holes on the wall (please refer to diagram for the correct drill positioning). The size and depth of the holes will be in accordance with the bolts supplied.

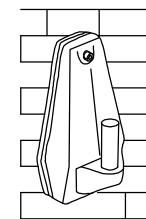
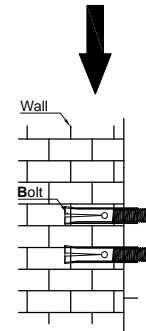
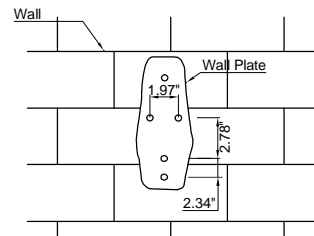

Caution! As the wall plate and wall bracket are subject to a large load, please make sure that the wall plate is installed correctly and securely. Do not remove stopper on arm until the machine head is correctly installed. The arm assembly is spring loaded and could cause damage to equipment and customers if not handled correctly.

2-3. With the supplied spanner, loosen the bolts and remove the wall plate

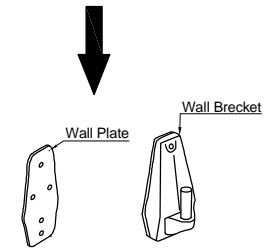
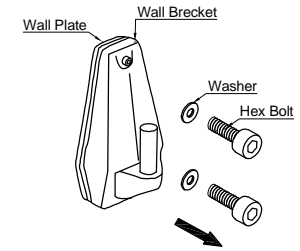

2-5. Attach the wall bracket to the wall with the bolts, and then fix with the supplied washers.

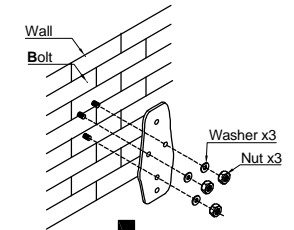

2-6 Attach the wall bracket to the wall plate, and then tighten with bolts.

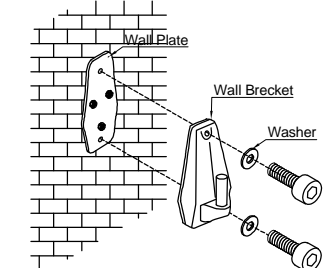

### 3 INSTALLATION OF MACHINE HEAD

**CAUTION:DO NOT REMOVE STOPPER on Arm until machine head is completely installed. Arm assembly is spring loaded and could cause equipment damage and / or injury if not handled in proper manner.**

**For both the arm assembly and the machine head are fairly heavy, it is suggested that the installation is done by two persons together as instructed in the following steps.**

3-1 Remove the screw at the protector plate underside and rotate the protector plate anti-clockwise till it is vertical. Remove the hook lock after loosening the screw.

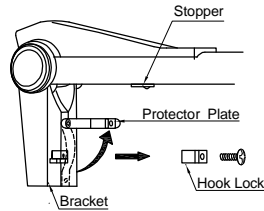

**3-2 Stand the machine head on the floor and keep it upright with two hands. Another person holds up the arm assembly and then inserts the tip of the arm into the machine head contact post.**

Note one: Please make sure to insert the machine head contact post firmly. The tip of the arm assembly must be vertical adown. You may also turn the tip of the arm assembly left or right slightly and press the tip of the arm assembly slightly.

Note two: The tip of the arm assembly must be in osculated completely with the head contact post. Please pay more attention to the groove of the bracket, if you can see the groove of the machine head contact post through the groove of the bracket, it shows the installation position is correct.

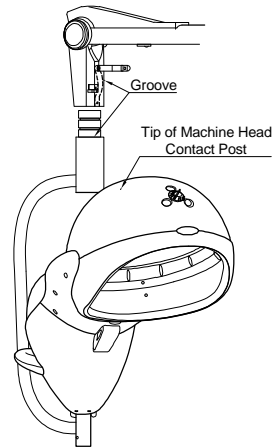

3-3 Reinstall back the hook lock to the groove and then tighten the screw firmly.

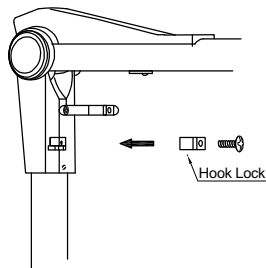

3-4 Turn the protector plate clockwise back to the original position and then tighten the screw firmly.

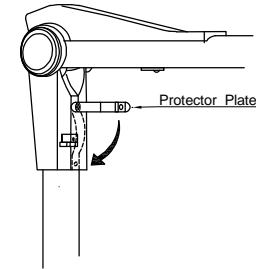

3-5 Two persons hold up the machine head and the arm assembly at the same time, then install on the wall.

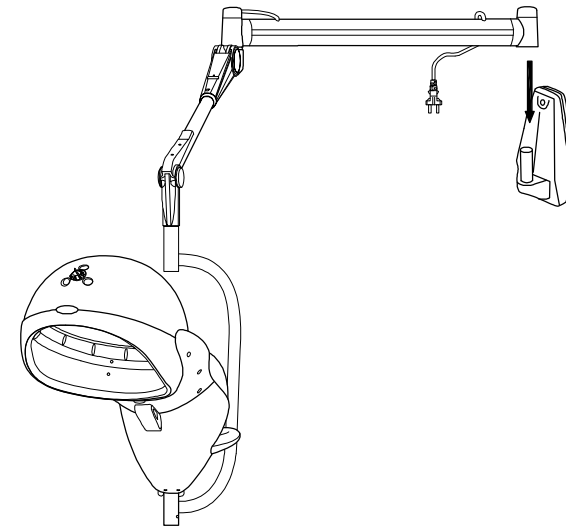

3-6 Remove the stopper, otherwise it will damage the arm assembly!

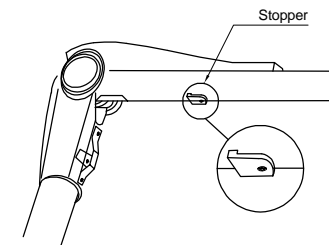

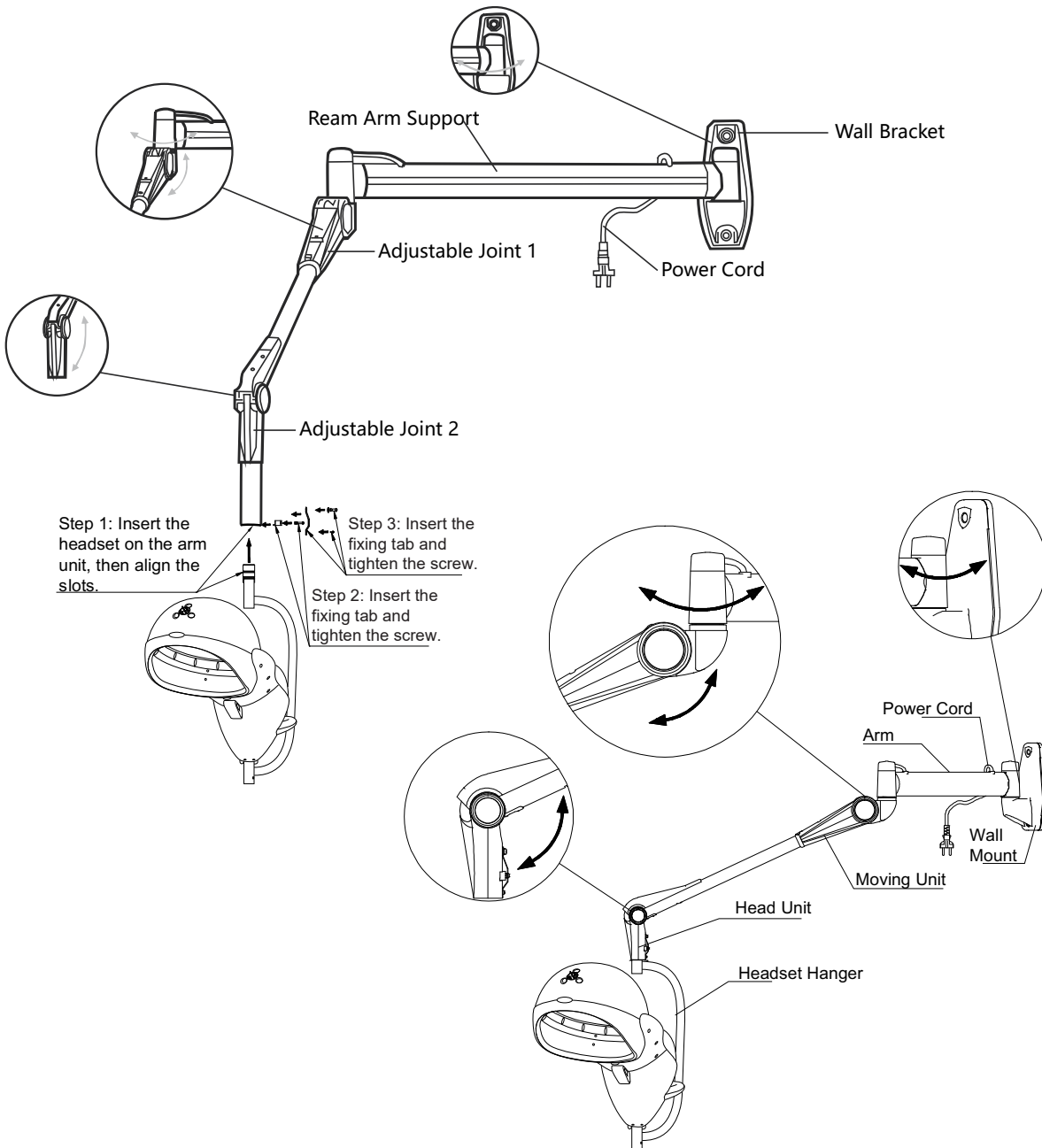

## Adjustment of Arm Assembly

1 After finishing the installation, hold the machine body with two hands and move up and down to adjust the height position as you require. Please operate with care avoiding ceilings, furniture etc. In order to protect the arms, it is suggested not to remove the cover off the arms and not to rotate the adjusting bolt.

2 Before the manufacturer delivers the product the strength of the arm spring has been adjusted. Please load the correct weight as shown on the arm assembly.

## CARE INSTRUCTIONS

1. The inner cap can get dirty easily, please clean regularly. Chemicals such as hair dyes can cause dysfunction.
2. Wipe clean with a soft, dry cloth when cleaning. If water splashes on the panel, immediately wipe it off with a dry cloth, otherwise the machine will malfunction.

# Control Panel

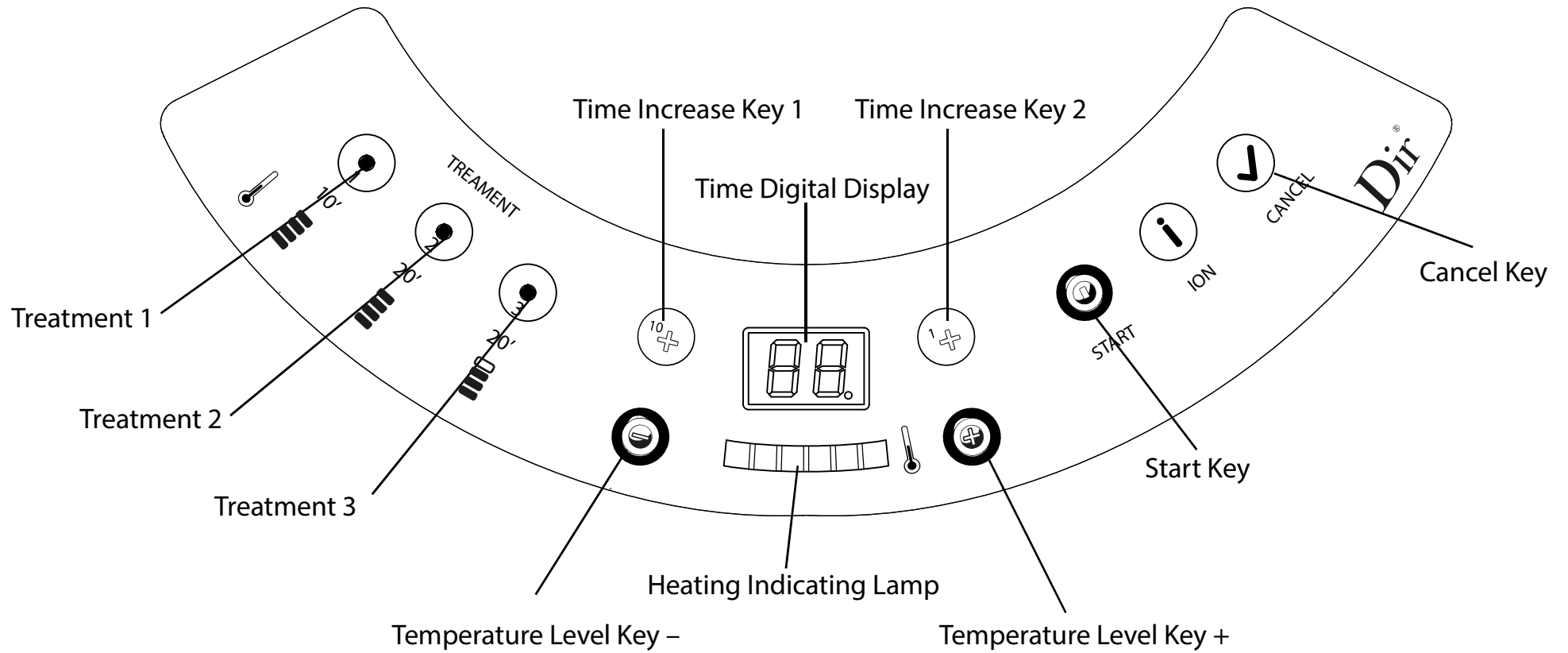

#### Treatment 1

Press this key to choose Treatment 1 Programme; the preset working time is 10 minutes and the temperature level 4.

#### Treatment 2

Press this key to choose Treatment 2 Programme; the preset working time is 20 minutes and the temperature level is 4.

#### Treatment 3

Press this key to choose Treatment 3 Programme; the preset working time is 20 minutes and the temperature is level 3

#### Time Digital Display

Displays the working time under minutes, the longest cycle can be up to 60 minutes.

#### Time Increase Key 1

By pressing the button once, the treatment will increase by ten minutes; therefore if you treatment is for 60 minutes, key button 6 times.

#### Time Increase Key 2

By pressing the button once the treatment will increase by one minute.

#### Temperature Level Key –

This key is used to decrease the temperature by one level

#### Temperature Level Key +

This key is used to increase the temperature by one level

#### Start Key

Press this key to start work for each program.

#### Ion On/Off Key

By pressing this key the indicating lamp lights will light up; start the Ion function. By pressing this key again the lamp will turn off; close the Ion function.

#### Cancel Key

This key is used to change or reset a program.

#### Heating Indicating Lamp

When the lamp lights up, it shows the machine is at the heating level required.

## Operation Instruction

**Important:** Before using please make sure that the service voltage is the same as the product rating voltage.

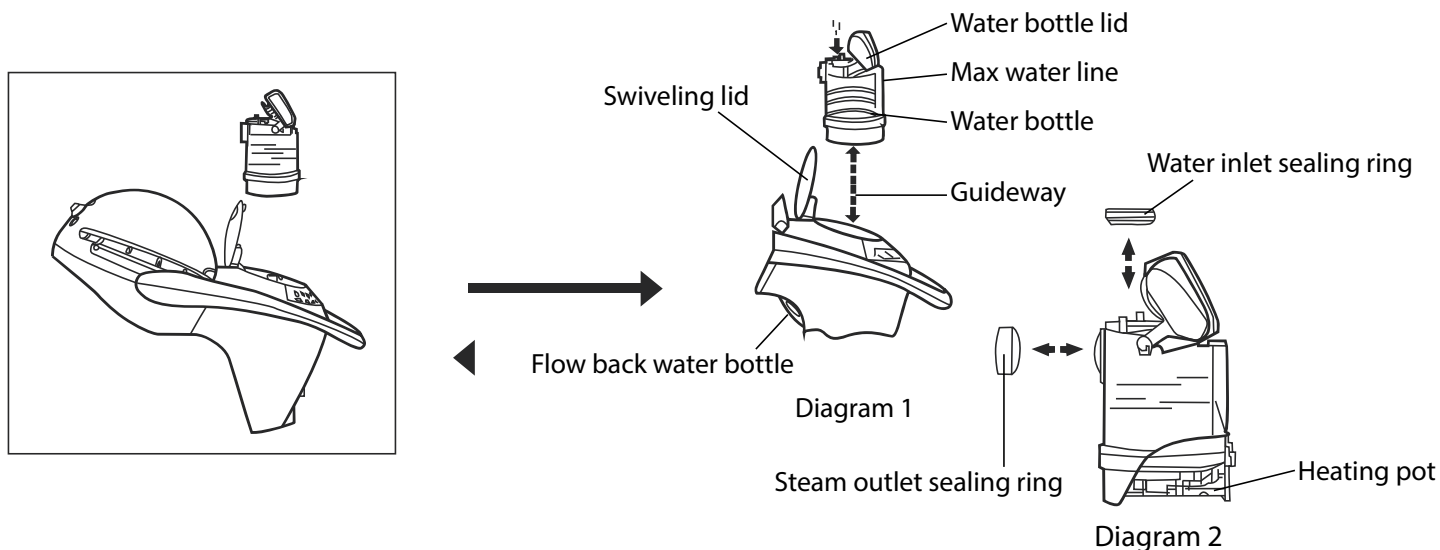

### Add Water ( see diagrams)

- Open the machines Swivelling Lid and take out the Flow Back Water Bottle.
- Add distilled water or similar pure water to the Water Bottle.  
Please note the water level must not be higher than the Max Water Line.
- After adding water, please make sure that the Sealing Rings are placed in the appropriate position, then you can close the Water Bottle Lid.
- Along the Guideway, insert the Water Bottle into the machine. (see diagrams)

## Operation Instructions

1. Position the machine comfortably above the forehead/nape of the neck; so that the steam completely covers the customer's hair.
2. Ensure that the customer's face and eyes are outside of the steam dome.
3. After you turn on the power switch, the ozone key and the level 4 temperature lamp will light. Time on the control panel will show as "0"
4. If the machine senses that the water bottle is empty the alarm will sound, please then add water to the tank.
5. Choose the treatment required according to the customer's need, altogether the product has 3 programmes.
6. To adjust the time and temperature:  
Time Increase Key 1 - digital display increases by 10 minutes  
Time Increase Key 2 - digital display increases by 1 minute.  
To adjust the working temperature, use the temperature adjustment + or - keys.
7. During operation, the time on the digital display will show the remaining time, the time decimal point blinks at the frequency of once per second.  
During operation if you lift the swivelling lid, the machine will stop heating. Only after you close the lid will the machine continue to heat up.  
When the time remaining is 3 minutes the control panel will light up.
8. To change the working programme during operation you must first press the Cancel key. When the machine cycle comes to a stop please select the programme required.
9. After finishing the programme the Time Digital display shows as "0" the alarm will also sound.
10. Once you have finished all treatments, please empty the water in the Flow Back Water Bottle.
11. After finishing operation please turn off the power source and remove the power cord.
12. This machine does not have memory function; therefore once you have turned off the machine any previous cycles will be lost.

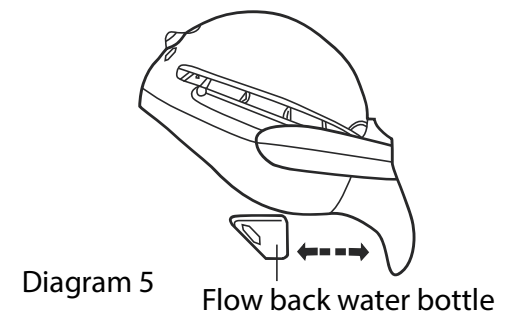
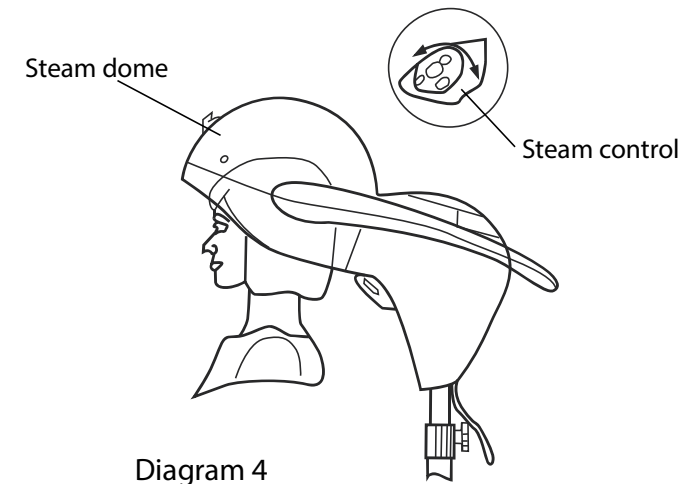
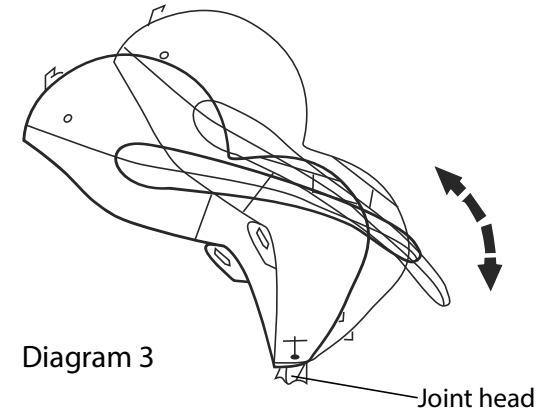



# Maintainance

Before cleaning please remove the power cord

1. The inside of the machine helmet is easy to stain and get dirty, please clean this regularly. Chemicals such as hair dye etc can cause the machine to dysfunction.
2. Use a soft, dry cloth to wipe and clean. If water/liquids splash onto the control panel, use a soft dry cloth to remove immediately, otherwise this could also cause the machine to dysfunction.

**Attention !:** Please do not use the following substances to clean: thinner, alcohol, gas, coal, oil or any other harmful chemicals

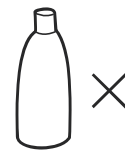
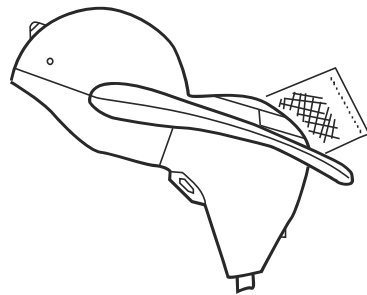

Thinner or Benzine



Neutral detergent

# Cautions

1. Before using please make sure that the service voltage is the same as the products appropriate rating.
2. Operating environment; an ambient temperature of 5'c -40'c; a relative humidity of less than 95%.
3. To ensure users safety, never insert foreign objects into the machine.
4. Be sure never to use flammable gas or use machine under similar environments.
5. After switching on the power; if you find any abnormal conditions, please contact the technical department immediately – do not attempt to repair yourself.
6. Don't remove the plug by pulling the cable. Please first hold the plug then pull.
7. This machine is strictly prohibited to use outdoors/outside.
8. If the cable is found to be damaged, in order to avoid danger, it should be replaced by the manufacturer.
9. Water must be purified. Don't add or use any cosmetic liquids, astringent, toning lotion, perfume, carbonated water or mineral water (un-pure tap water), otherwise that will induce the machines function and/or create a hyper susceptibility to customers skin.
10. Please keep children away from the machine when in use,
11. If you suffer from any medical condition, please consult your local GP before use.

## Product care



Brush away excess hair

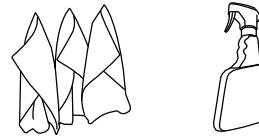

Clean surface with damp cloth or use simple soap & water solution.

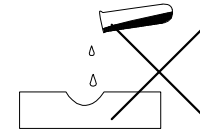

Avoid using corrosive cleaning agents such as bleaches.

## Warranty

The warranty period is one year. DIR warrants to you, the original buyer, that goods shall be free of defects in material and/or workmanship attributable to manufacture for one year from date of receipt of product. Damage resulting from improper handling after merchandise is received, or from exposure to weather or extreme atmospheric conditions is not covered by the warranty. For any other information please contact our support team:

### DIR BIRMINGHAM

66 Rea Street South  
Birmingham  
B5 6LB  
UK

-----  
Tel:  
+44(0)121 6434777

-----  
Email:  
[dirsalon@gmail.com](mailto:dirsalon@gmail.com)

### DIR LONDON

Unit 1 River Road  
Business Park  
33 River Road, Barking  
Greater London  
IG11 0DA  
UK

-----  
Tel:  
+44(0)20 8591 9310

-----  
Email:  
[dirsalon@gmail.com](mailto:dirsalon@gmail.com)

### DIR NEW YORK

575 Underhill Blvd.  
Suite 170  
Syosset, NY 11791  
USA

-----  
Tel:  
+1 (718)628-6668  
+1 (800)728-2008

-----  
Email:  
[sales@dirsalonfurniture.com](mailto:sales@dirsalonfurniture.com)

### DIR IRELAND

Unit 20, Goldenbridge Ind.  
Estate Tyrconnell Road  
Inchicore  
Dublin 8  
Republic of Ireland

-----  
Phone:  
+353 (1) 429 7969

-----  
Email:  
[sales.ireland@dirgroup.ie](mailto:sales.ireland@dirgroup.ie)